

Canon Pop-up Card (Wine) : Assembly Instructions

Canon® is a registered trademark of Canon Inc. © HIROKO

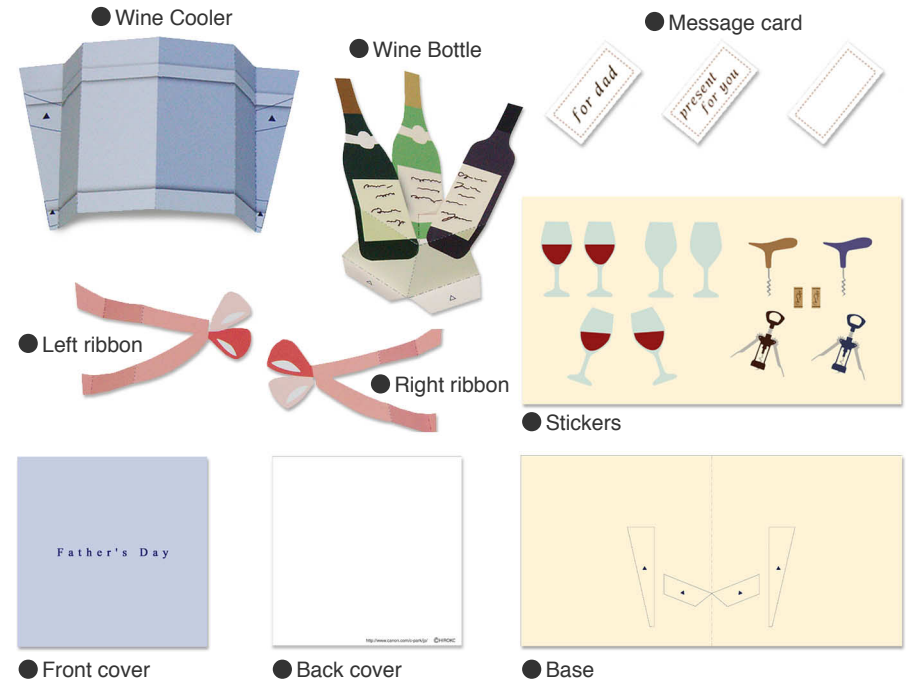

1 Cut out the parts and crease them along the fold lines indicated. □
(If you make a strong crease, the parts will open out smoothly.)



Assembly Instructions

..... Mountain fold (dotted line) *Make a mountain fold.	—— Scissors line (solid line) *Cut along the line.
- · - · - Valley fold (dashed and dotted line) *Make a valley fold.	— Cut in line (solid line) *Make a cut.
▲ Black triangle Glue here	△ White triangle Glue the back

You will need
scissors, paste, a used ballpoint pen (tracing along the fold lines makes them easier to fold)

Caution:Glue, scissors, and other tools may be dangerous to young children so be sure to keep them out of the reach of young children.

2 Match up the slits marked Left ribbon and Right ribbon.

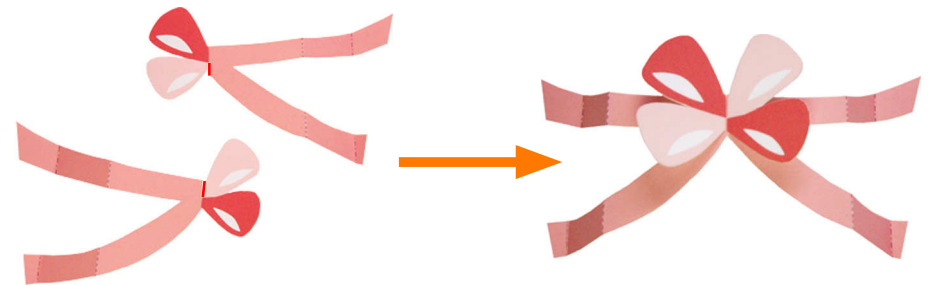

Canon Pop-up Card (Wine) : Assembly Instructions

Canon® is a registered trademark of Canon Inc. © HIROKO

3 Stick assembly 2 onto the glue spots on the wine cooler.

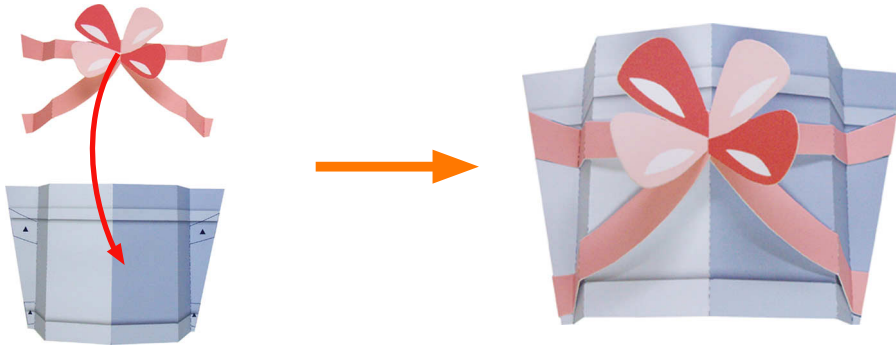

6 Stick the name card and stickers as you wish onto 5 .



4 Stick the wine bottles onto the glue spots on the base.

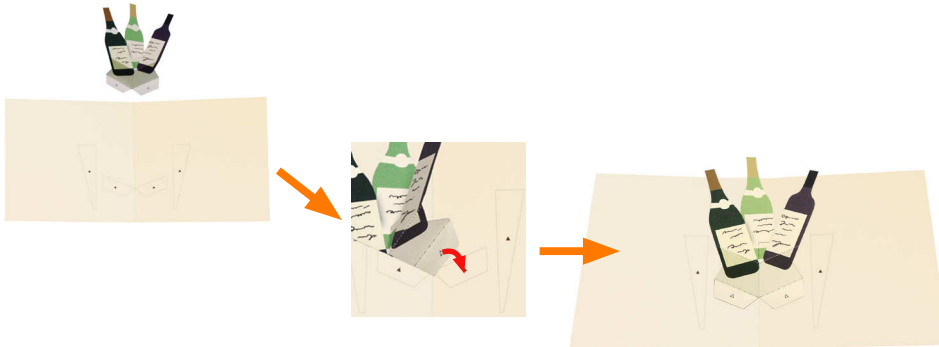

7 Paste the coloured front cover onto the back of the left hand side of the base.

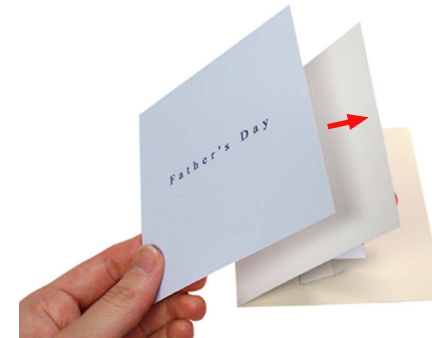

5 Stick assembly 2 onto the glue spots on 4 .

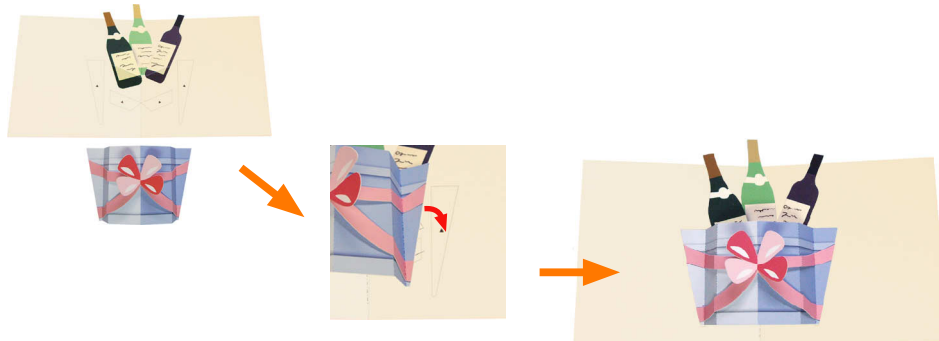

8 Finally, paste the back cover onto the back of the right hand side of the base.

