

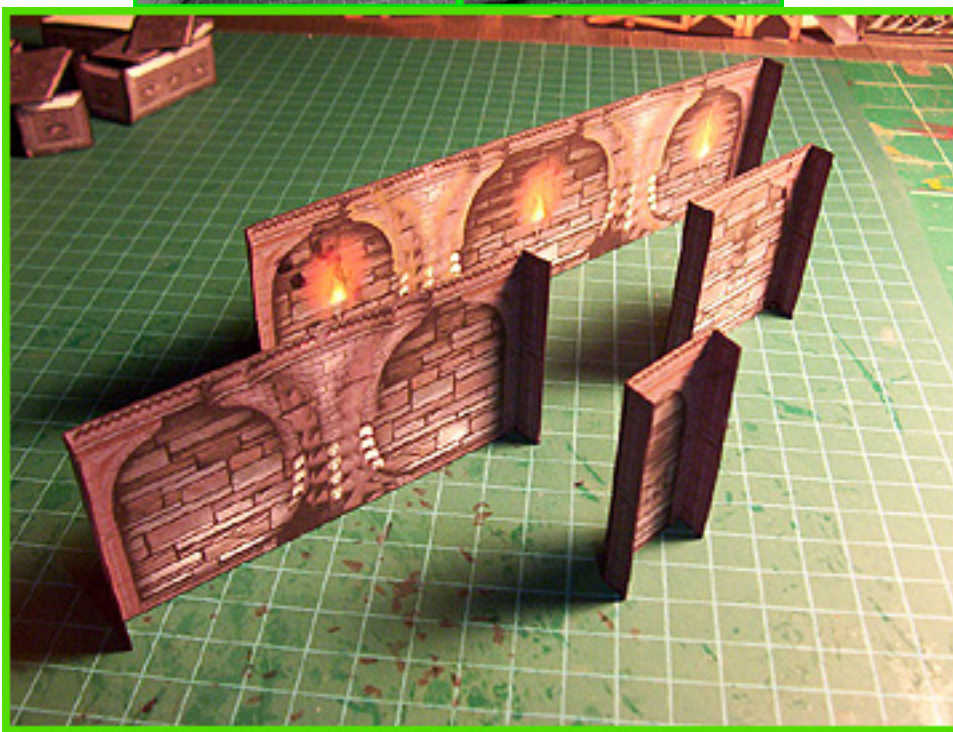

MODEL TYPE:	Clip-it WALL SECTIONS
DIFFICULTY:	1 out of 5
APPROX BUILD TIME:	Quick – 5 to 10 minutes <i>(Time may vary depending on skill level)</i>
DUPLICATIONS <i>(Suggested):</i>	The more the better!
EDGING COLOR:	Gray or Black <i>(What is “Edging”? Please refer to the included “Beginners Guide”).</i>

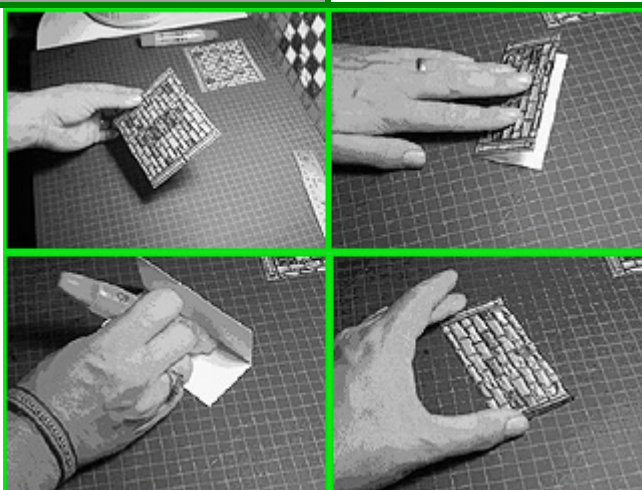

STEP 1:

Cut and score your model as noted. Fold over and glue the longest central line of each wall section (image appearing on both sides). Be sure that you apply an even but thin bead of glue to one entire side of the inside wall (reverse white side). When burnishing (applying pressure) be sure to push the glue to all corners and edges. Allow a one-minute dry time.

STEP 2:

Fold the end Clip-it tabs inward 90-degrees. You are now ready to start utilizing the Clip-it room building system! More on this in the “Bringing it all together” section.