

WORLDWORKS GAMES

ArenaWorks™

MODEL TYPE:	DOJO SHACK
DIFFICULTY:	2 out of 5
APPROX BUILD TIME:	Quick - 5 to 10 minutes <i>(Time may vary depending on skill level)</i>
DUPLICATIONS (Suggested):	1 to 2 copies (optimal)
EDGING COLOR:	Brown or Green felt <i>(What is "Edging"?) Please refer to the included "Beginners Guide".</i>

This easy building features a medieval gambrel roof. Not shown is the option to attach fences to make a training yard, just slot the triangular end of the fences into the walls, make a slit if you have to. The yard side is the one with the sword rack.



STEP 1:

Cut and score as indicated. Apply glue to the wall tabs on the building parts and join them together. Press hard, pop back into a box shape and set aside to dry. Apply glue to the small tabs on the central peak of the roof.

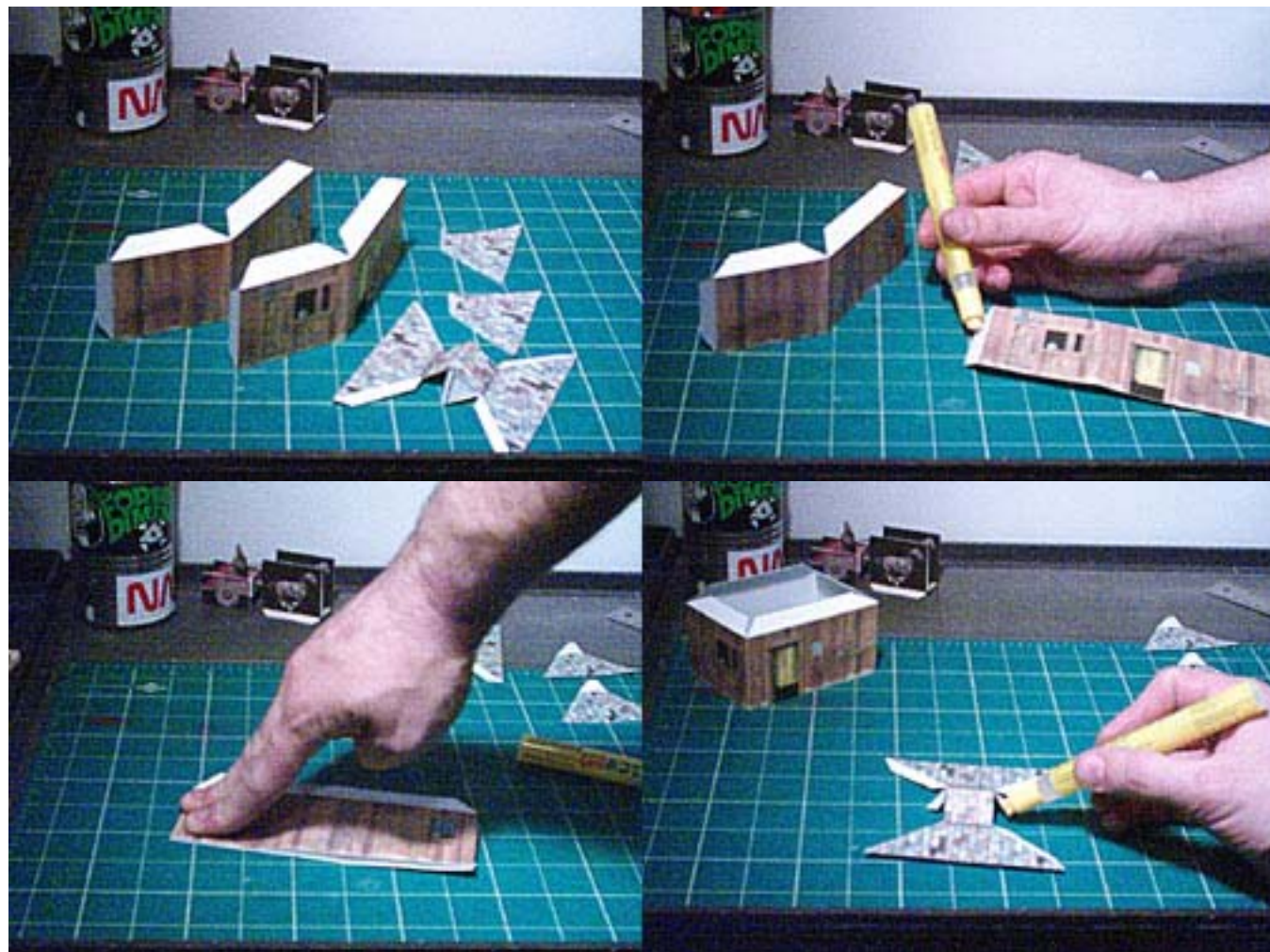

STEP 2:

Pinch the peak on the roof together. While it dries, apply glue to the tabs on the two remaining roof pieces and the four tabs on the main roof. Fit the small roof pieces in under the roof peak as shown. Gently press the top of the drying roof to keep it flat. Glue the tabs of the building walls and set the roof atop it.

