



WWW.WORLDWORKSGAMES.COM

# CASTLEWORKS ULTIMATE™



## CASTLE WALLS



complexity

CASTLE WALLS



completion time

The straight castle walls come in a variety of shapes and sizes. These multi-purpose wall sections can be stacked on top of one another to create variable wall height. These walls also feature a unique slotting system that allows you to swap crenelations and hoardings on the fly (No glue necessary). Beyond the varying sizes these walls also feature unique textures including whitewashed sections.

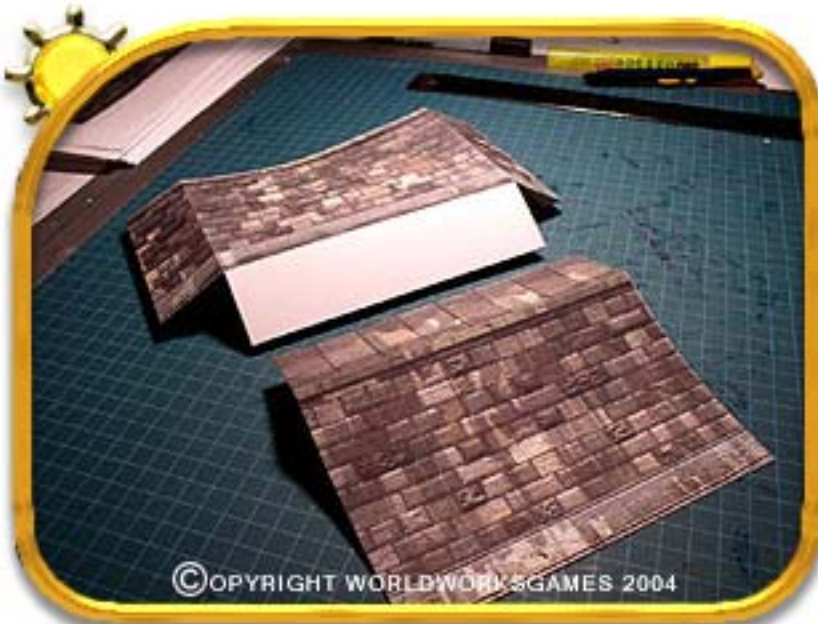

These instructions apply to all straight wall sections (column, halfwall, straightwall, stucco, ridged.)

Cut, score and fold your models as noted. Take special care to cut out the wall slots on the top of the walkway. **These slots accommodate crenelations and hoardings.**

Glue the two wall sections together as shown.



Take note of the gluing position. Glue tabs are always positioned with a hard, flat, even surface beneath them. This ensures even glue distribution and a secure bond.

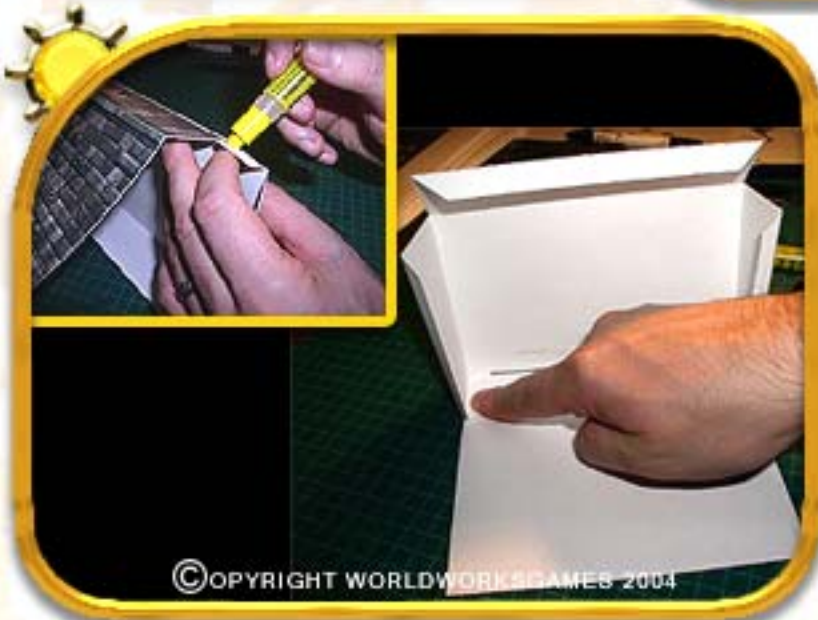

Apply glue to the small side tab as shown. Secure in place where noted making sure the wall is flush with the walkway.

Repeat this step on the opposite tab as well.



Apply a bead of glue along the long vertical glue tab.

Flip the model over and apply pressure to the tab. Be sure the wall is flush.

Repeat this step on the opposite remaining vertical tab.

Apply a liberal amount of glue to the final bottom tab.



Insert the tab and apply pressure along its length. Make sure the bottom is flush. Hold in place until dry.





### 1-INCH USERS:

You may wish to apply the "1-inch wall top" at this stage.

Take a few seconds and "Edge" your models with a dark felt. The end result is worth the extra minimal effort!



What is "Edging"? Please refer to the included Beginners Guide for step-by-step instruction.

### 1.5-INCH USERS:

Mount your wall base located in the "Basing", "1.5-inch" folder. Choose either a PaperlinX or Classic Masterboard base.

### 1-INCH USERS:

Mount your wall base located in the "Basing", "1-inch" folder. Choose either a PaperlinX or Classic Masterboard base



Glue the wall section to your chosen base format. Make sure there is little or no overhang around the base and sides of the model.

For double high walls simple glue one on top of the other prior to basing.

