



WWW.WORLDWORKSGAMES.COM

CASTLEWORKS ULTIMATE™



INTERIOR STAIRCASE



INTERIOR
STAIRCASE



The interior staircase sections are very quick builds and add a needed strategic playability inside multileveled structures.



Cut, score and fold the stair section as noted. Slowly bend each stair until the section folds over as shown.

Apply an even coat of glue to the first step insert.



Apply the step insert under the first stair section. Use your ruler as a supporting back to apply pressure to the stair section.





Continue this process until all four steps are in place.

Glue the top tab and apply underneath the top step.



Glue the base step tab and apply as shown.

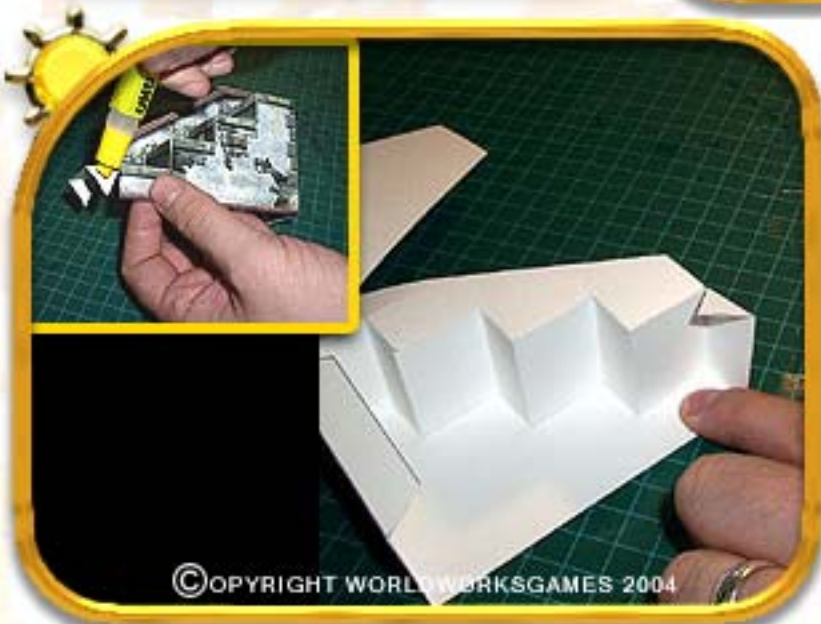

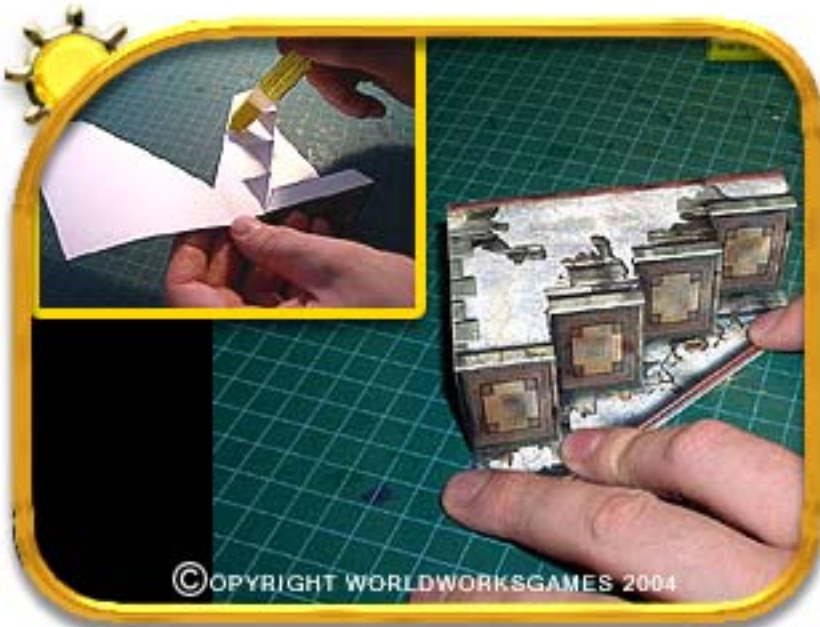

Apply a thin coat of glue to the backside of the stair guard rail as shown.

Flip the model over and apply pressure to the rail making sure to force glue to all edges and corners.

Glue the remaining long vertical tab in place as shown.



Glue the final base stair tab in place as shown.

All done!