

Model:	<b>Curved Walls</b>
Difficulty:	<b>Moderate</b>
Build Time:	<b>10 mins</b>
Duplications:	<b>6 to 8 or more</b>

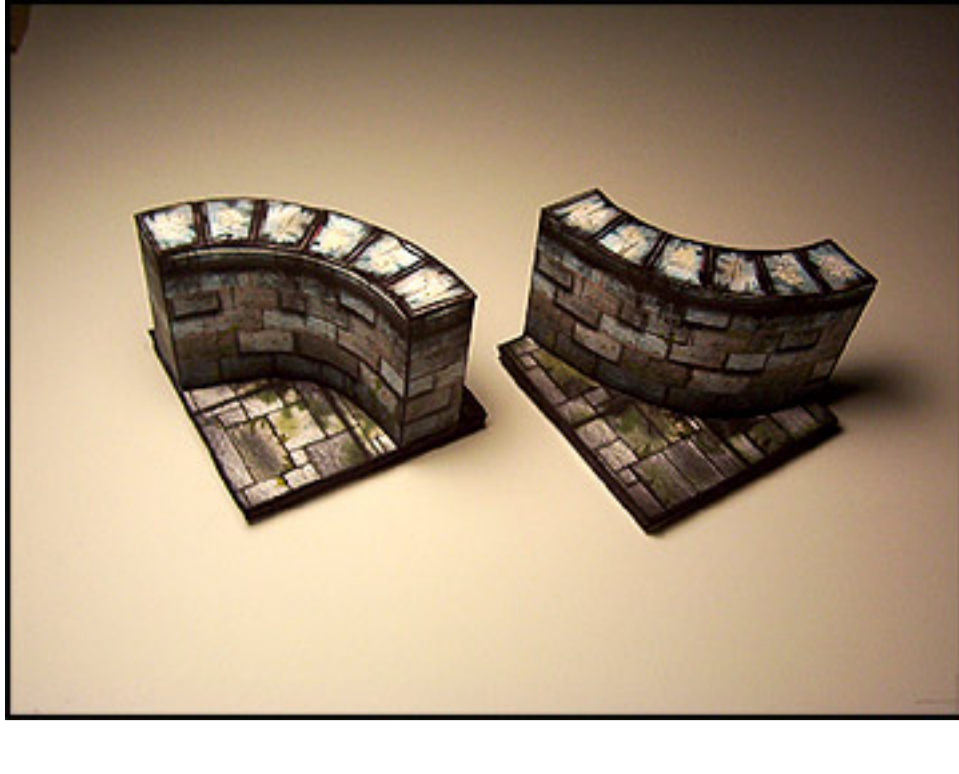

**Pirating KILLS** small businesses like this one. If you enjoy WorldWorks Products and you want us to continue please support us by **NOT** sharing these files. **Please help keep us alive!**

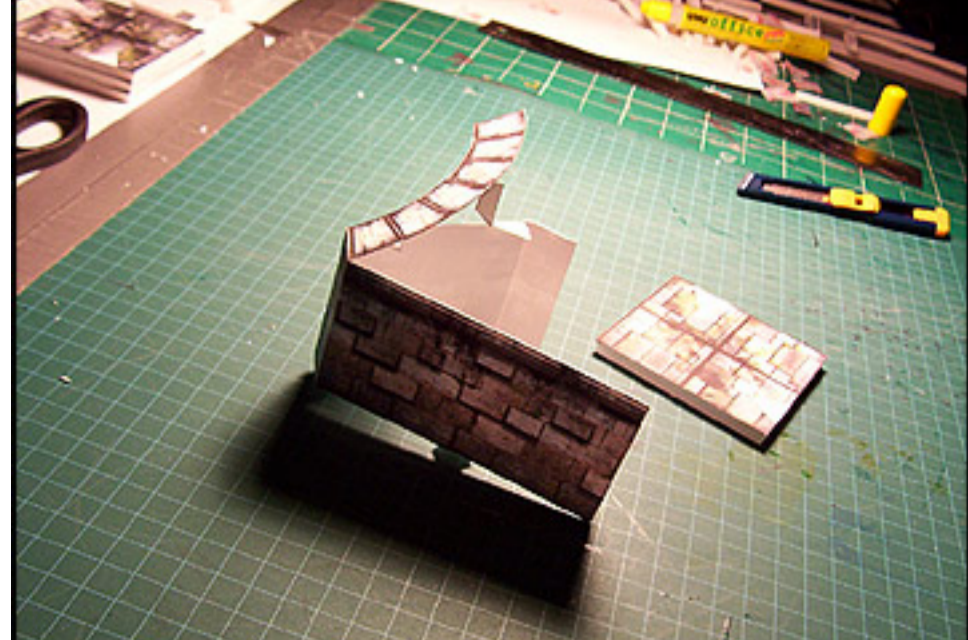

Cut, score and fold as noted paying careful attention to areas marked with "Reverse side score" arrows.

**Mount your base on a piece of foamcore. (Please see the "Pro Masterboard" section for complete instructions on mounting your base). It is vital that you complete this step now not later!**

Begin by gluing the end wall tab to the inside of the opposing wall (See photo). The outer wall section will bend inwards slightly as you do this...don't panic, this is an essential part of the process ;)

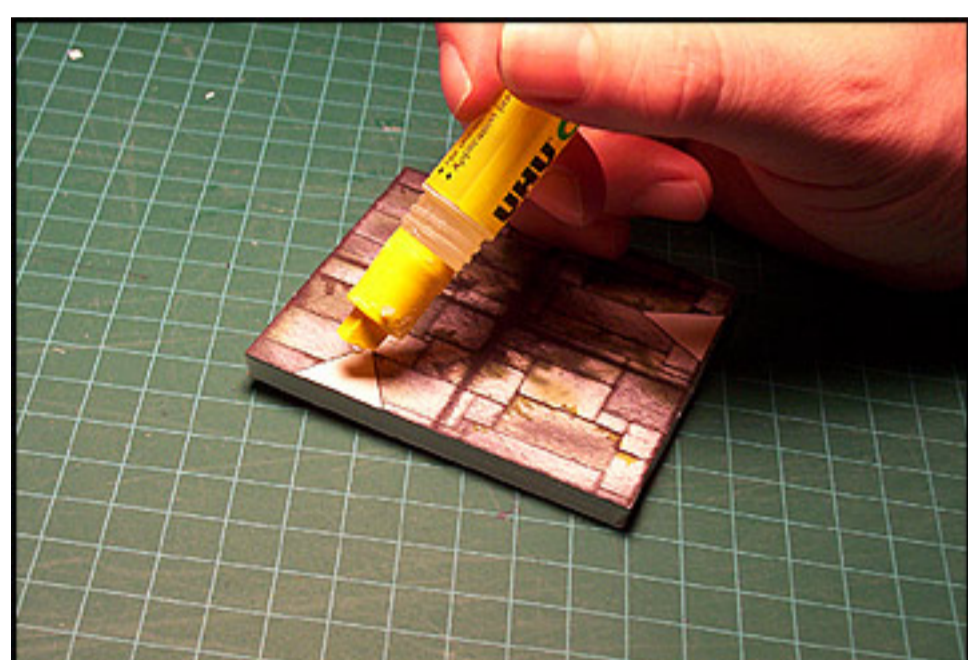

Apply a small bead of glue to one of the white triangular glue areas on your base.

Take one end of the bottom wall tabs and apply pressure to this triangular glue mark. Be sure that the end of the wall is not overhanging the base (keep them flush). Set aside and allow at least 3 minutes drying. It is vital you allow for a dry time as we will be putting a bending pressure on the next section.

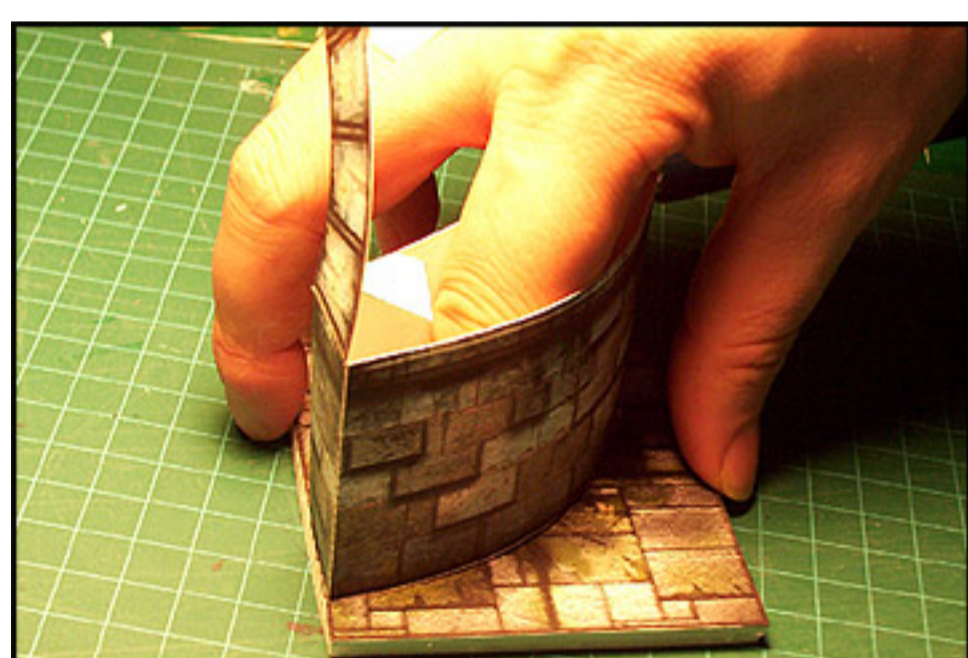
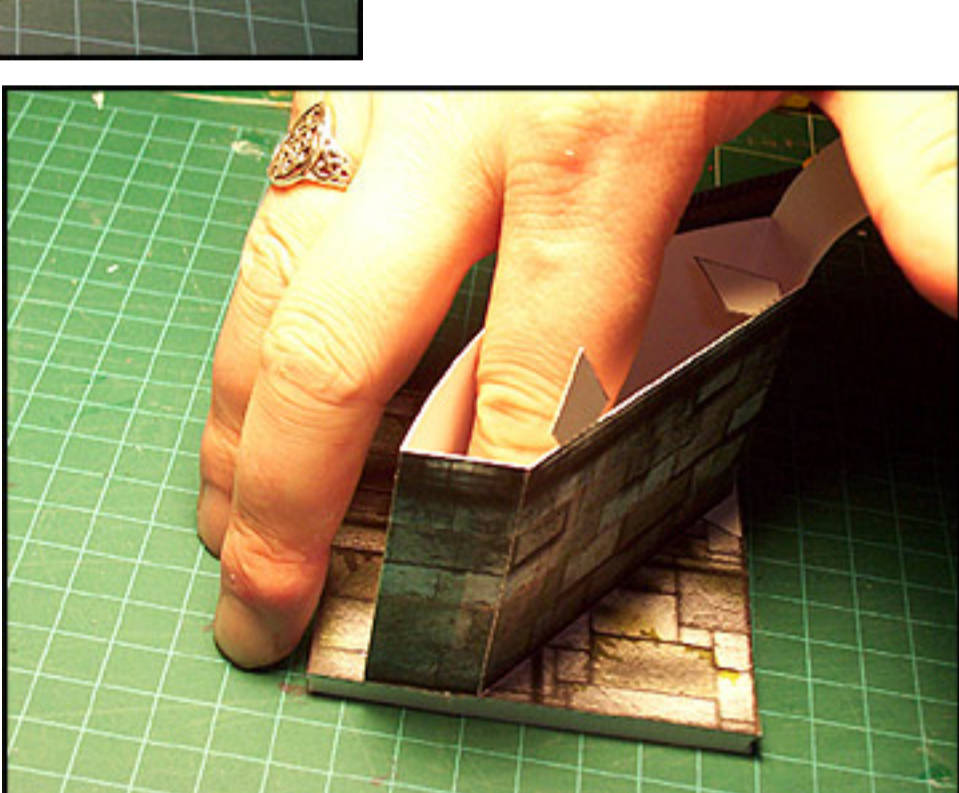

Before you rotate your model and glue the remaining end wall base in its triangular glue area giving the model a slight bend prepping it for placement. Apply glue to the triangular base and apply pressure to the tab. As this section is under the strain of a bend it is important that you maintain constant pressure on the tab for at least 60 seconds. Once again set aside and allow a short drying time before moving on to the next step.

The final glue tab for the base of the wall is in the middle of the outer bend. Push the outer wall in slightly beneath this tab and apply a small dab of glue to the base (see photo).

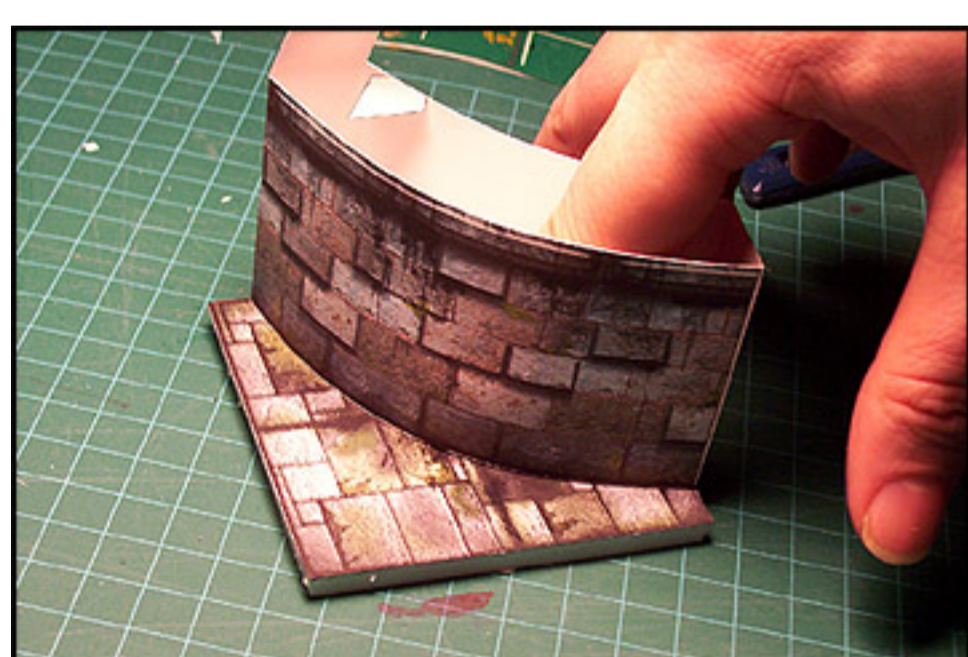
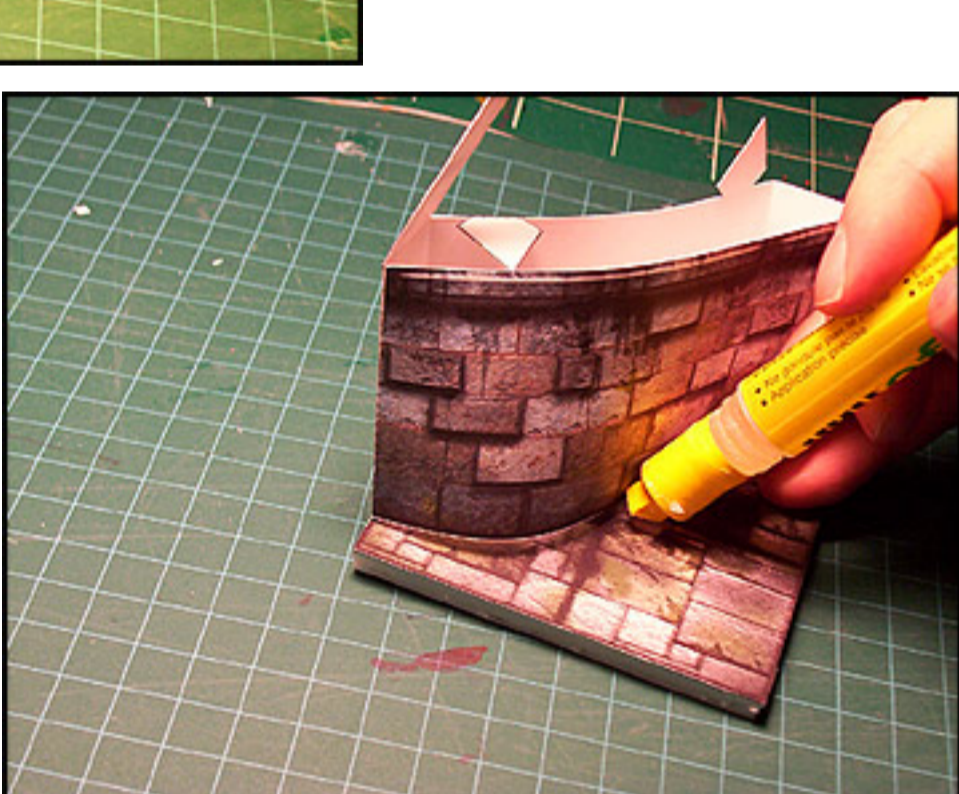

Apply pressure to the middle tab. At this point you want to "eyeball" the curve and make sure the tab is in a position that gives the curve a nice smooth arc. You don't need to be too precise as the top of the wall will hide any inconsistencies in the curve.

At this point you have two gluing options for the remaining top wall "cap" tabs.

**It's important to note that the base of the curved wall will not sit flush UNTIL the top cap is glued in place. Don't panic, this is normal.**



1. Depending on how skilled you are with your gluing you can apply a liberal amount of glue to all of the tabs and insert them all at once. You can then work your way around the wall applying equal pressure to each tab until the glue has set.

2. If you're not comfortable with the "all at once" method you can bend the curved wall cap upwards and glue each tab in place one at a time. Working your way out to the end glue tab.

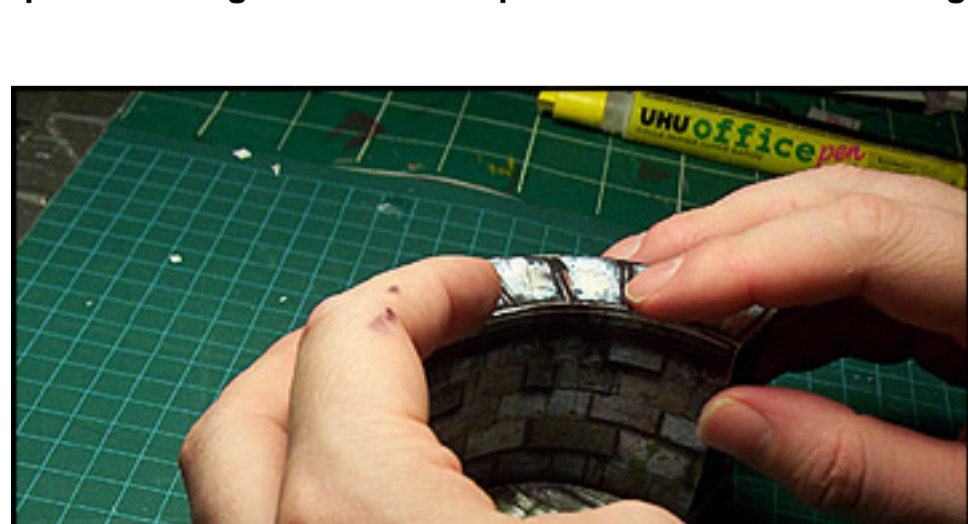

Regardless of which techniques you choose don't be too upset if in the end you have any gaps or openings along the top edge of the curve. This is easily fixed by applying a small bead of glue along the edge of the affected area and simply holding the two corners together for a brief period.

Once all the tabs are glued in place be sure to edge your model with a black or grey felt.

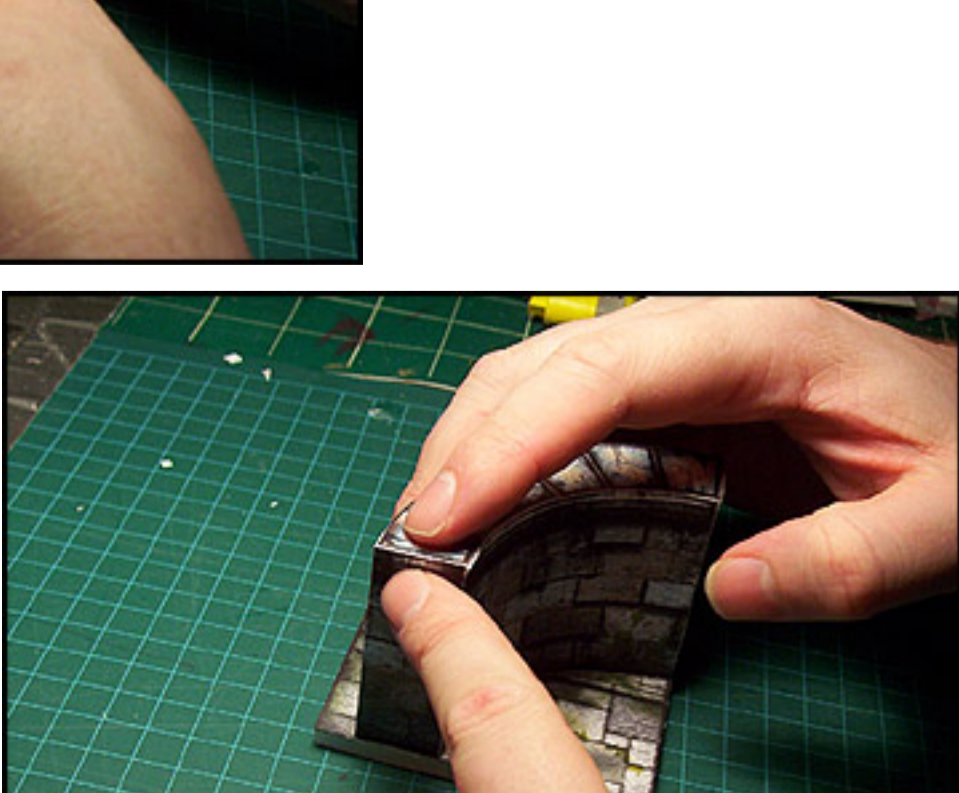

**(What is "Edging"? Please refer to the included "Beginners Guide" or visit [www.worldworksgames.com](http://www.worldworksgames.com) for more resources and video tutorials.)**