

Model:	Doors
Difficulty:	Moderate
Build Time:	15 mins
Duplications:	4 to 6



Pirating KILLS small businesses like this one. If you enjoy WorldWorks Products and you want us to continue please support us by **NOT** sharing these files. **Please help keep us alive!**



Cut, score and fold as noted paying careful attention to areas marked with "Reverse side score" arrows.

Mount your door bases on a piece of foamcore. (Please see the "Pro Masterboard" section for complete instructions on mounting your base). It is vital that you complete this step now not later!

Glue the main wall tab to the inside of the opposing wall.

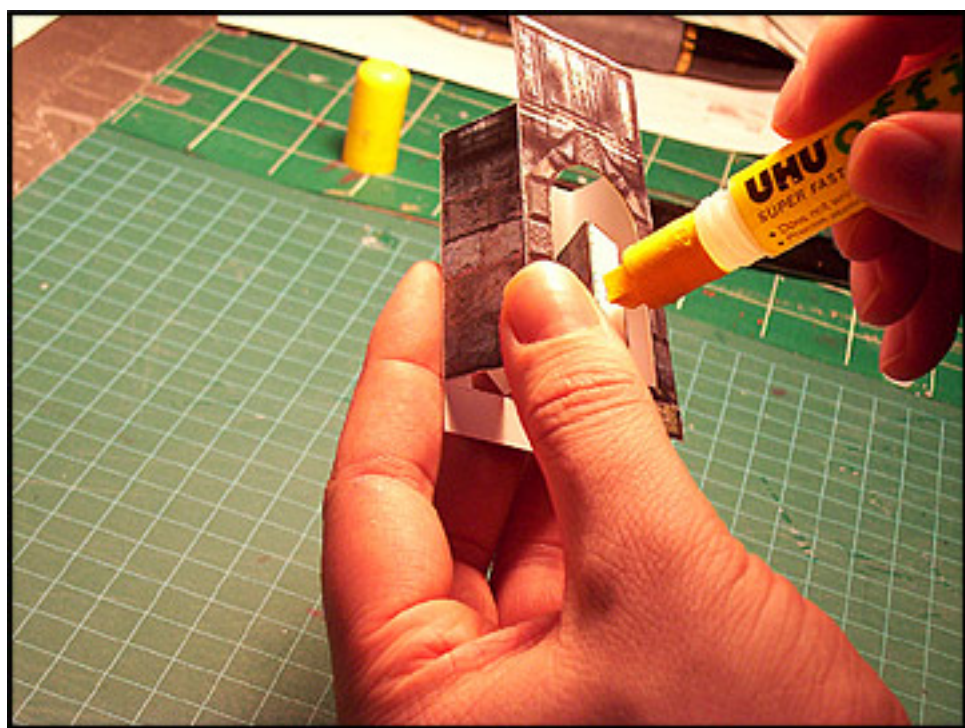
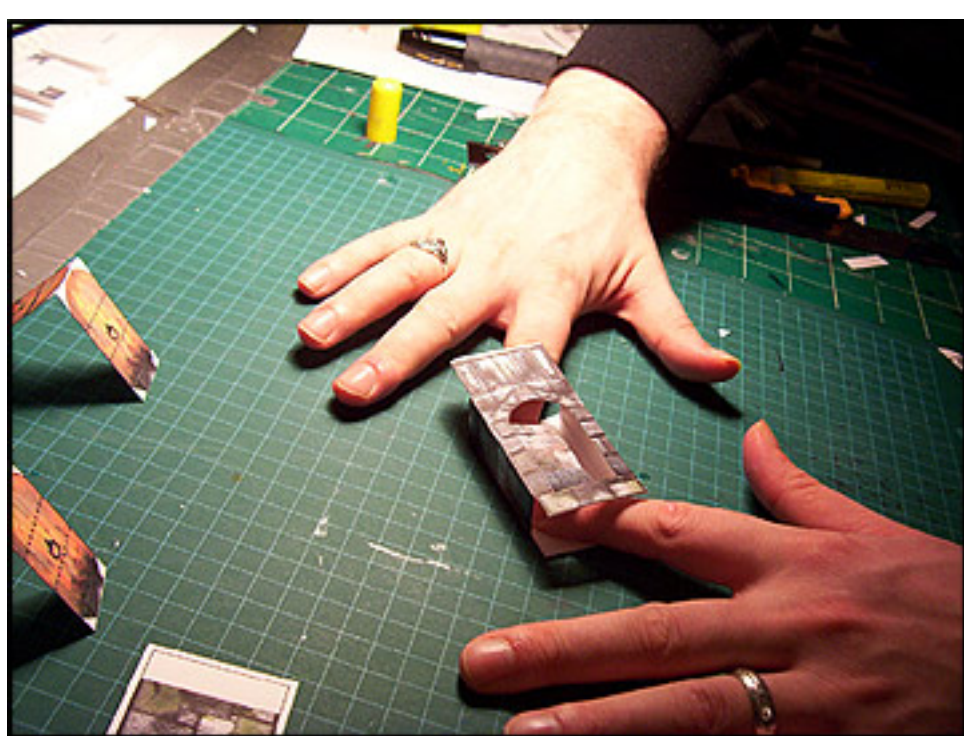

Bend the inner wall tab back and apply a thin bead of glue.

Glue the inner wall tab in place by using a toothpick or another skinny implement to apply pressure (see photo). Repeat these steps on the remaining inner wall.

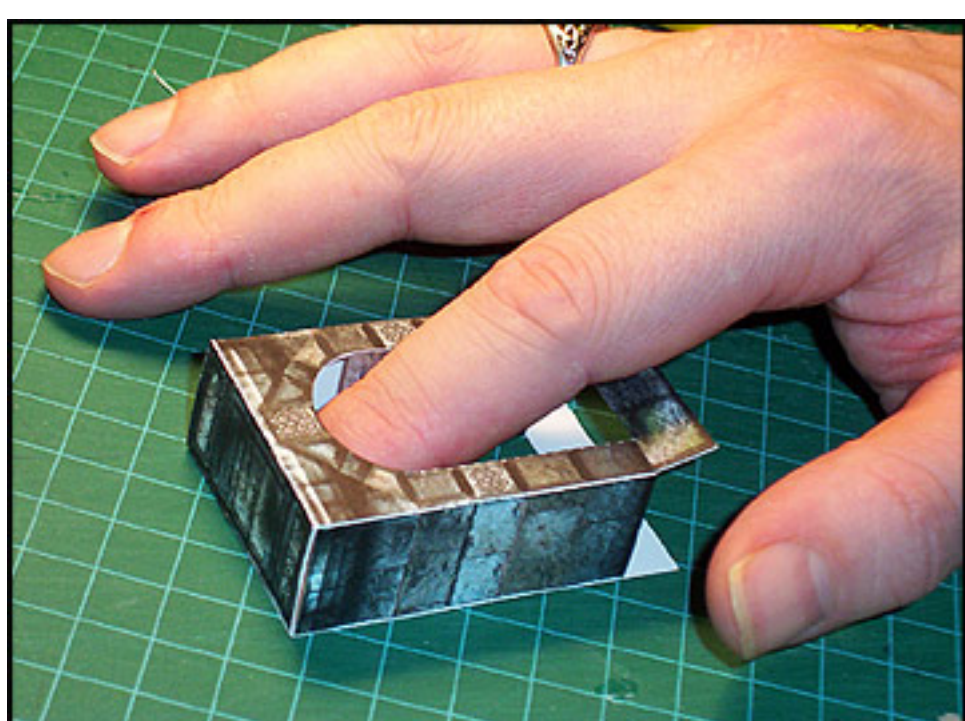
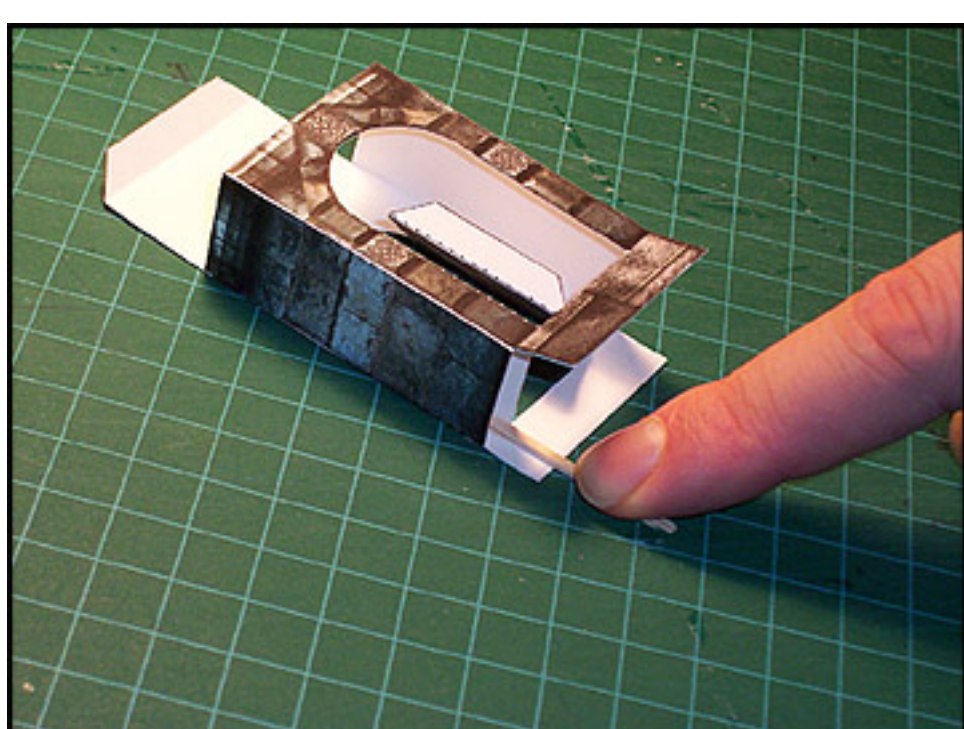

Glue the top wall "cap" glue tab along the inner wall.

"Sandwich glue" the door sections together and allow a brief drying period.

Be careful not to glue the base tabs together as these are used to keep the doors from falling over.

Once dry cut away the remaining white space.

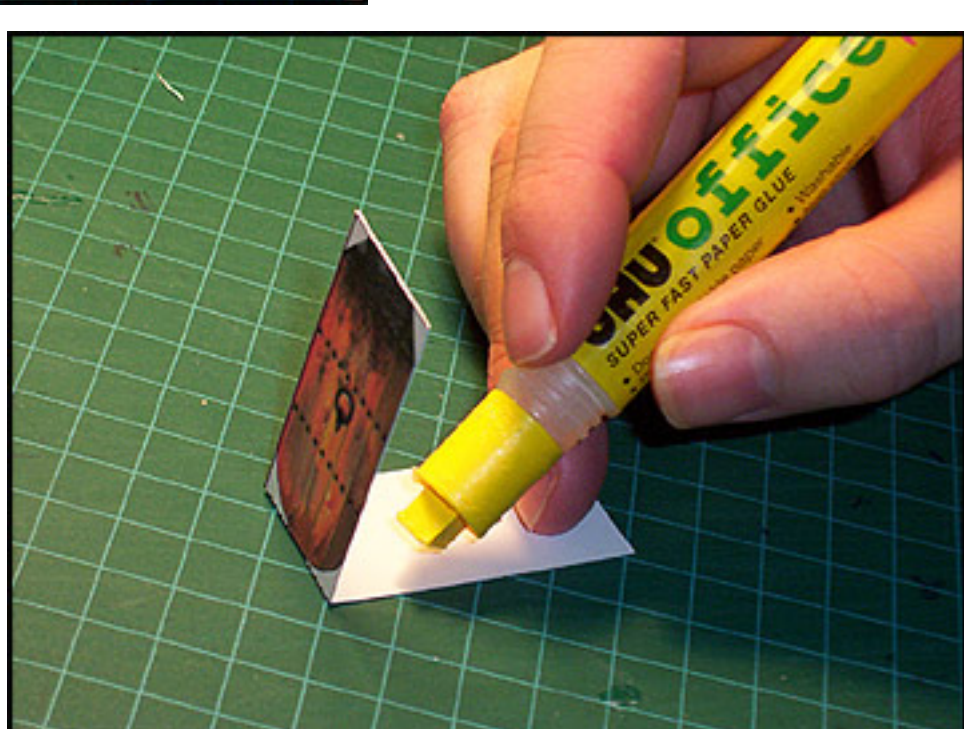

From the main door frame glue the remaining base tabs to the glue bases where noted (within the white space on the glue base).

Once all the tabs are glued in place be sure to edge your model with a black or grey felt.

(What is "Edging"? Please refer to the included "Beginners Guide" or visit www.worldworksgames.com for more resources and video tutorials.)