

Model by NOVA



NOVAMODEL

№18

Модели для Вас от NOVA при поддержке сайта only-paper.ru

ПРИГОРОДНЫЙ АВТОБУС



1:32
МАСШТАБ

ПАЗ-672М

НЕ ДЛЯ КОММЕРЧЕСКОГО ПОЛЬЗОВАНИЯ

nova200609@yandex.ru



Технические характеристики

Класс автобуса	малый
Пассажировместимость:	
- общее количество мест	45
- в т.ч. посадочных	23
Габаритные размеры, мм	7150x2440x2952
Колёсная база, мм	3600
Снаряженная масса, кг	4535
Двигатель	ЗМЗ-672 (карбюраторный)
Количество цилиндров	8 V
Рабочий объём, мл	4250
Мощность, л.с.	115
Контрольный расход топлива при 60 км/ч, л/100 км	20,5
Макс. скорость, км/ч	80
Емкость топл. бака, л	105
Число ступеней КПП	4
Рулевой механизм	глобондный червяк и трехребеневый ролик
Двери	с пневмоприводом
Вентиляция	6 люков в крыше, форточки на боковых окнах
Сцепление	однодисковое, сухое с гидравлическим приводом
Производитель	Павловский Автобусный Завод

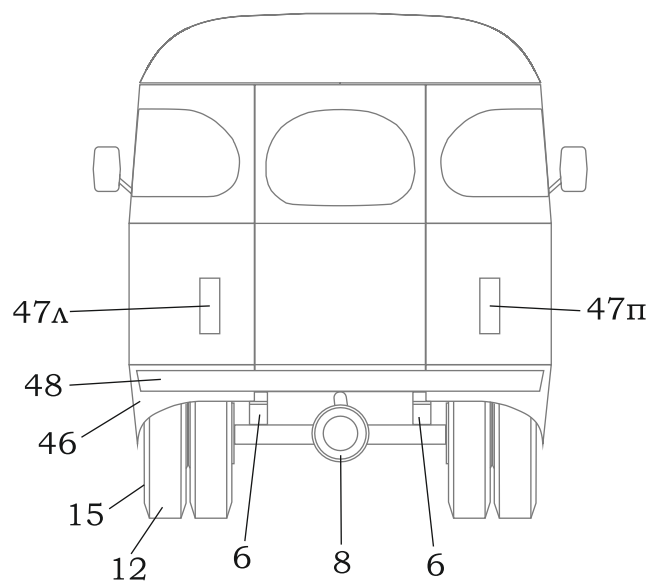
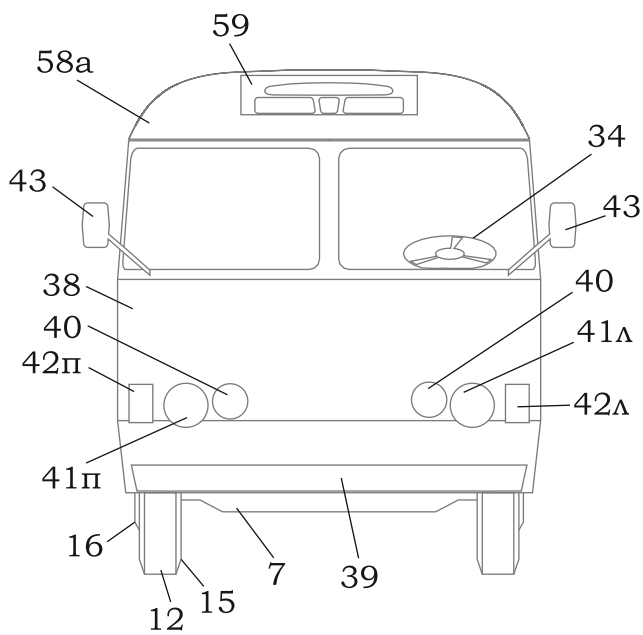
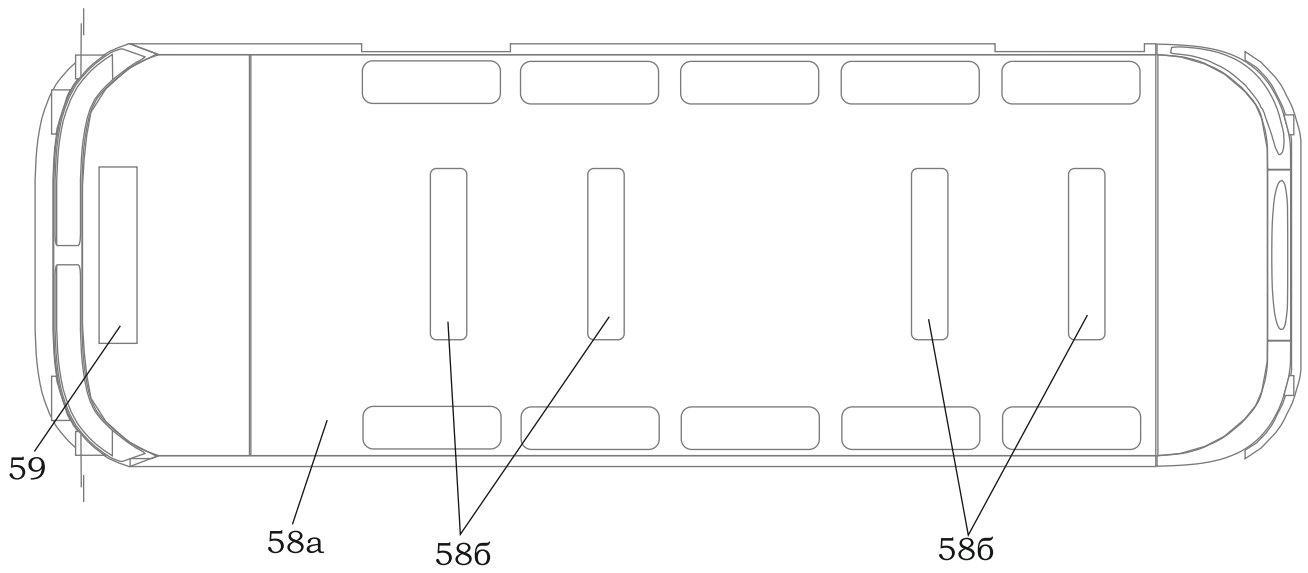
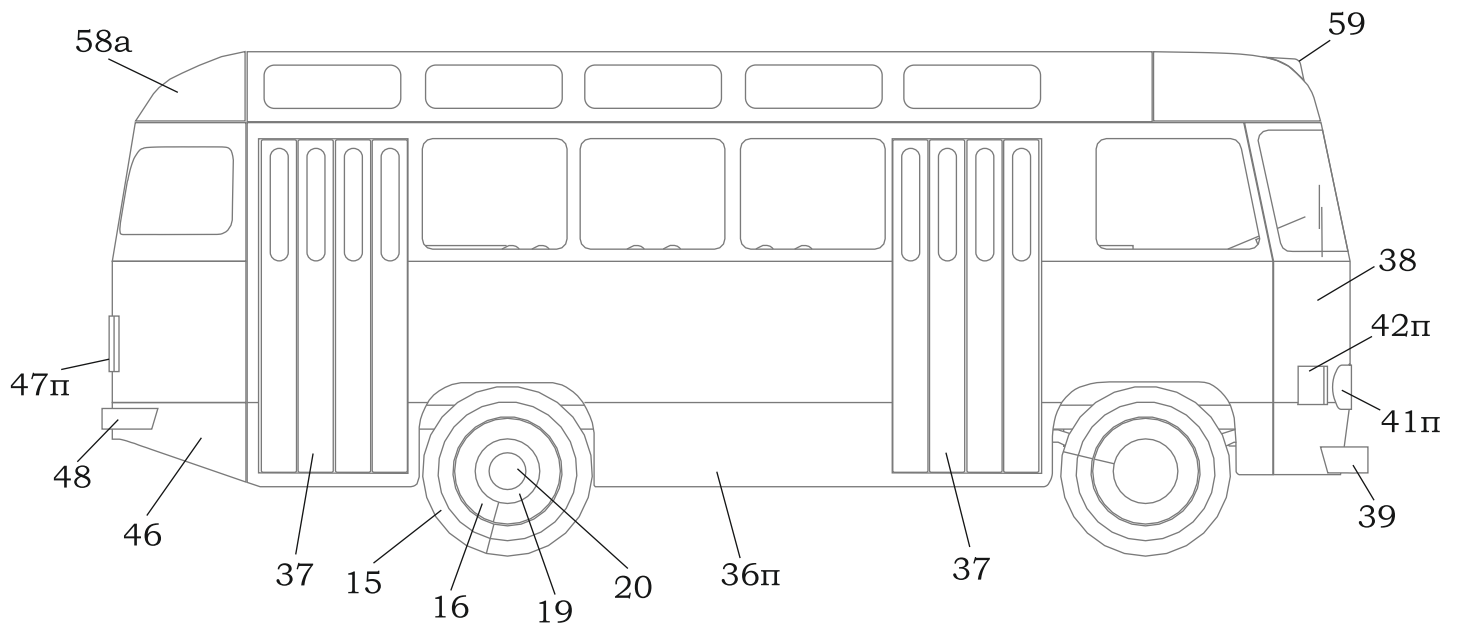

инструкция

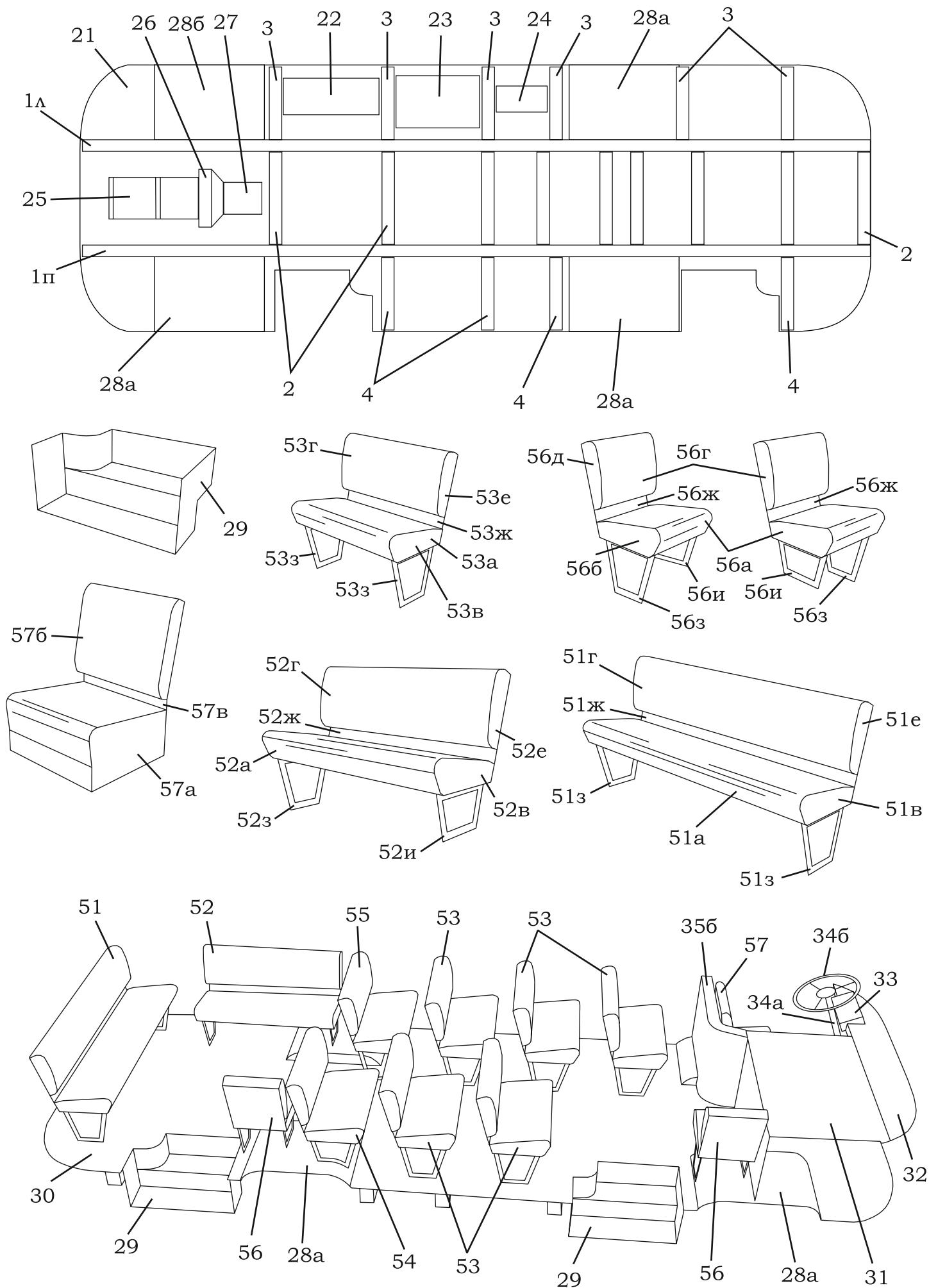

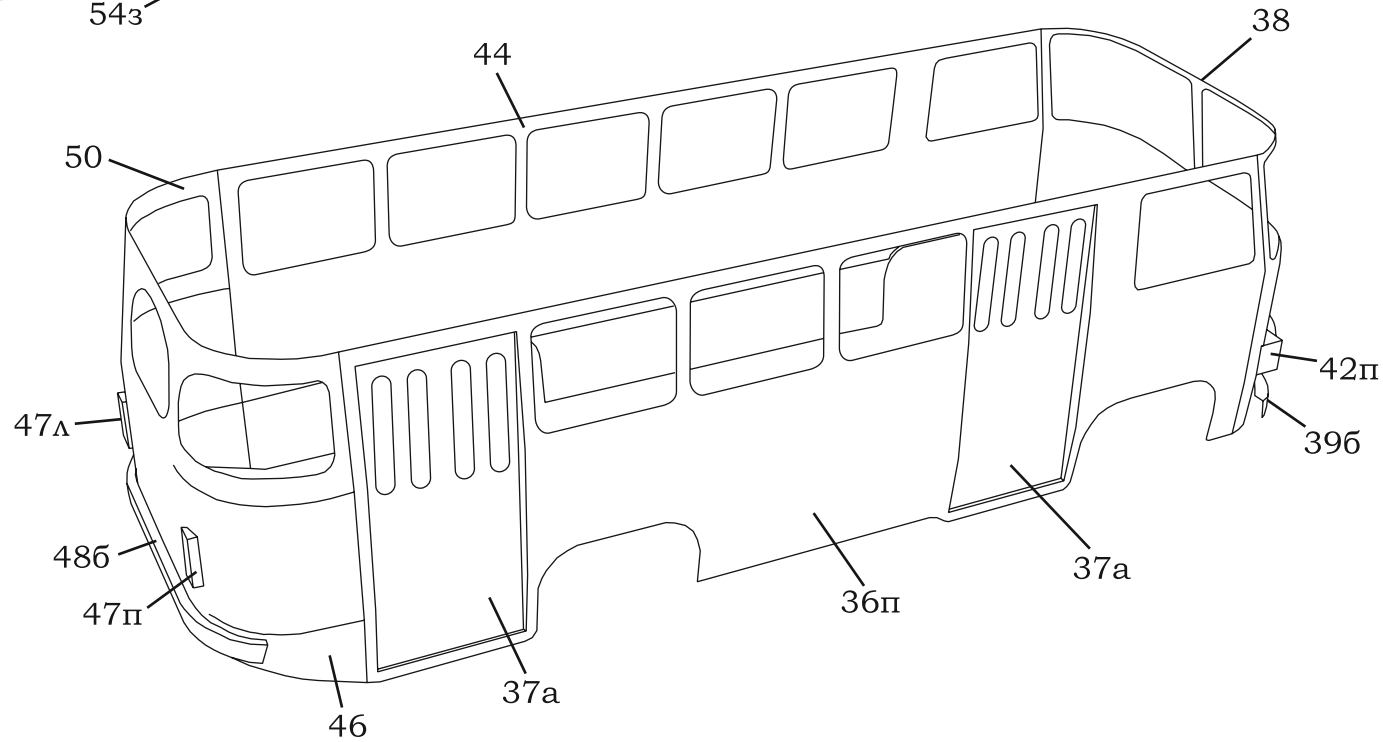
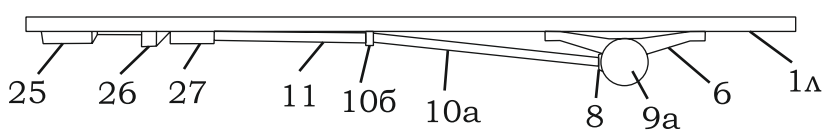
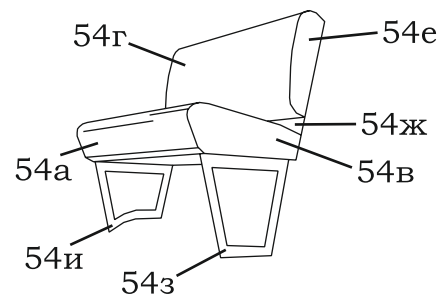
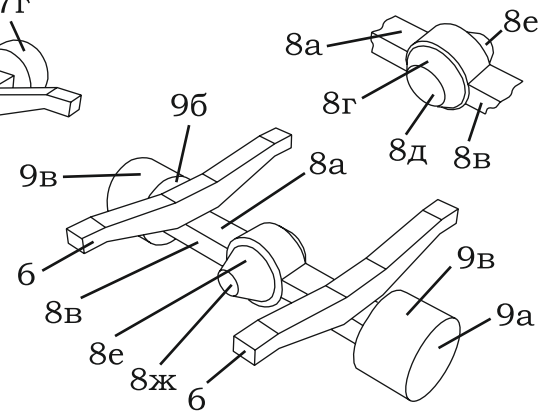
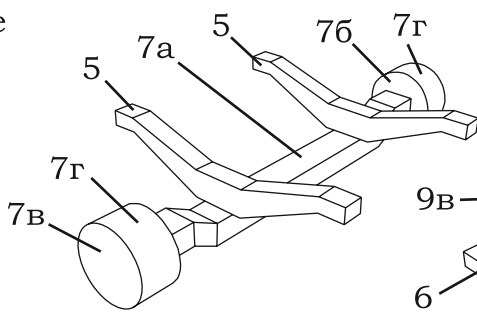
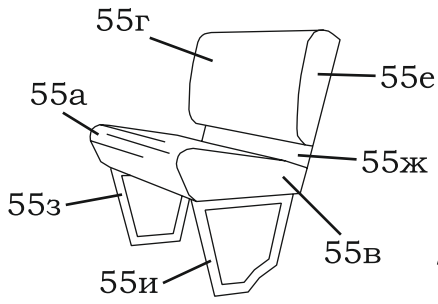
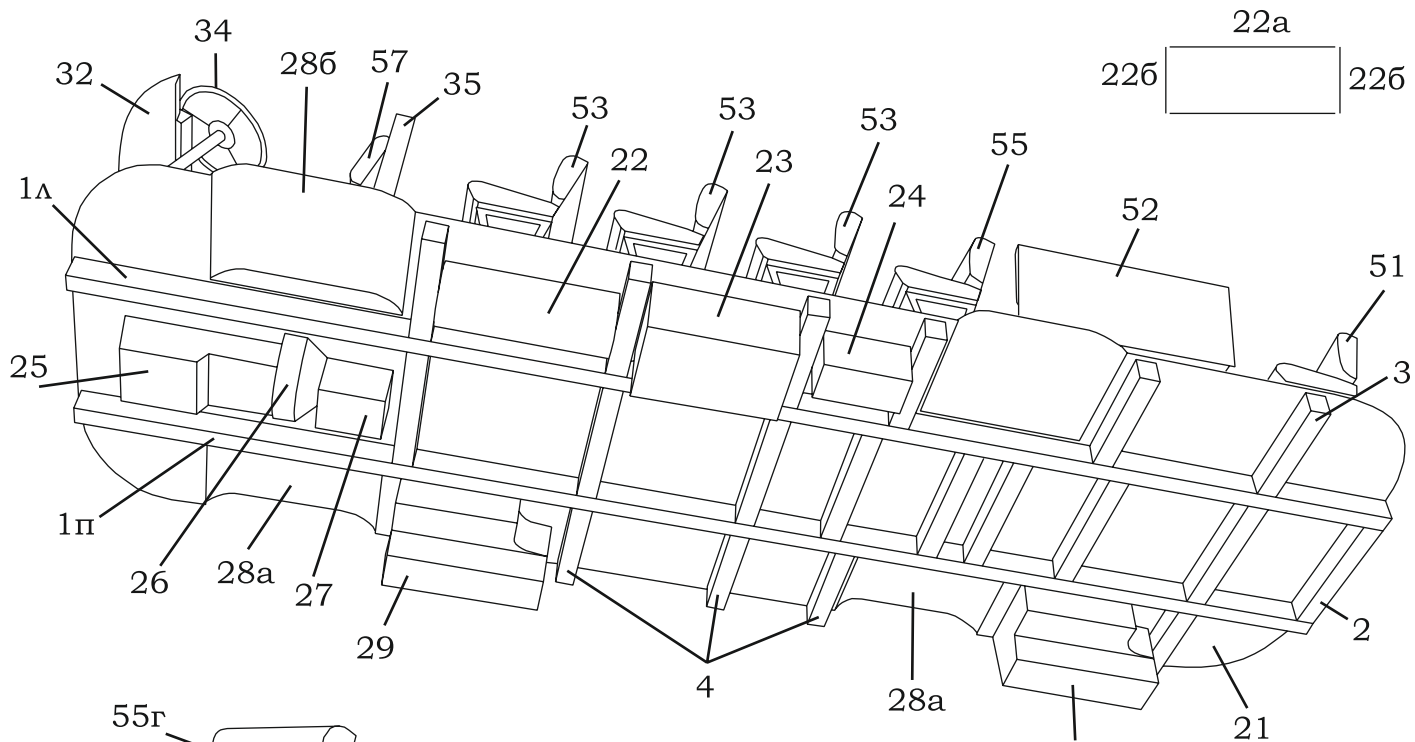

инструкция

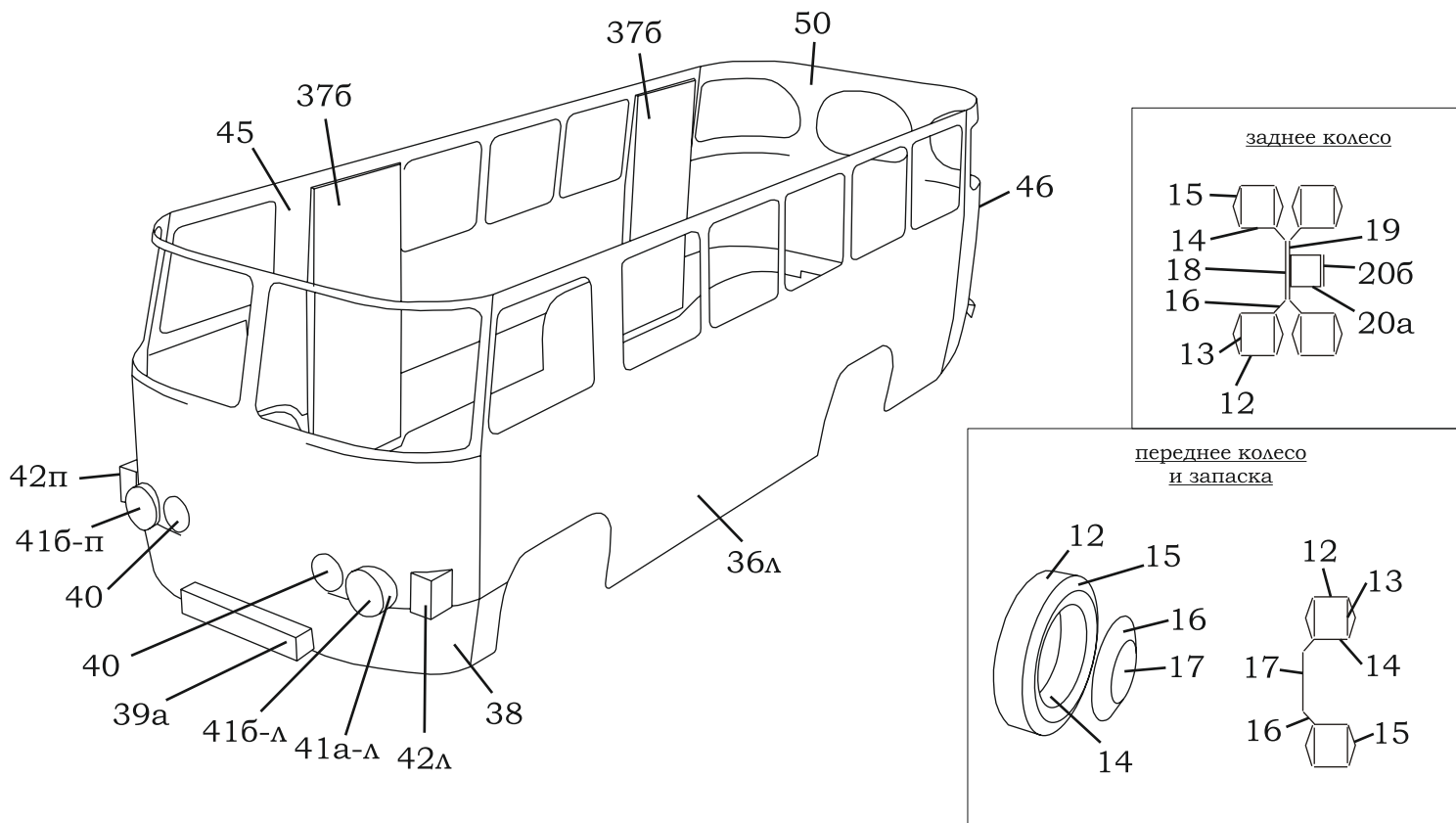

Шаблоны стекол

к детали 36л

к детали 36п

к детали 36п

к детали 376 (2 шт)

к детали 58а (2 шт)

к детали 38

к детали 46

Модель автобуса ПА3-672М. Масштаб 1:32.
Печатать на бумаге плотностью 160 г/см.
* - подклеить на картон),5 мм

Автор - Суздаев Виктор aka NOVA

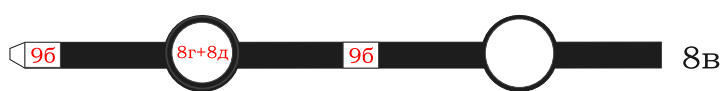
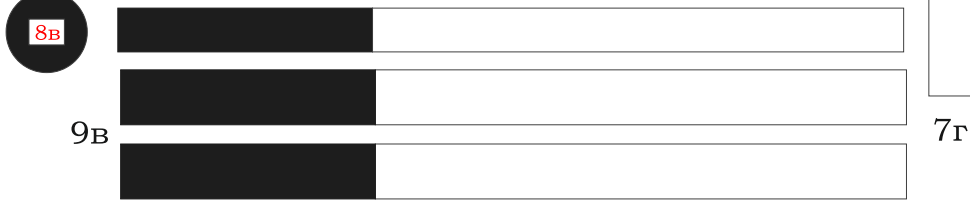
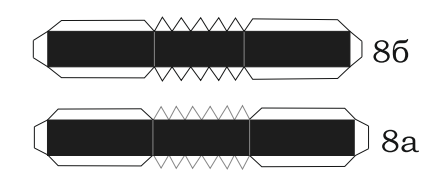
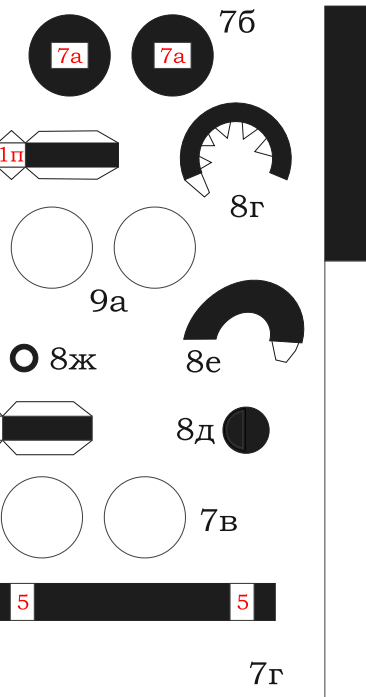
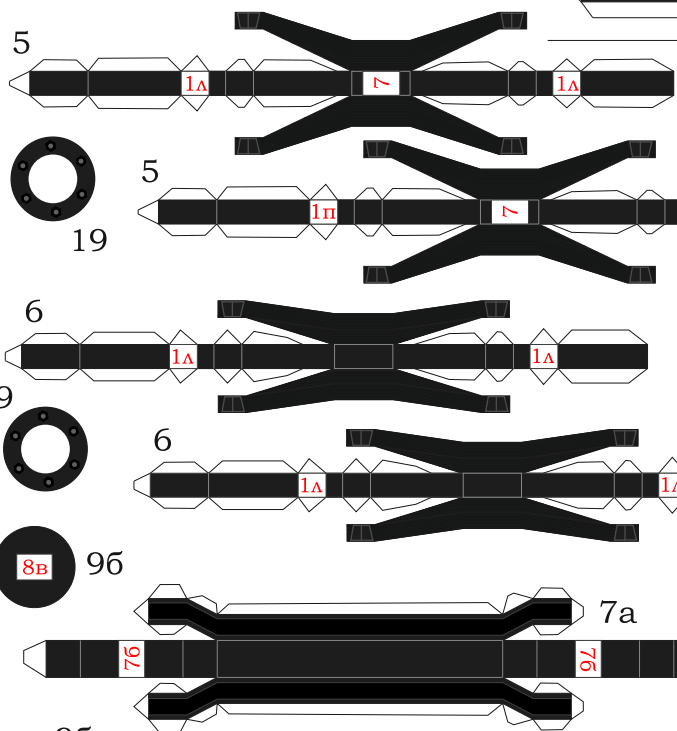
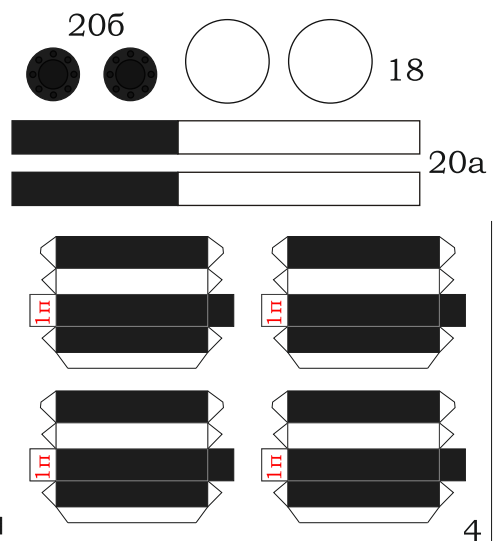
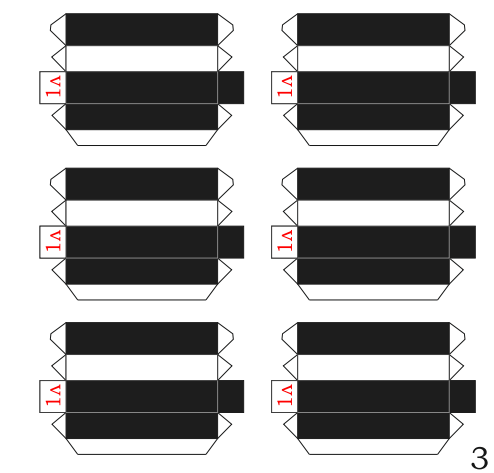
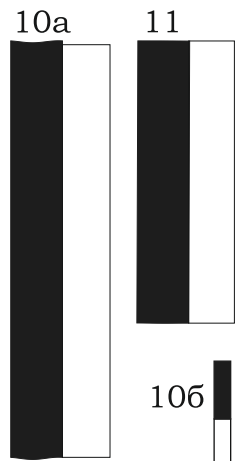
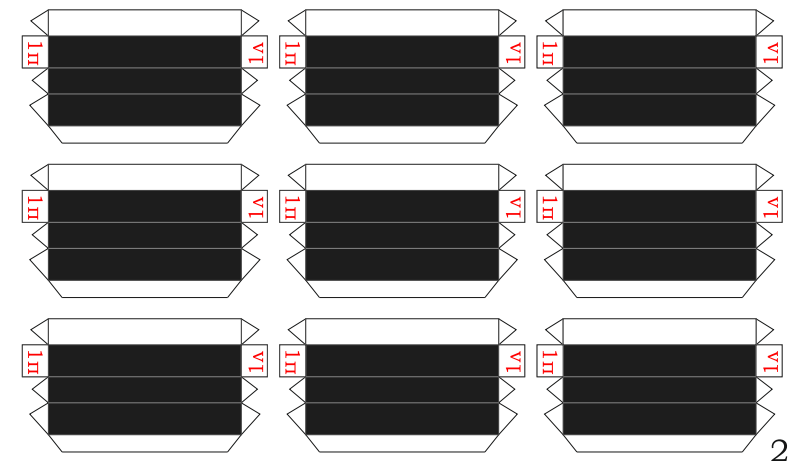
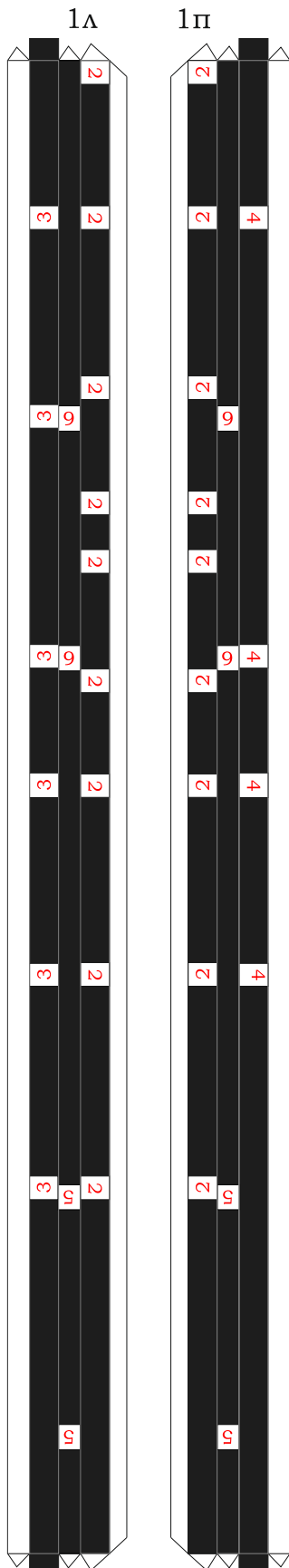

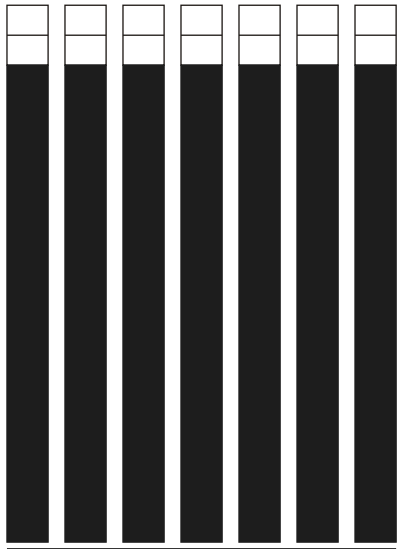

14

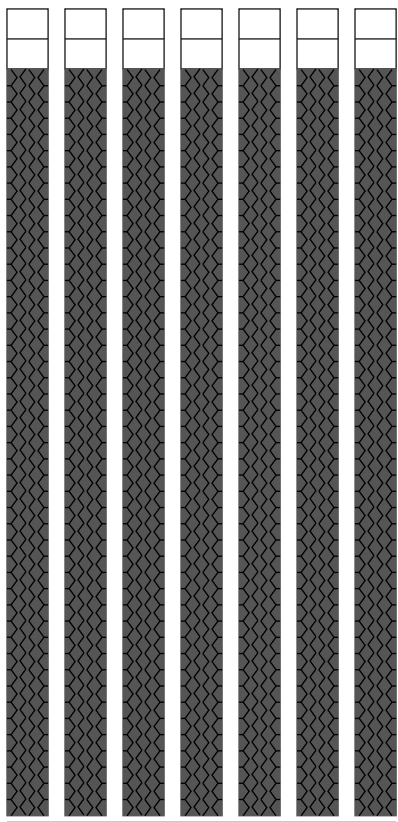

12

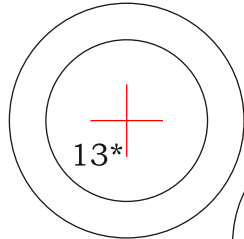

13*

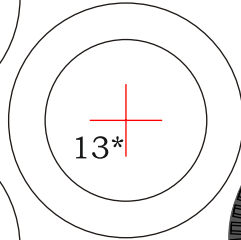

13*

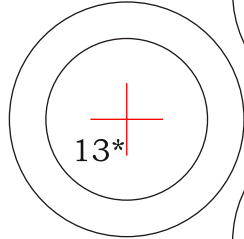

13*

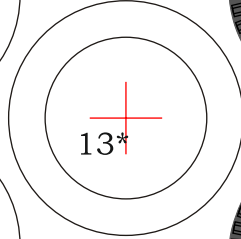

13*

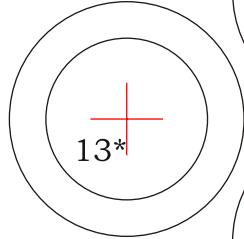

13*

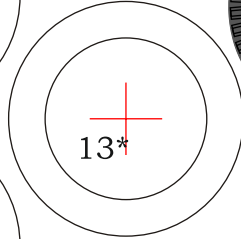

13*

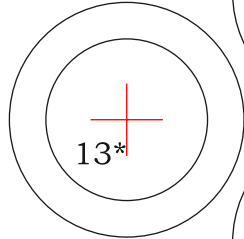

13*

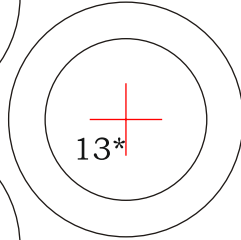

13*

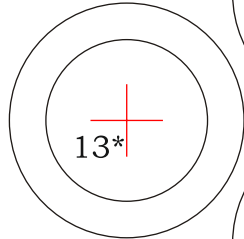

13*

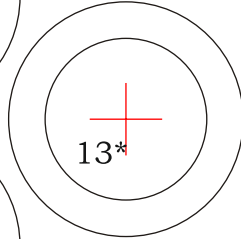

13*

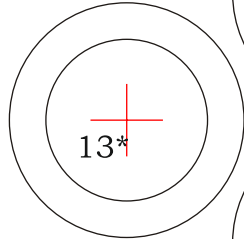

13*

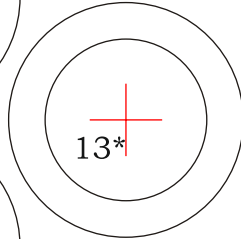

13*

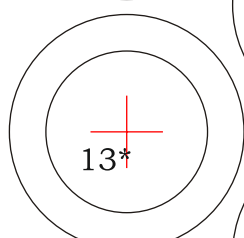

13*

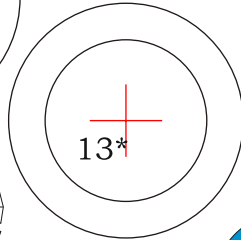

13*

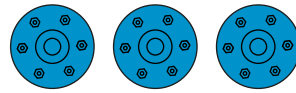

17*

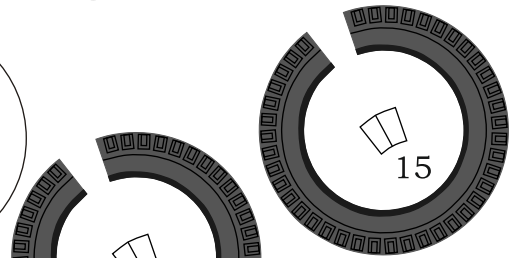

15

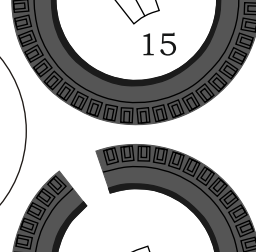

15

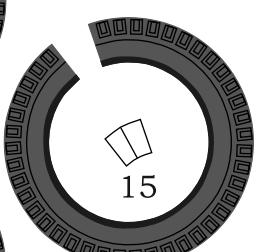

15

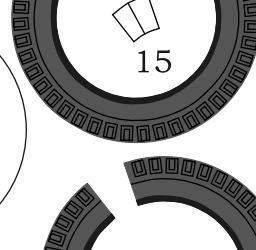

15

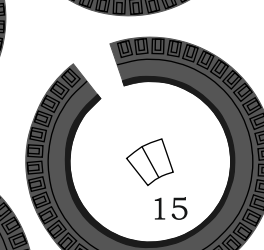

15

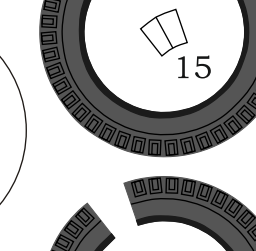

15



15

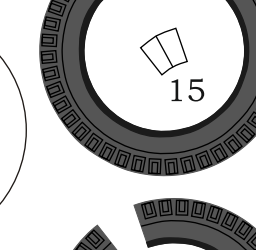

15

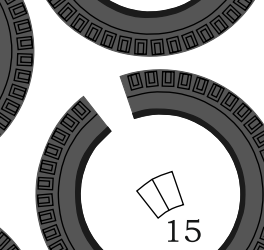

15

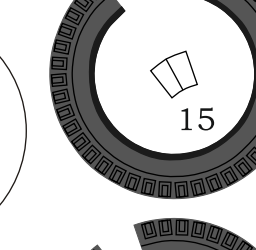

15

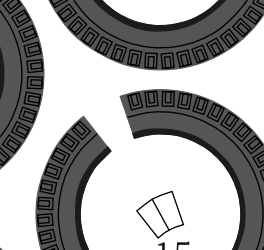

15

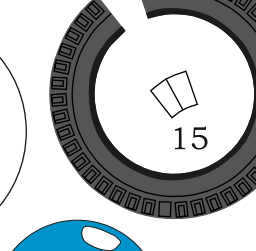

15

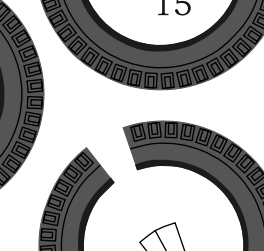

15

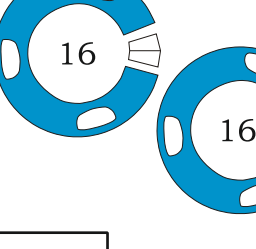

15

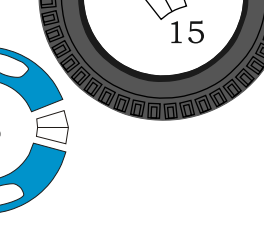

15

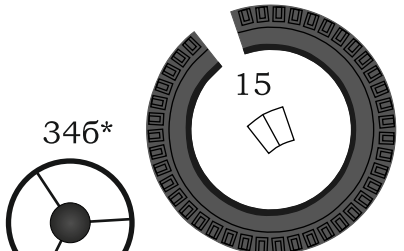

15

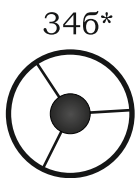

346*

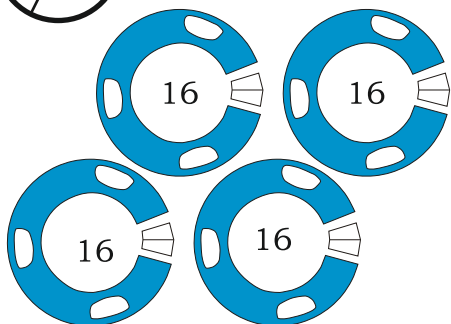

16

16

16

16

16



34a

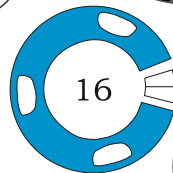

16

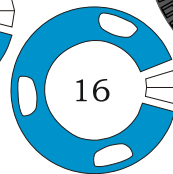

16

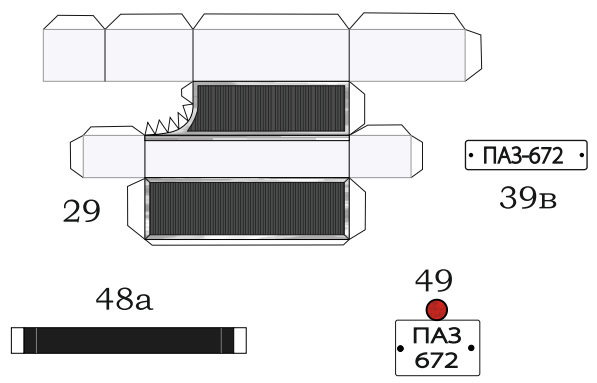
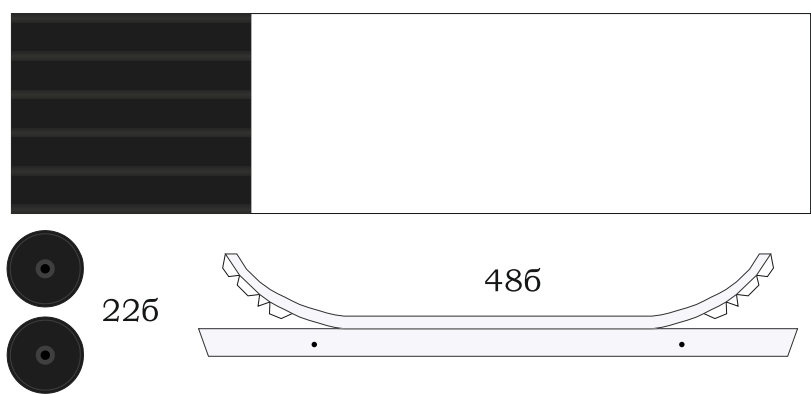
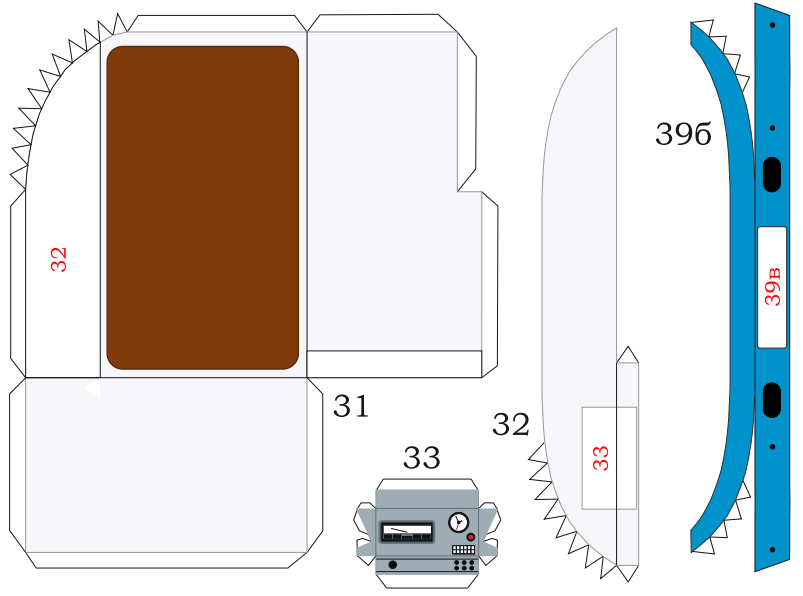
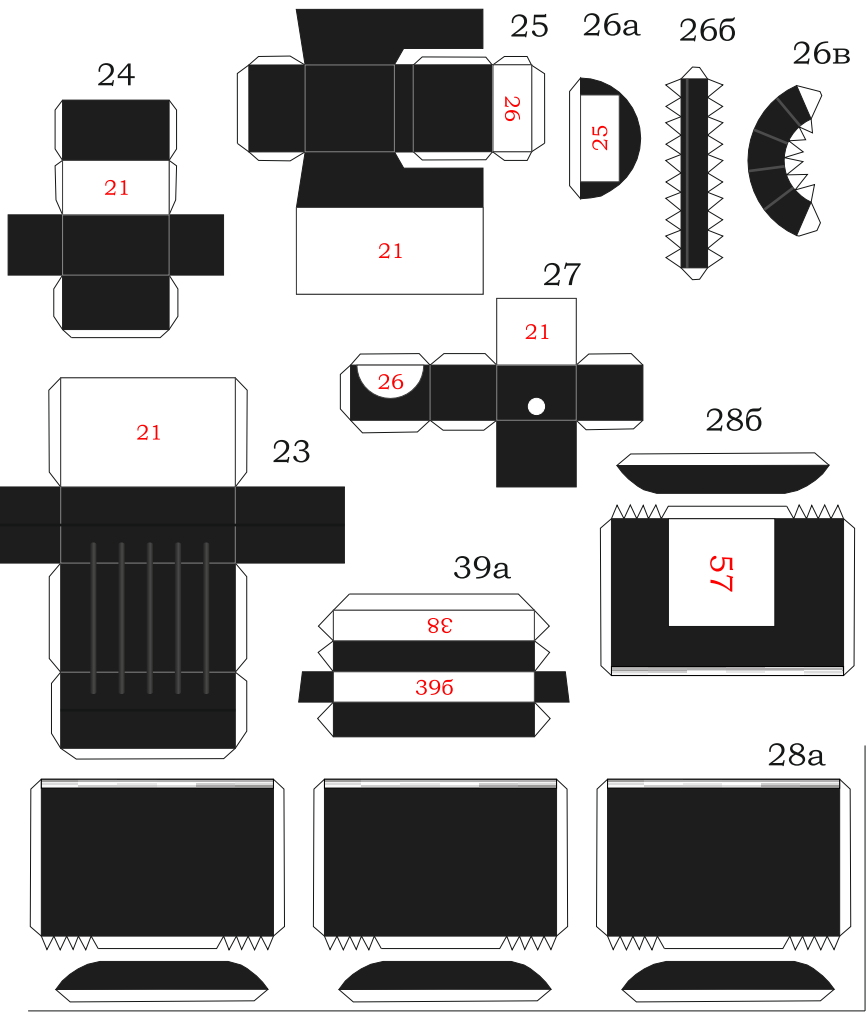
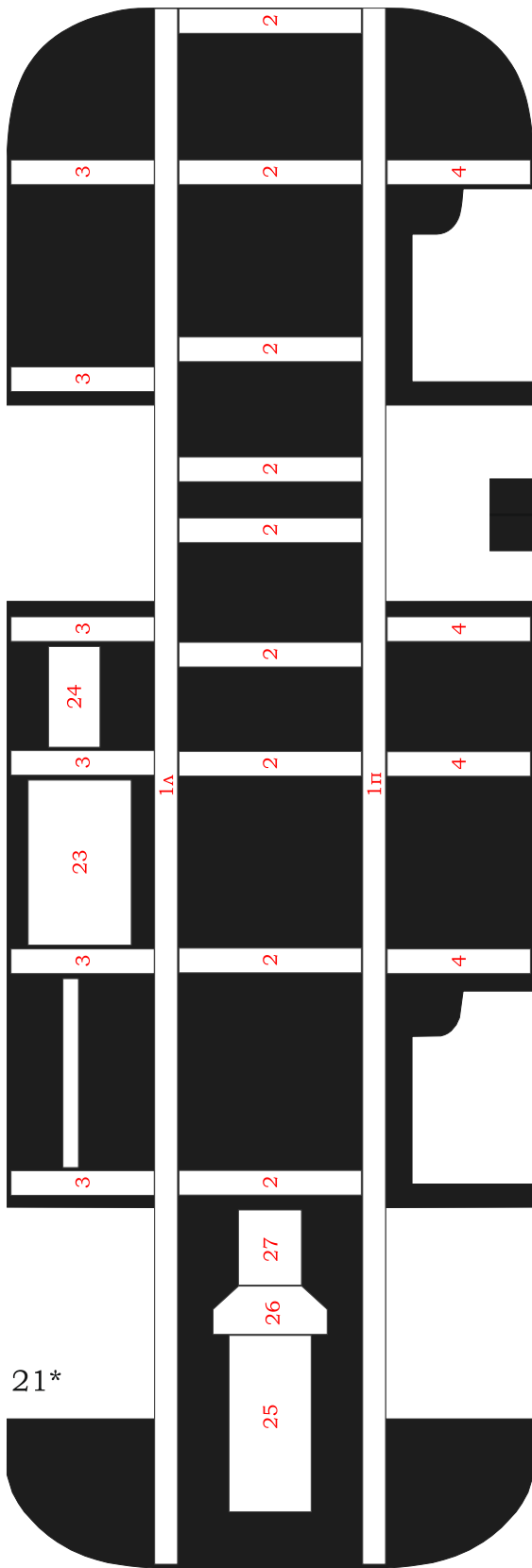

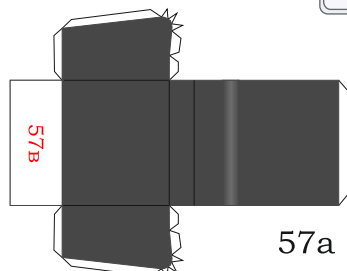
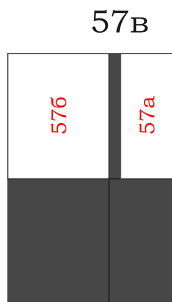
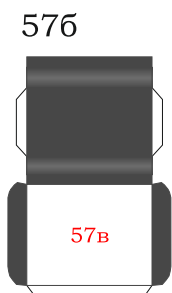
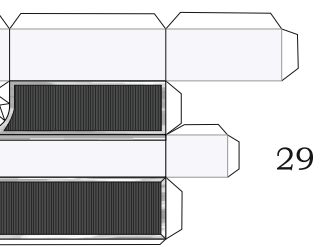
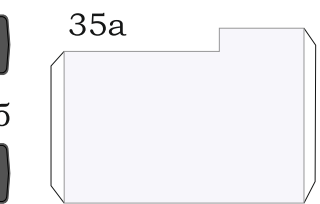
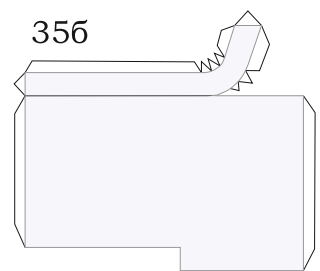
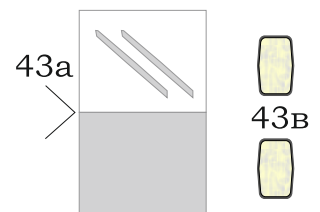
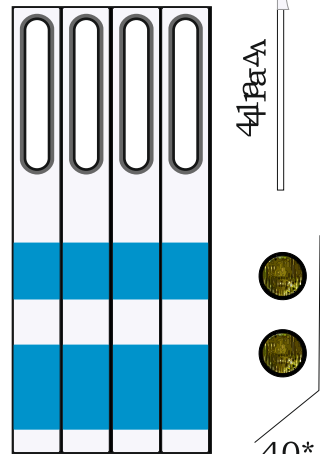
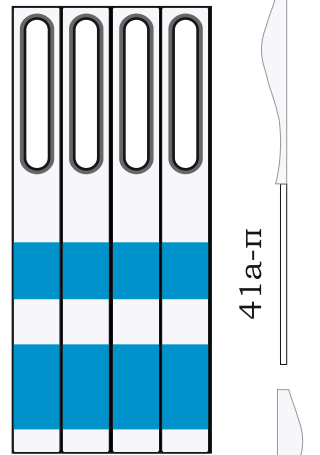
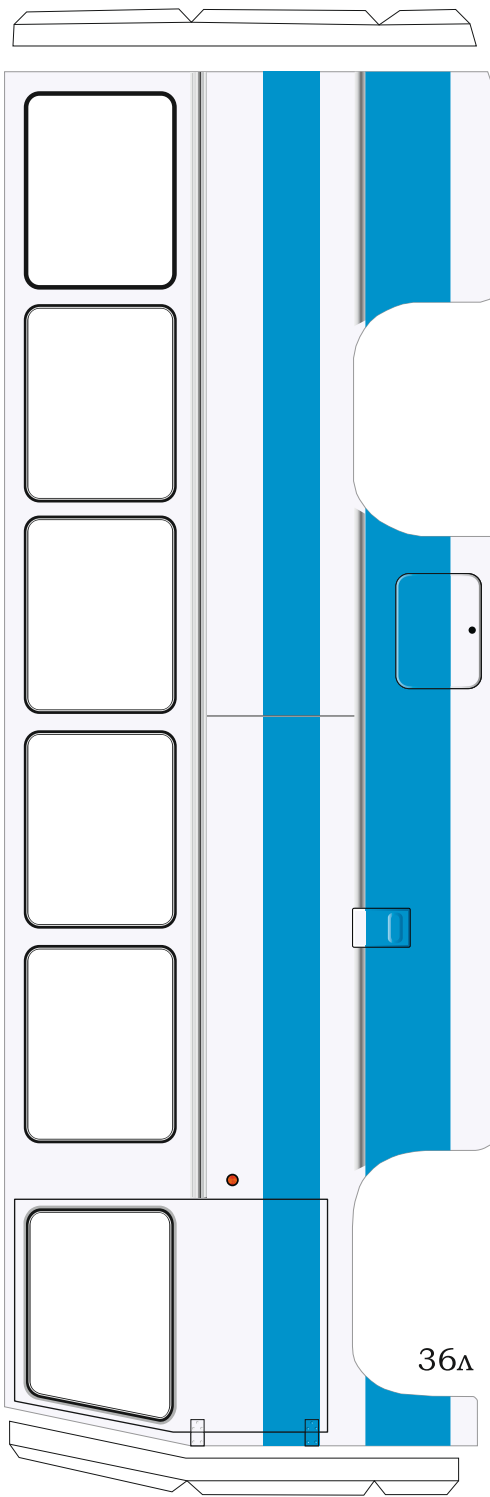
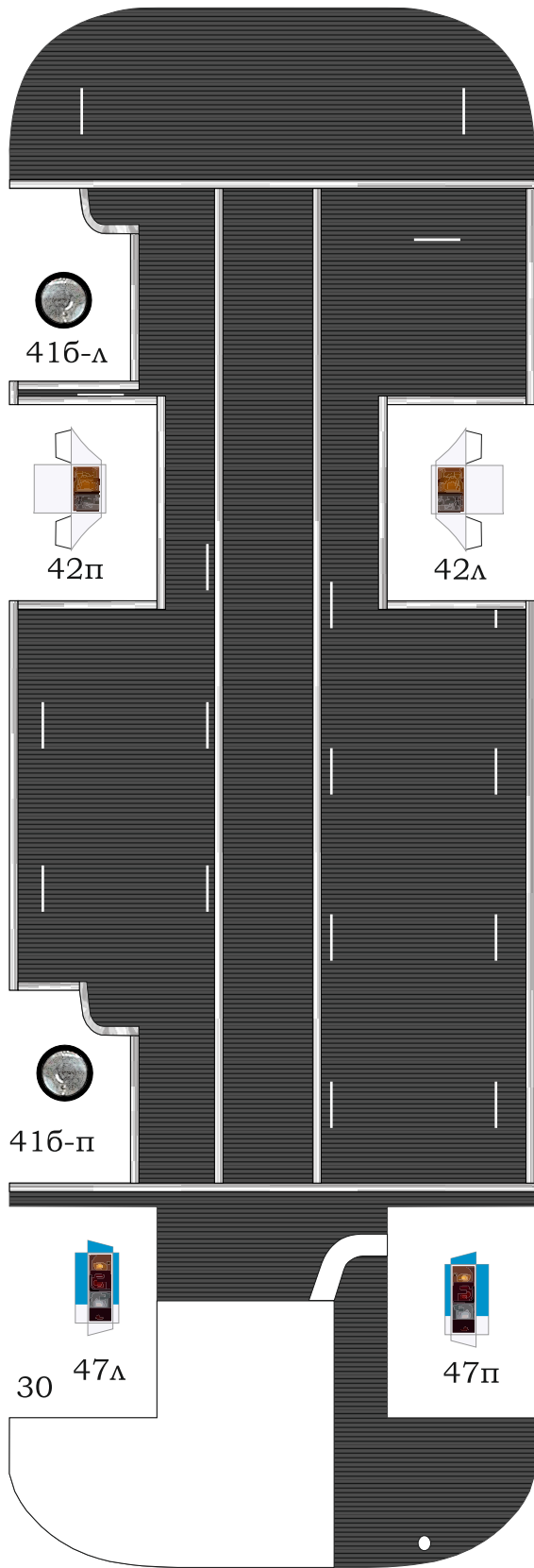

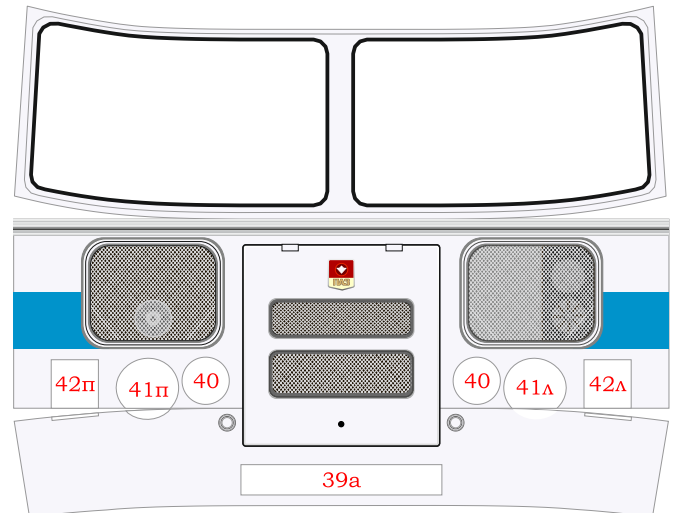
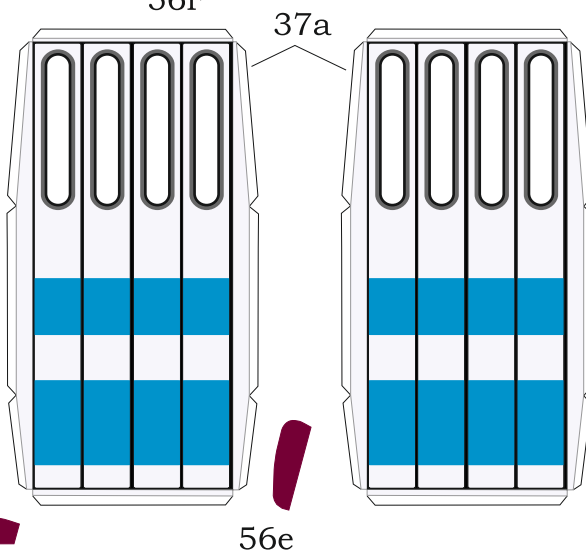
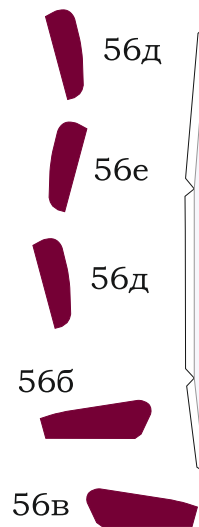
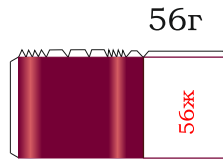
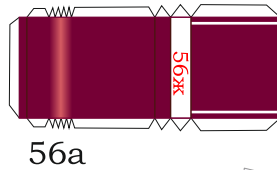
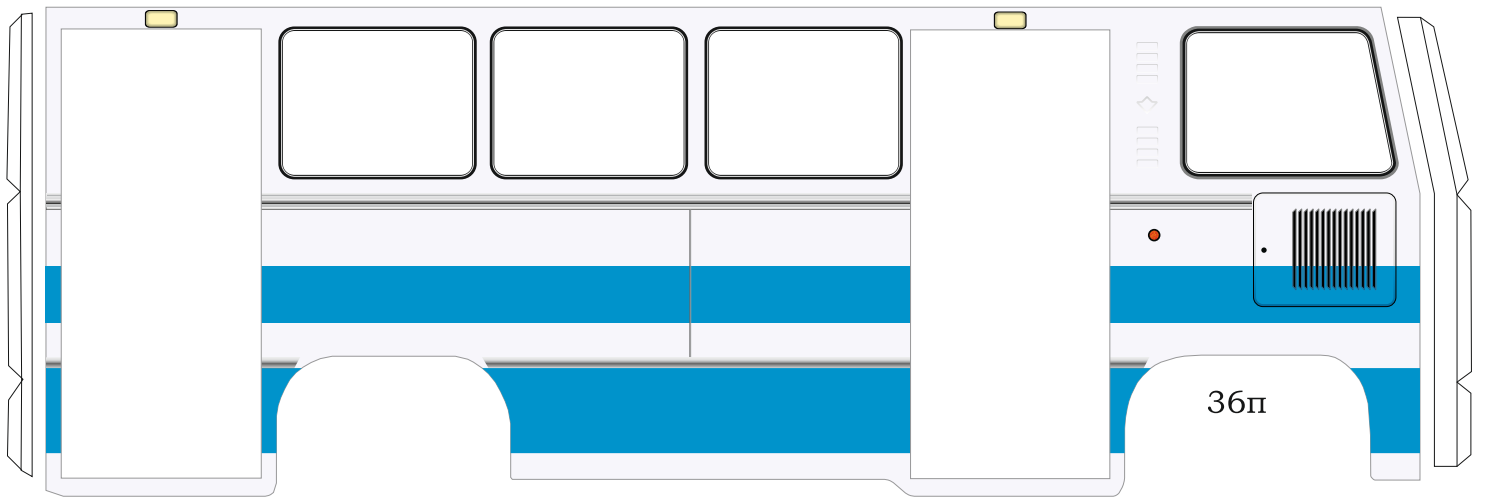

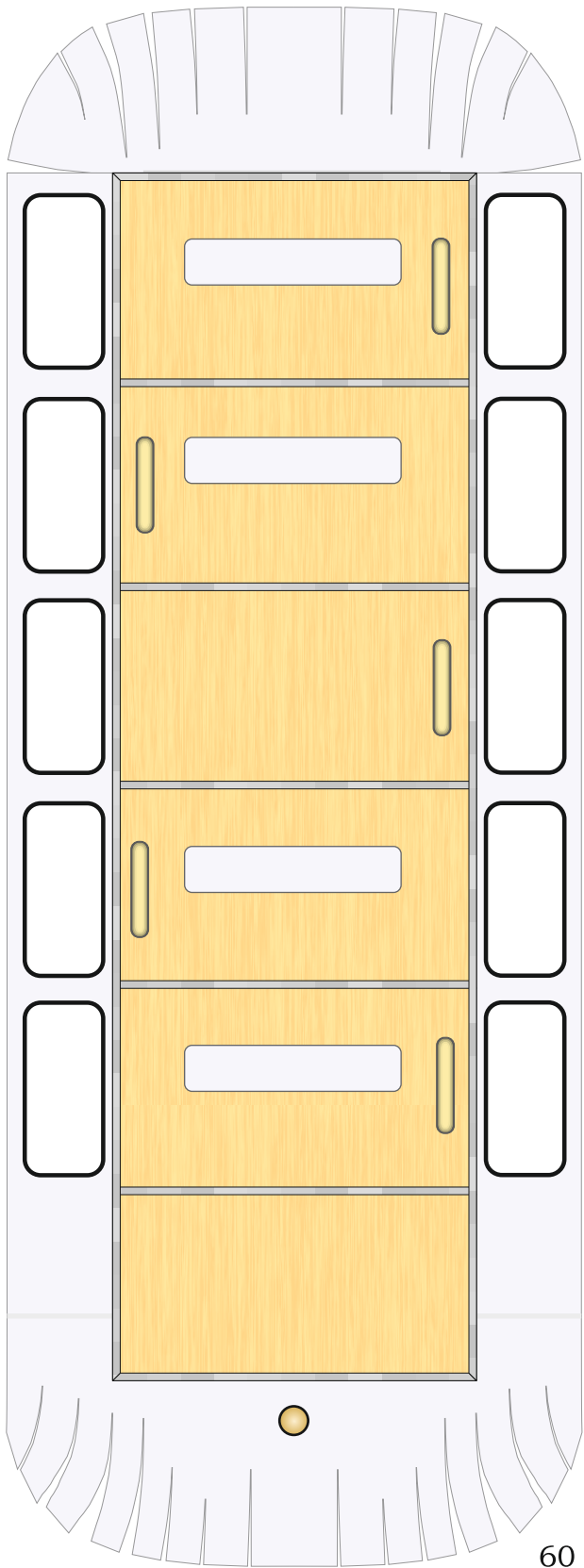
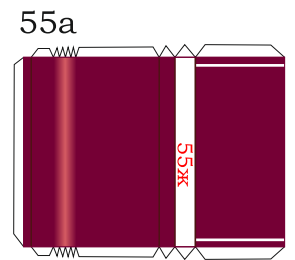
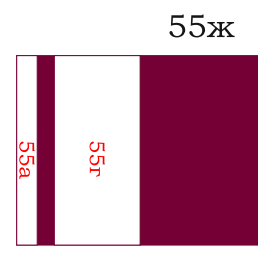
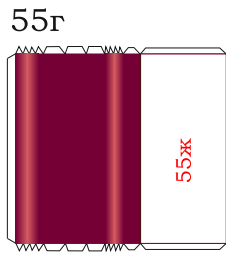
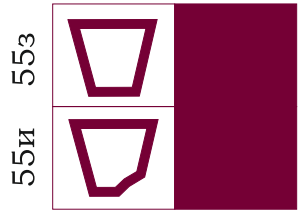

59

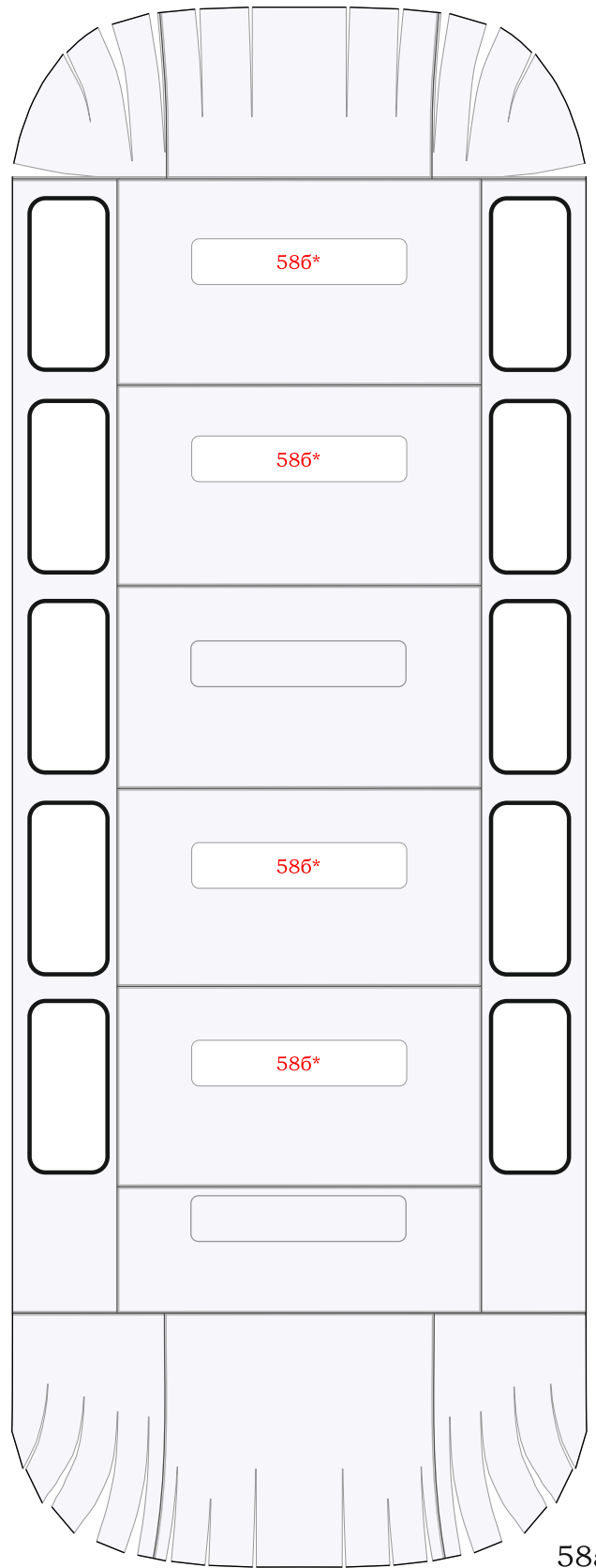

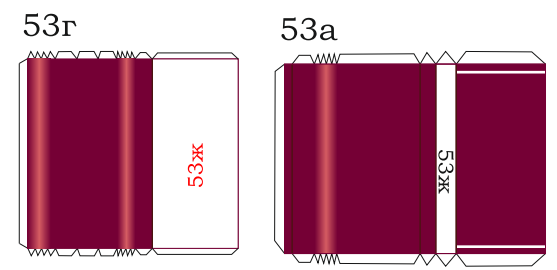
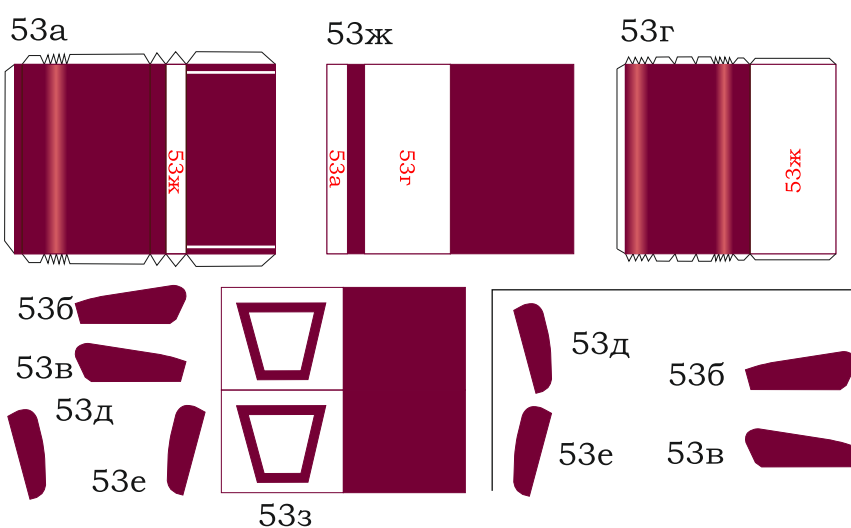
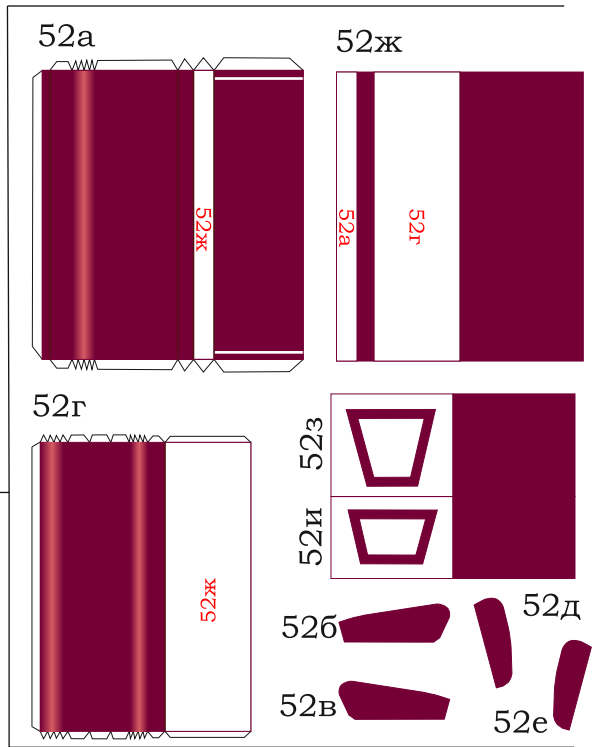
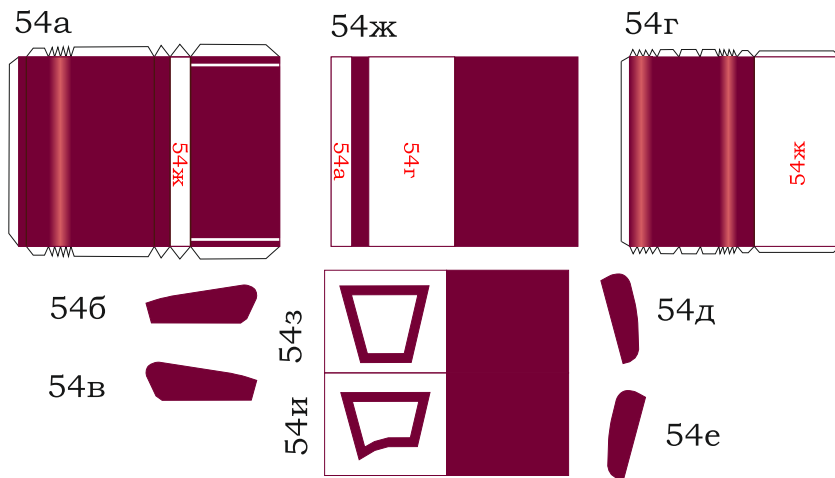
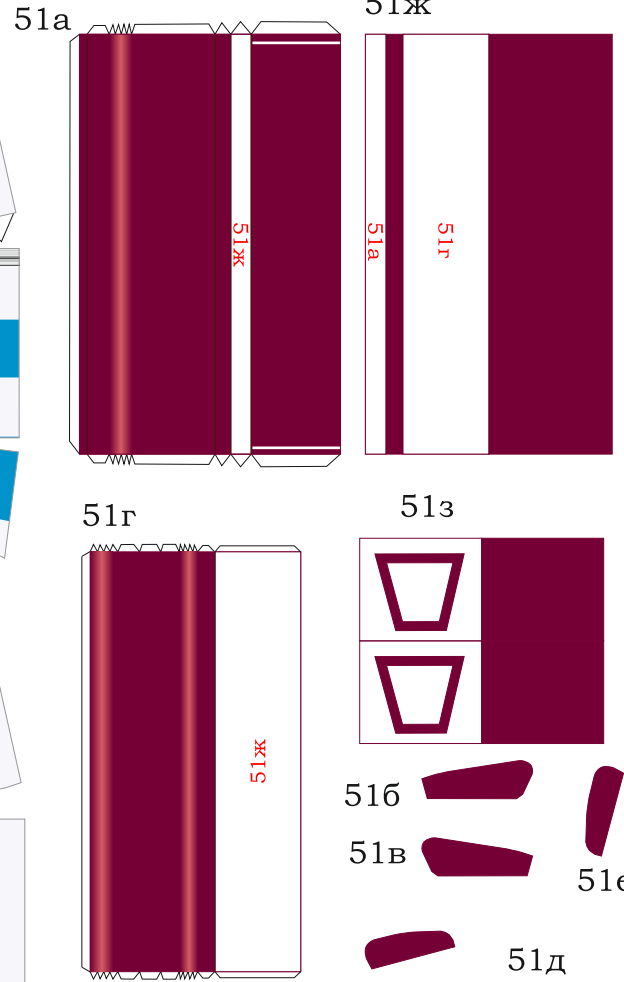
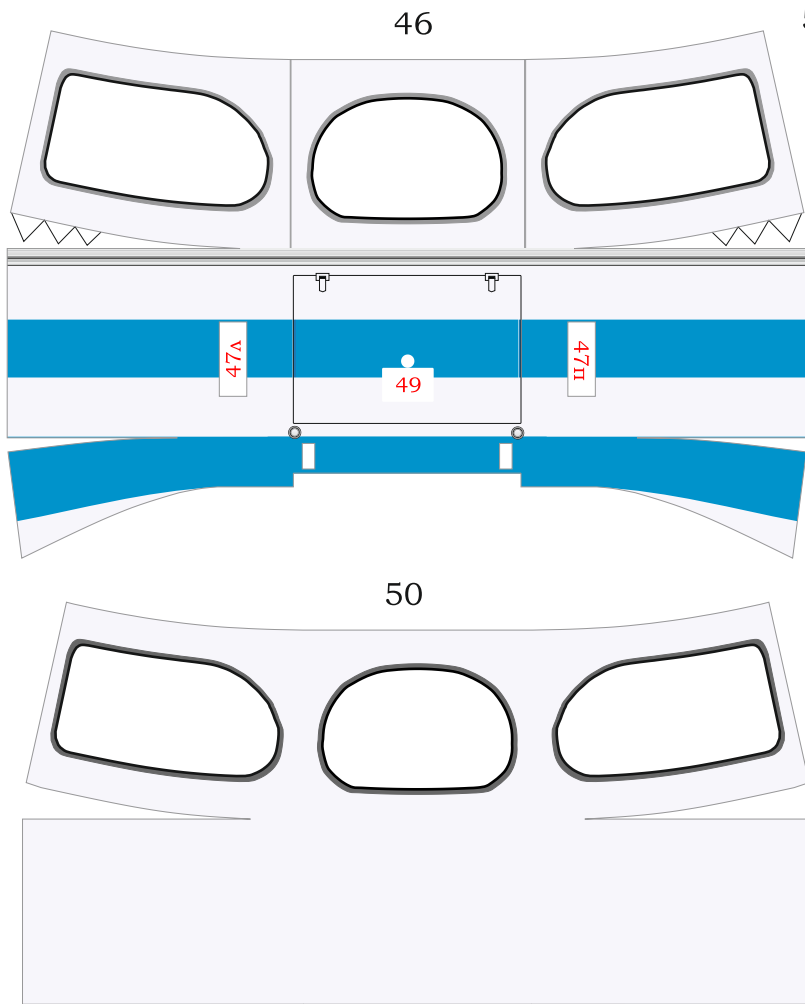

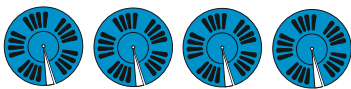
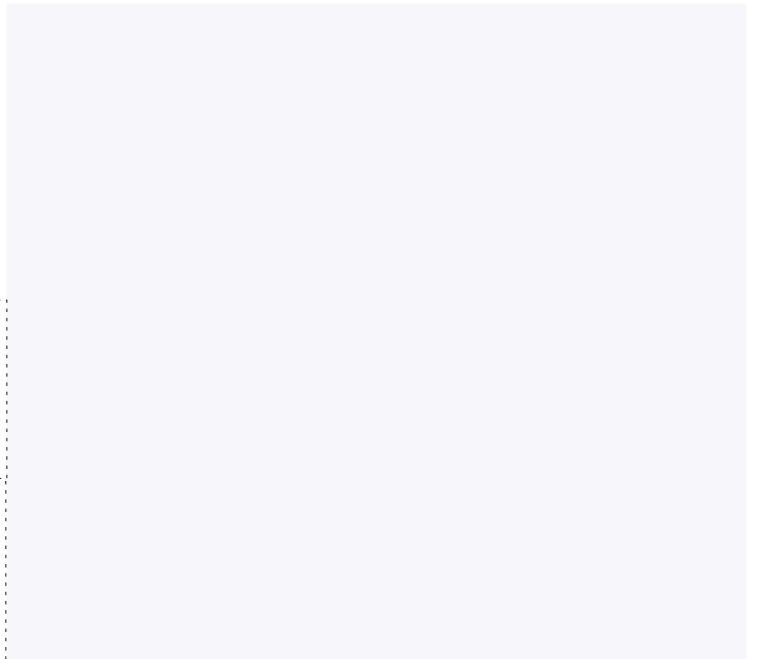
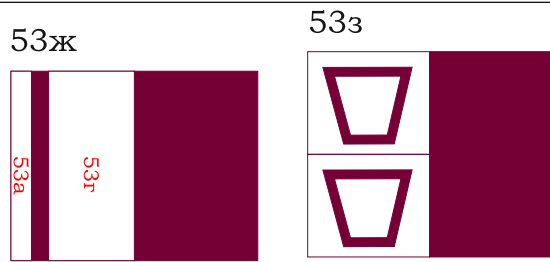
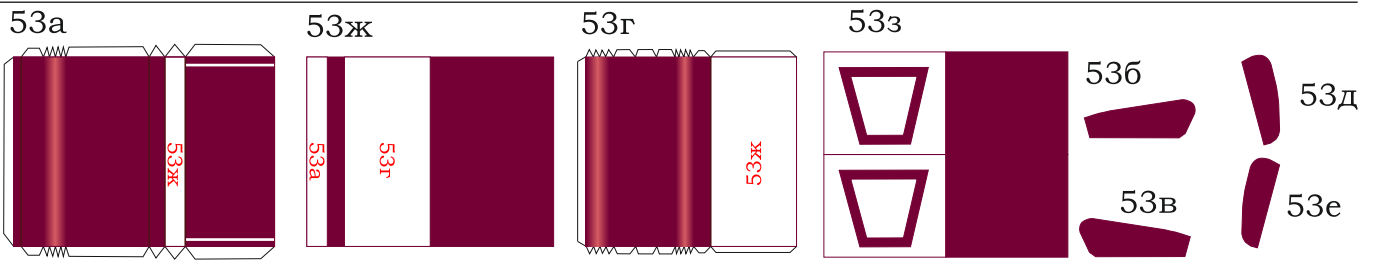
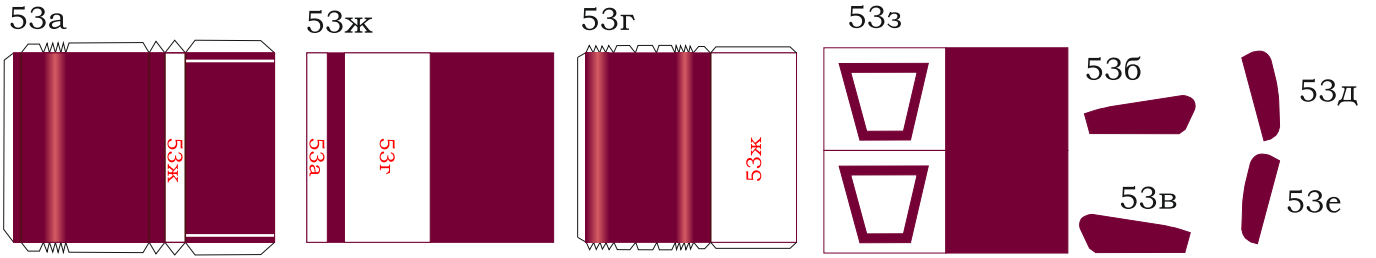
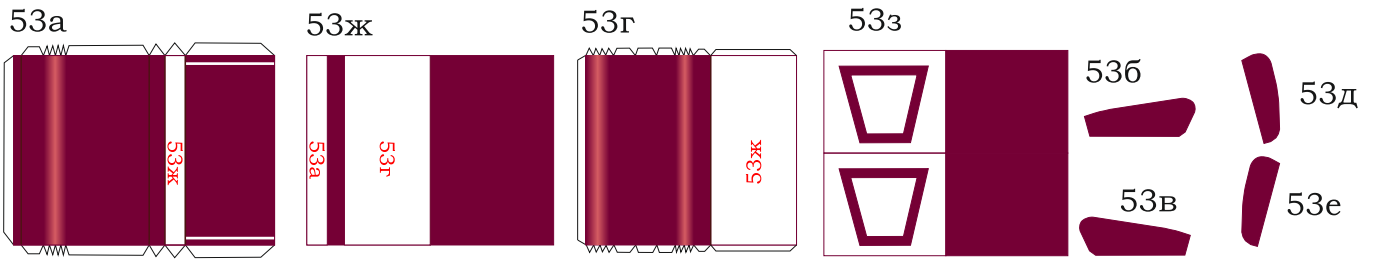

декоративные колпаки колёс



задние 5



передние 5

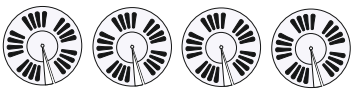

декоративные колпаки колёс

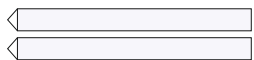

задние 5

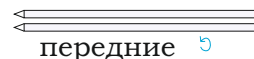

передние 5

