

Santa Claus Christmas wreath: Assembly Instructions

© Canon Inc. © PAOPAO Inc.



PAPER CRAFT

<http://www.canon.com/c-park/en/>



View of completed model

Assembly Instructions: Six US letter sheets (No.1 to No.6)

*Build the model by carefully reading the Assembly Instructions, in the parts sheet page order.

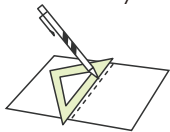

*Hint: Trace along the folds with a ruler and an exhausted pen (no ink) to get a sharper, easier fold.

Assembly Instructions

- | | | | |
|--|---|--|--|
| | Mountain fold(dotted line)
Make a mountain fold. | | Glue spot(Red dot)
Glue parts with the same number together. |
| | Valley fold(dashed and dotted line)
Make a valley fold. | | Glue spot(Green dot)
Glue within the same part. |
| | Scissors line(solid line)
Cut along the line. | | Glue spot(Blue dot)
Glue to the rear of the other part. |
| | Cut in line(solid line)
Cut along the line. | | |

Tools and materials

Scissors, set square, glue(We recommend stick glue), pencil, used ballpoint pen, toothpicks, tweezers, (useful for handling small parts)

Assembly tip

Before gluing, crease the paper along mountain fold and valley fold lines and make sure rounded sections are nice and stiff.

Caution

Glue, scissors and other tools may be dangerous to young children so be sure to keep them out of the reach of young children.

Before starting assembly: Writing the number of each section on its back side before cutting out the sections is highly recommended.
(* This way, you can be sure which section is which even after cutting out the sections.)

- Indicates where sections should be glued together.
- Indicates where to insert sections. Do not glue the sections together.

(1) Build the top of the main piece.

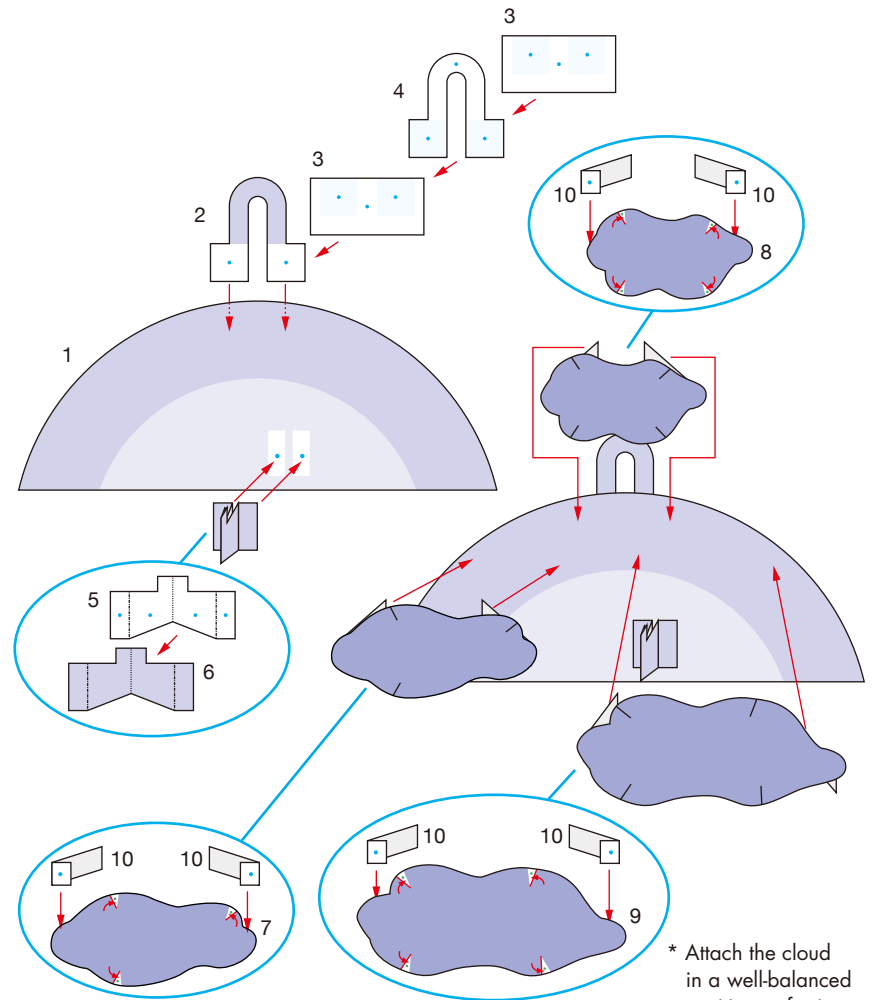

* Attach the cloud in a well-balanced position, referring to the photographs of the completed model.

Santa Claus Christmas wreath: Assembly Instructions

© Canon Inc. © PAOPAO Inc.



(2) Assemble the top and bottom of the main part, then add the cloud.

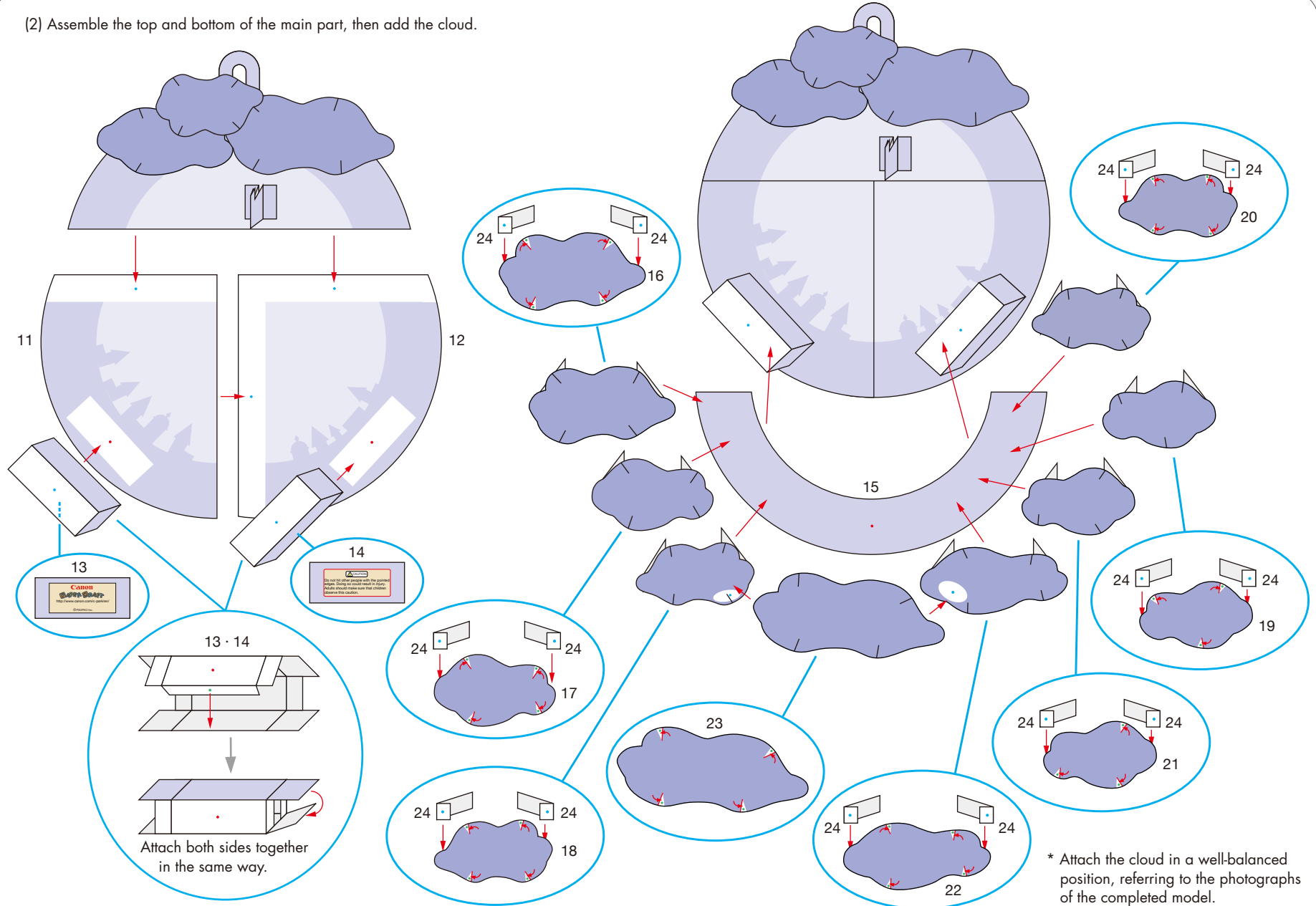

Santa Claus Christmas wreath: Assembly Instructions

© Canon Inc. © PAOPAO Inc.

Canon

(3) Reinforce the rear side of the main part.

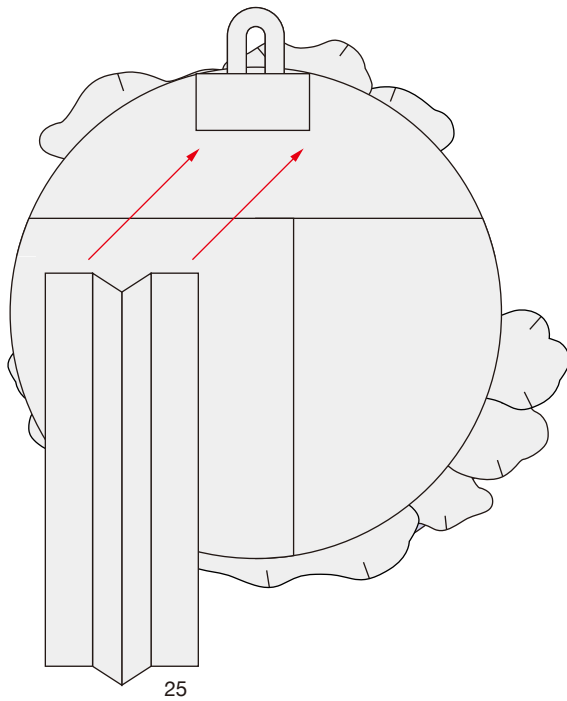

Attach the reinforcement to the middle of the rear side of the main part.

(4) Assemble the reindeer.

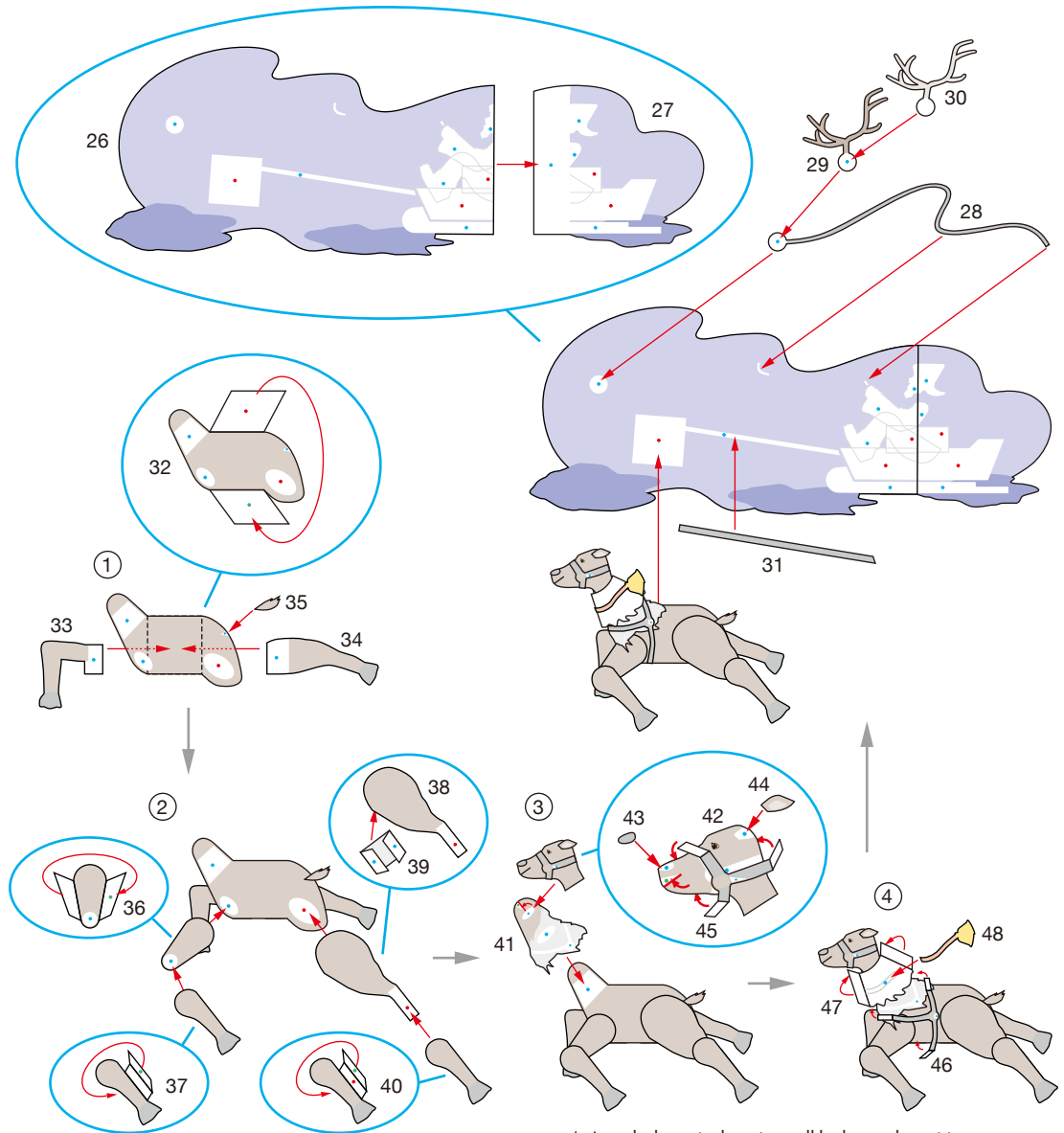

* Attach the reindeer in well-balanced positions, referring to the photographs of the completed model.

Santa Claus Christmas wreath: Assembly Instructions

© Canon Inc. © PAOPAO Inc.



(5) Assemble Santa Claus and his sleigh.

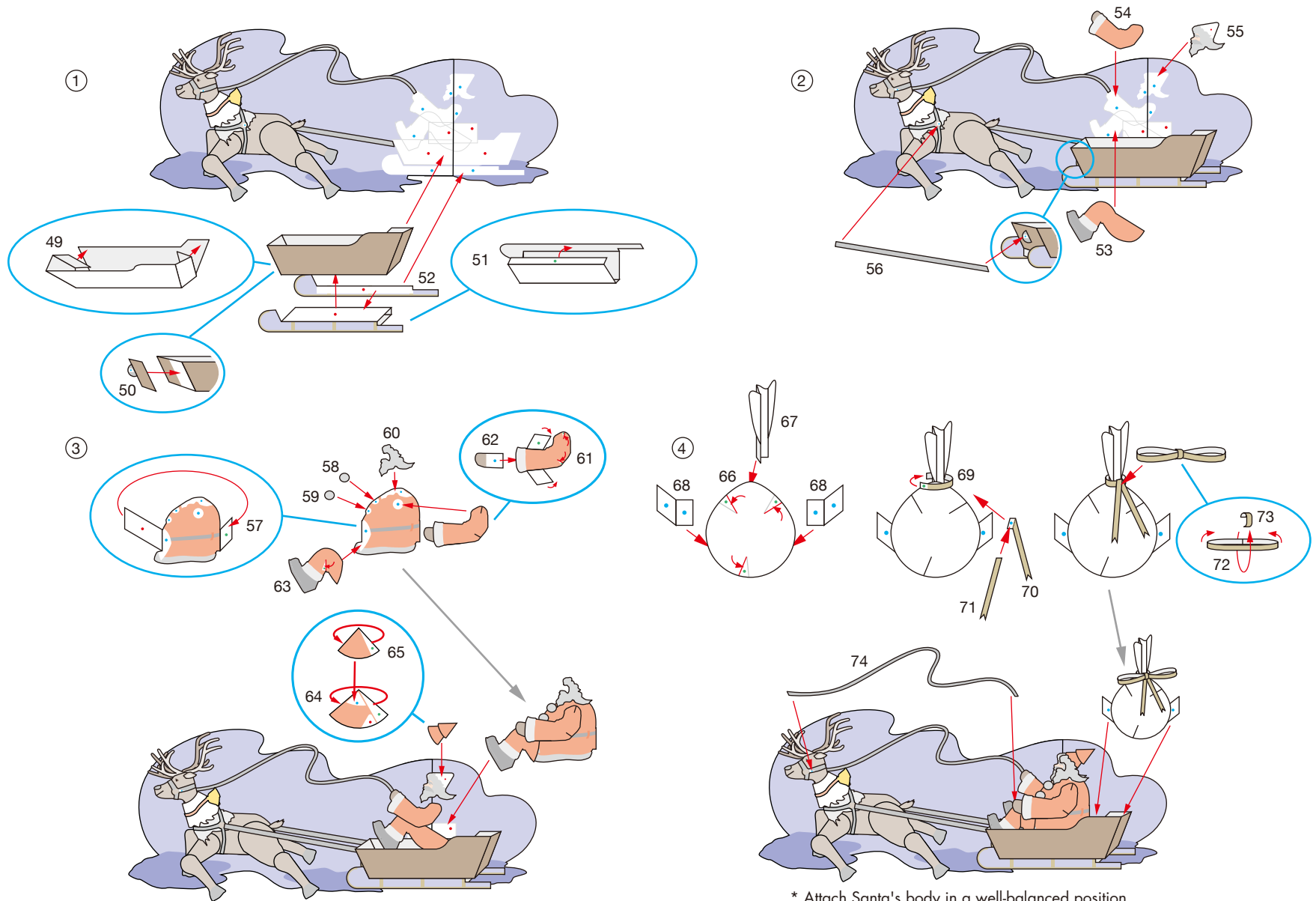

* Attach Santa's body in a well-balanced position, referring to the photographs of the completed model.

Santa Claus Christmas wreath: Assembly Instructions

© Canon Inc. © PAOPAO Inc.



(6) Assemble the boxes of presents and the swing arm.

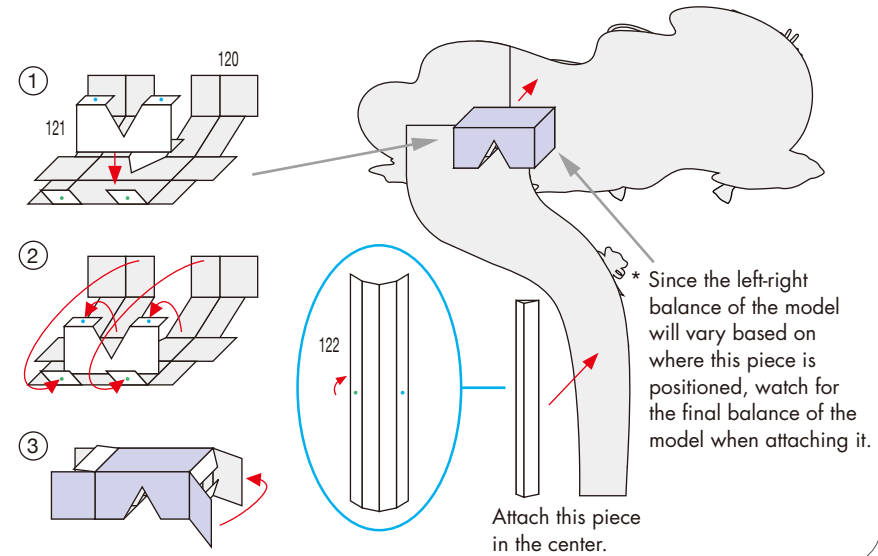
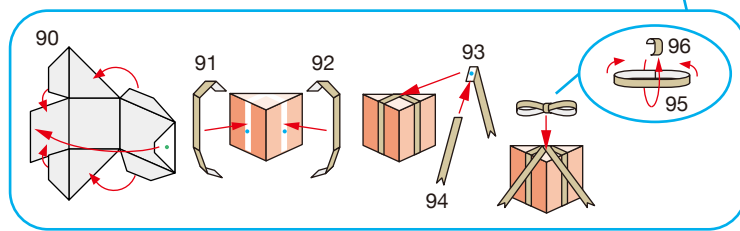
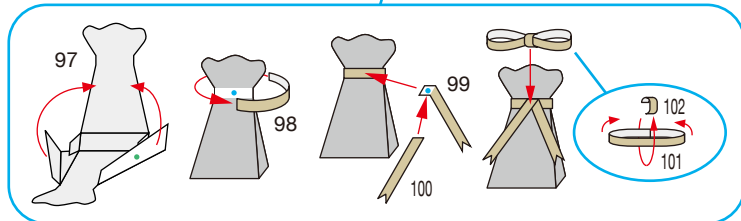
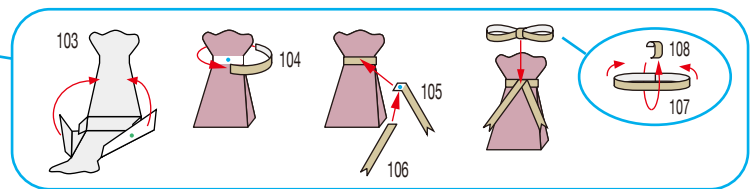
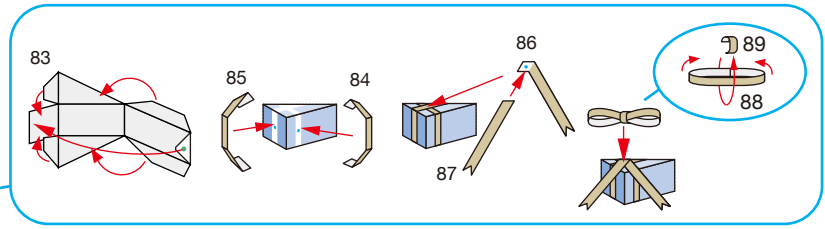
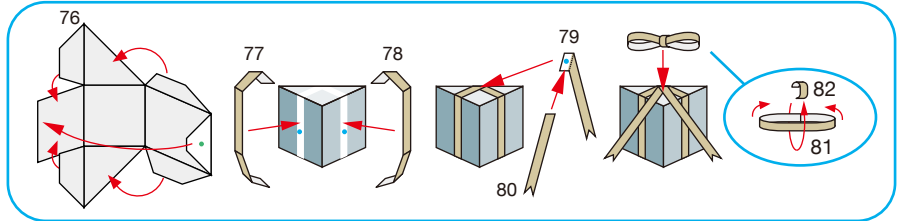
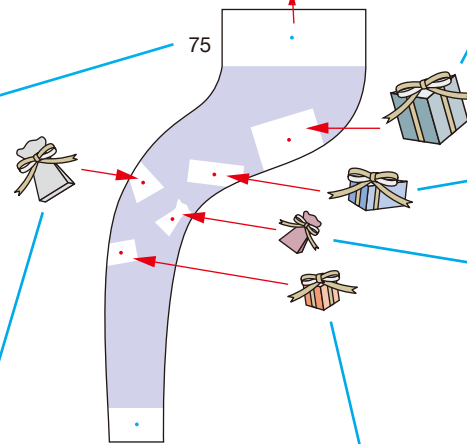
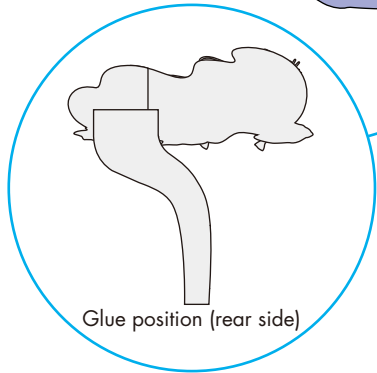
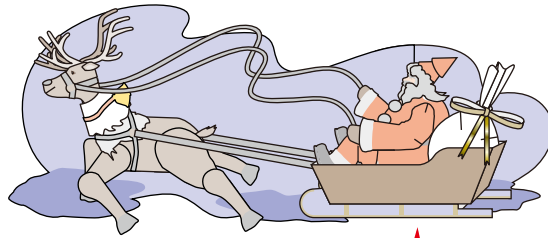

* Carefully curl the ribbons to give your model an even more dynamic and well-built look.

