

# Santa Claus Christmas wreath: Assembly Instructions

© Canon Inc. © PAOPAO Inc.



## PAPER CRAFT

<http://www.canon.com/c-park/en/>



View of completed model

### Assembly Instructions: Six A4 sheets (No.1 to No.6)

\*Build the model by carefully reading the Assembly Instructions, in the parts sheet page order.

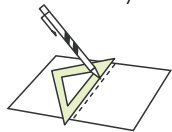

\*Hint: Trace along the folds with a ruler and an exhausted pen (no ink) to get a sharper, easier fold.

### Assembly Instructions



**Mountain fold(dotted line)**  
Make a mountain fold.

**Valley fold(dashed and dotted line)**  
Make a valley fold.

**Scissors line(solid line)**  
Cut along the line.

**Cut in line(solid line)**  
Cut along the line.

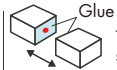

**Glue**  
The glue spot(colored dot) shows where to apply the glue.

**Glue spot(Red dot)**  
Glue parts with the same number together.

**Glue spot(Green dot)**  
Glue within the same part.

**Glue spot(Blue dot)**  
Glue to the rear of the other part.

#### Tools and materials



Scissors, set square, glue(We recommend stick glue), pencil, used ballpoint pen, toothpicks, tweezers, (useful for handling small parts)

#### Assembly tip



Before gluing, crease the paper along mountain fold and valley fold lines and make sure rounded sections are nice and stiff.

#### Caution



Glue, scissors and other tools may be dangerous to young children so be sure to keep them out of the reach of young children.

Before starting assembly: Writing the number of each section on its back side before cutting out the sections is highly recommended.  
(\* This way, you can be sure which section is which even after cutting out the sections.)

→ Indicates where sections should be glued together.  
→ Indicates where to insert sections. Do not glue the sections together.

(1) Build the top of the main piece.

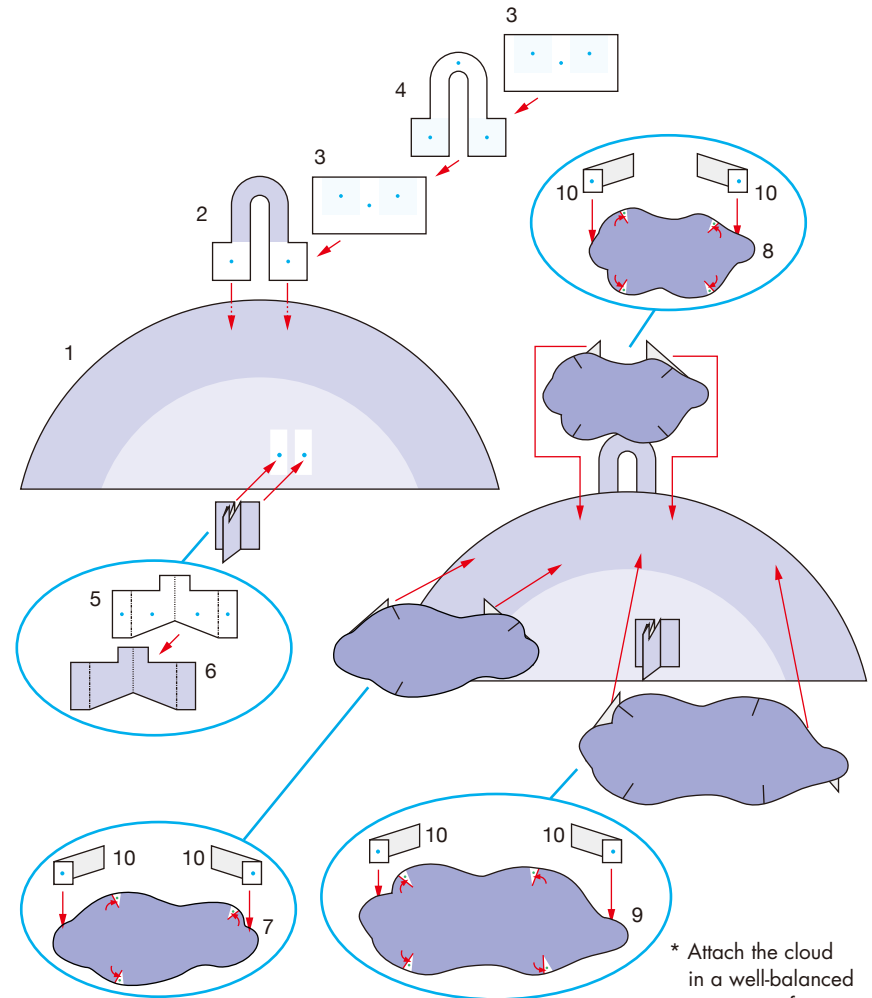

\* Attach the cloud in a well-balanced position, referring to the photographs of the completed model.

# Santa Claus Christmas wreath: Assembly Instructions

© Canon Inc. © PAOPAO Inc.



(2) Assemble the top and bottom of the main part, then add the cloud.

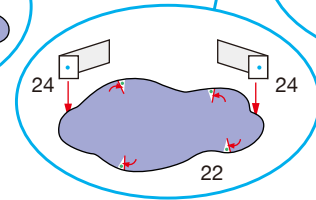
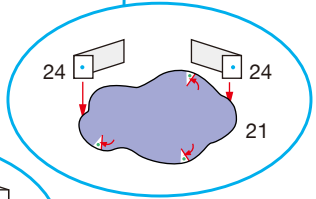
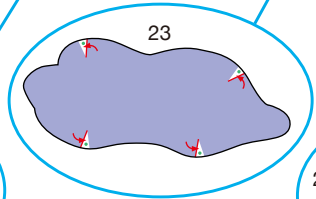
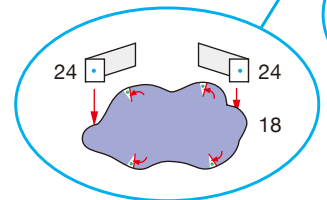
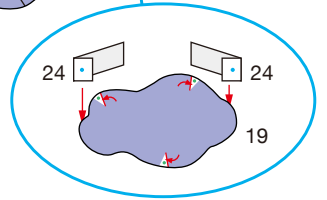
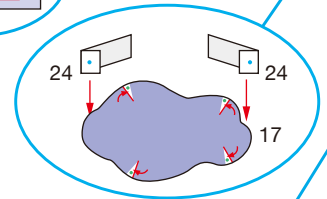
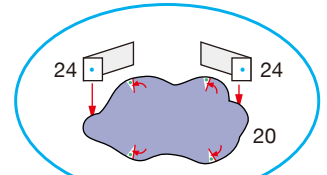
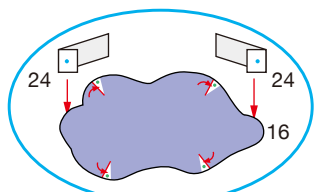
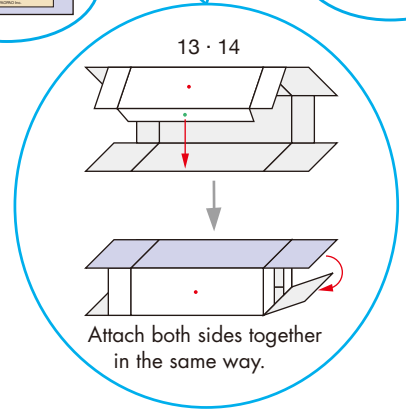
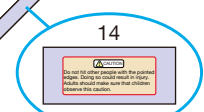
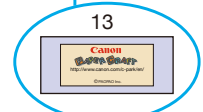
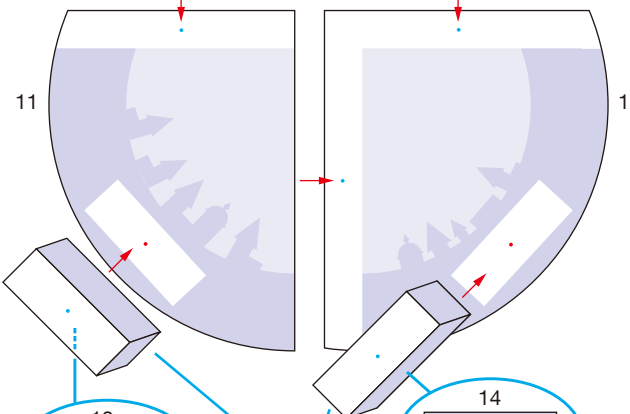
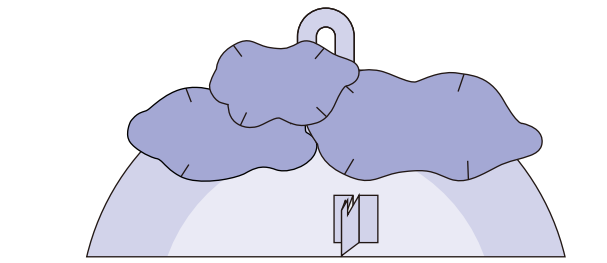
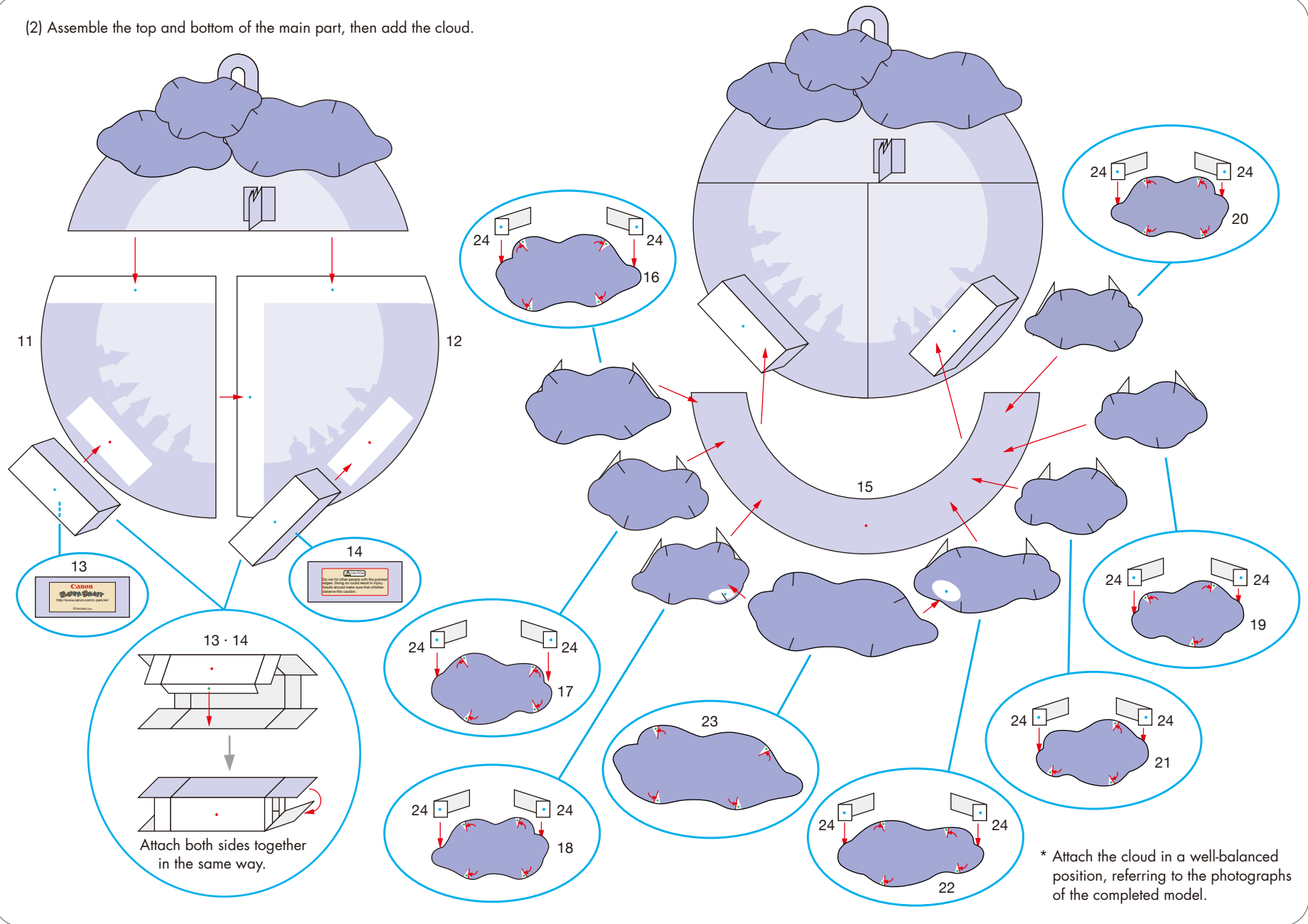

\* Attach the cloud in a well-balanced position, referring to the photographs of the completed model.

# Santa Claus Christmas wreath: Assembly Instructions

(3) Reinforce the rear side of the main part.

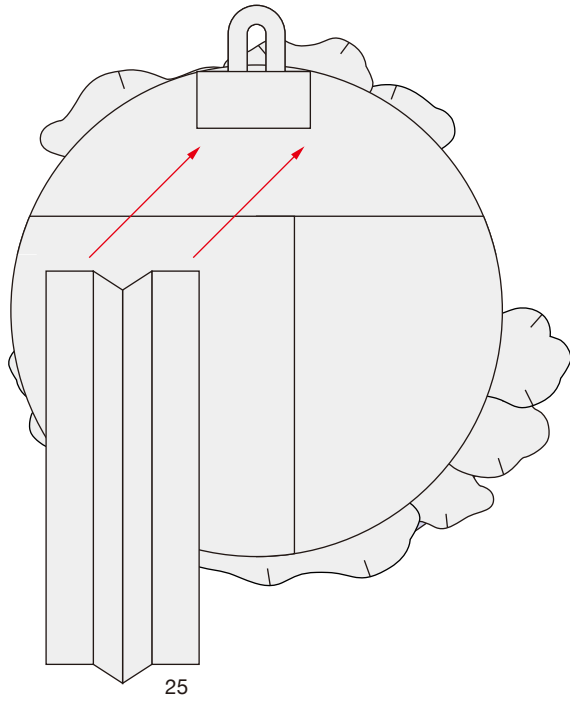

Attach the reinforcement to the middle of the rear side of the main part.

(4) Assemble the reindeer.

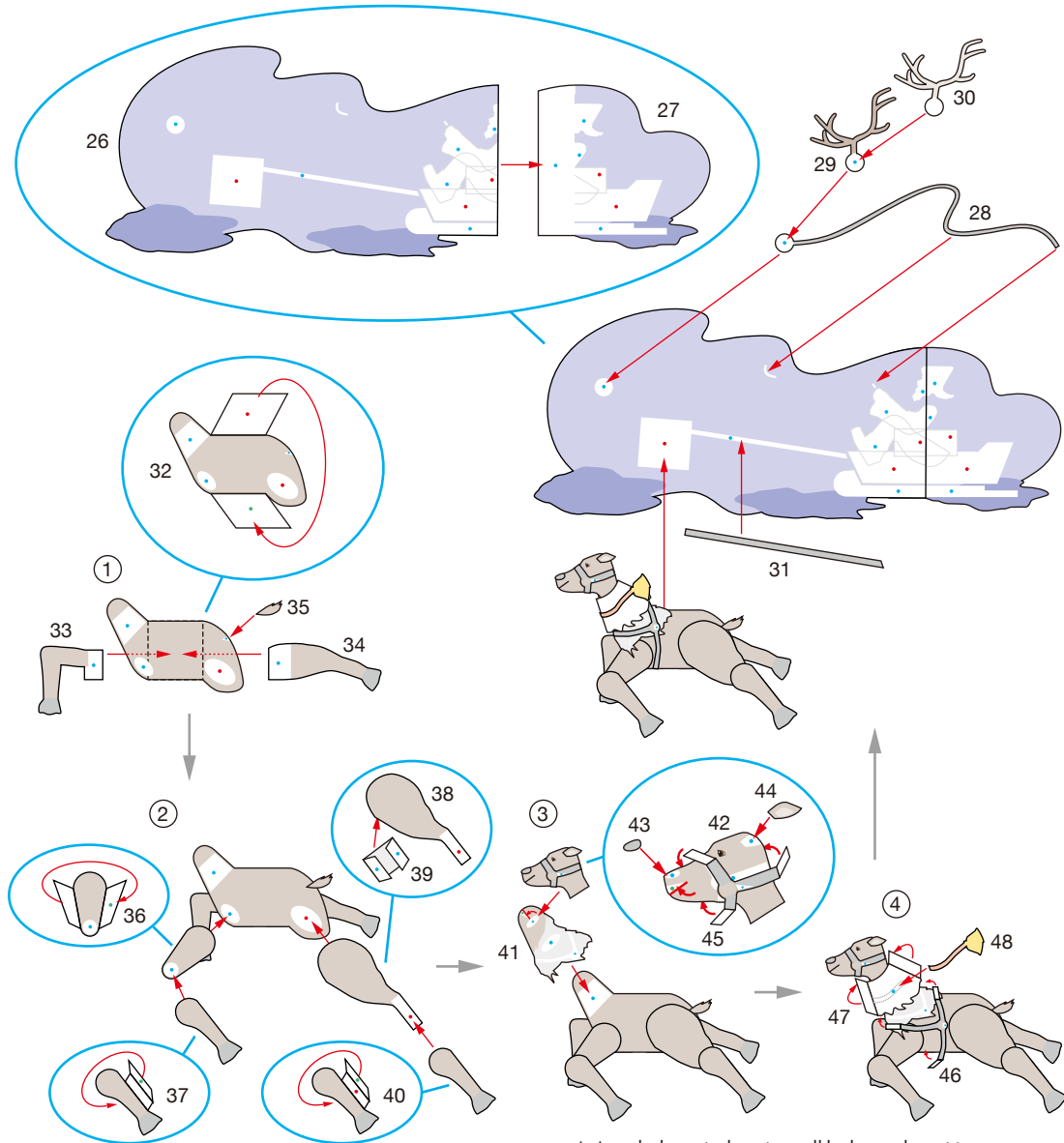

\* Attach the reindeer in well-balanced positions, referring to the photographs of the completed model.

# Santa Claus Christmas wreath: Assembly Instructions

© Canon Inc. © PAOPAO Inc.



(5) Assemble Santa Claus and his sleigh.

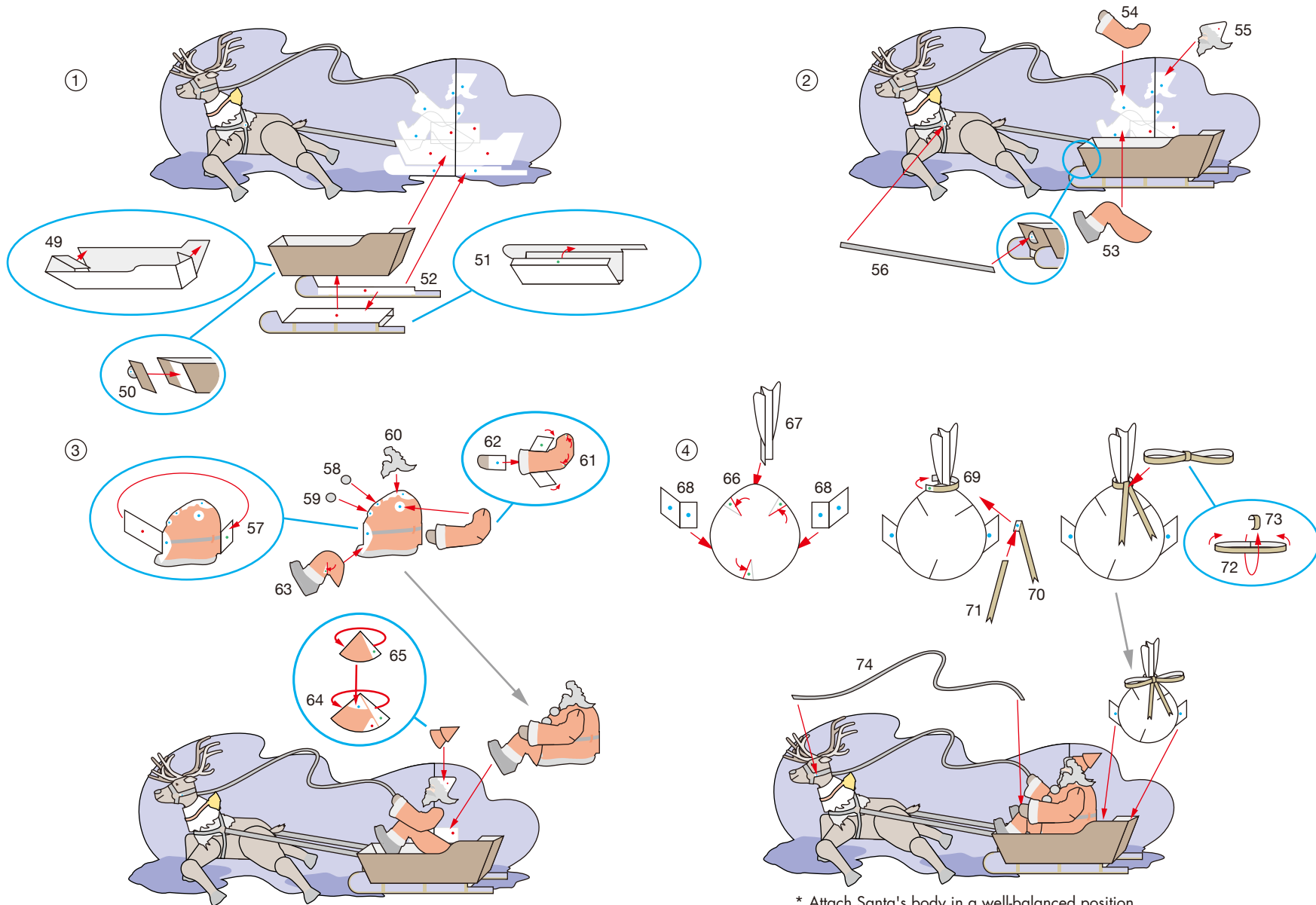

# Santa Claus Christmas wreath: Assembly Instructions

© Canon Inc. © PAOPAO Inc.



(6) Assemble the boxes of presents and the swing arm.

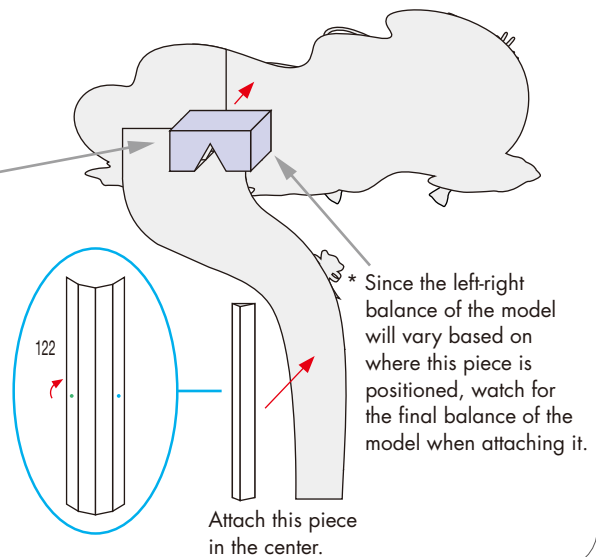
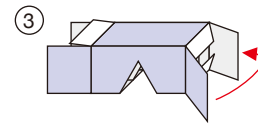
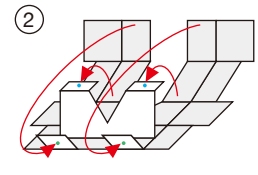
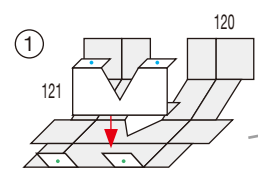
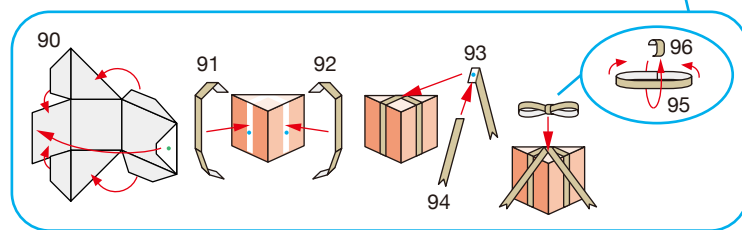
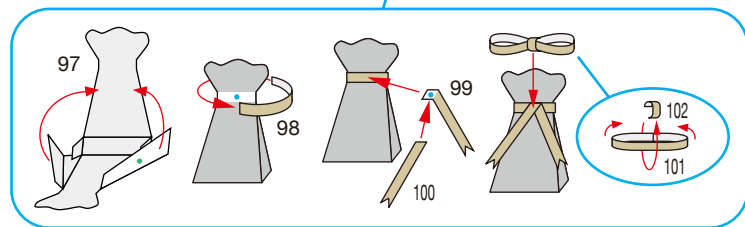
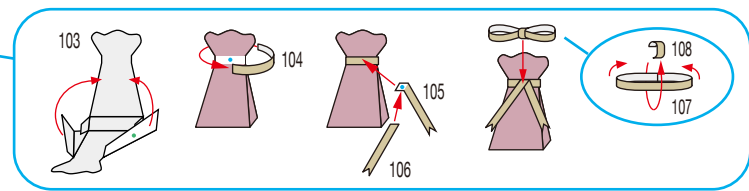
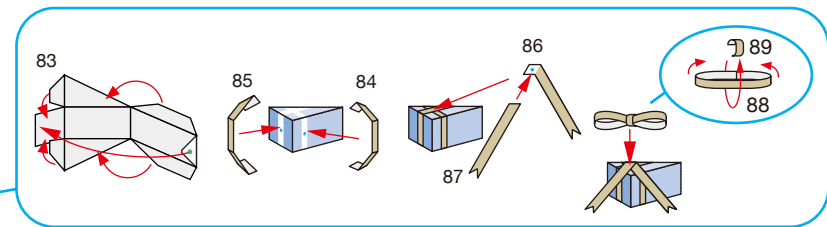
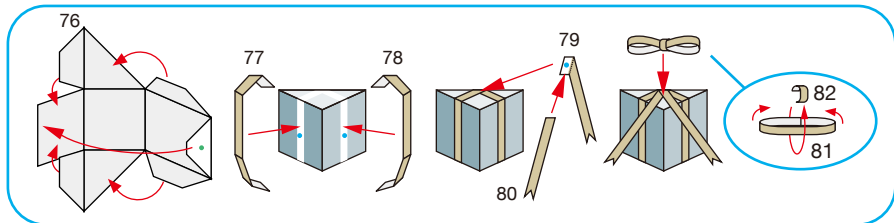
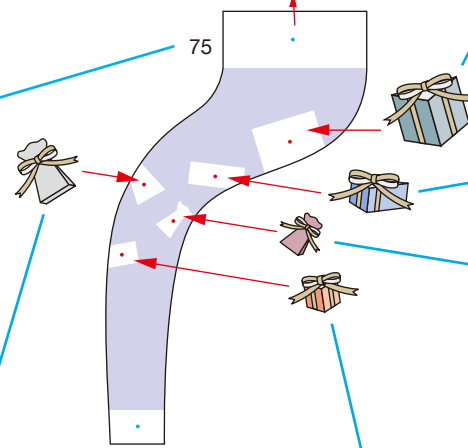
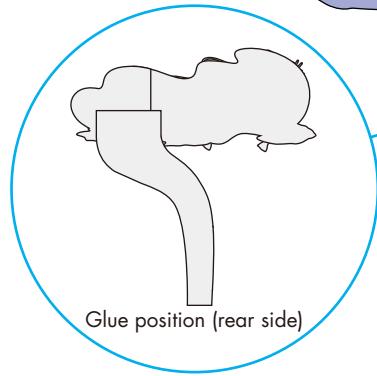
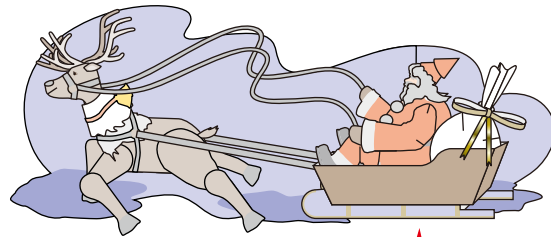

\* Carefully curl the ribbons to give your model an even more dynamic and well-built look.

# Santa Claus Christmas wreath: Assembly Instructions

© Canon Inc. © PAOPAO Inc.



(7) Attach the swing arm to the main piece, then assemble the holly leaves and the bells.

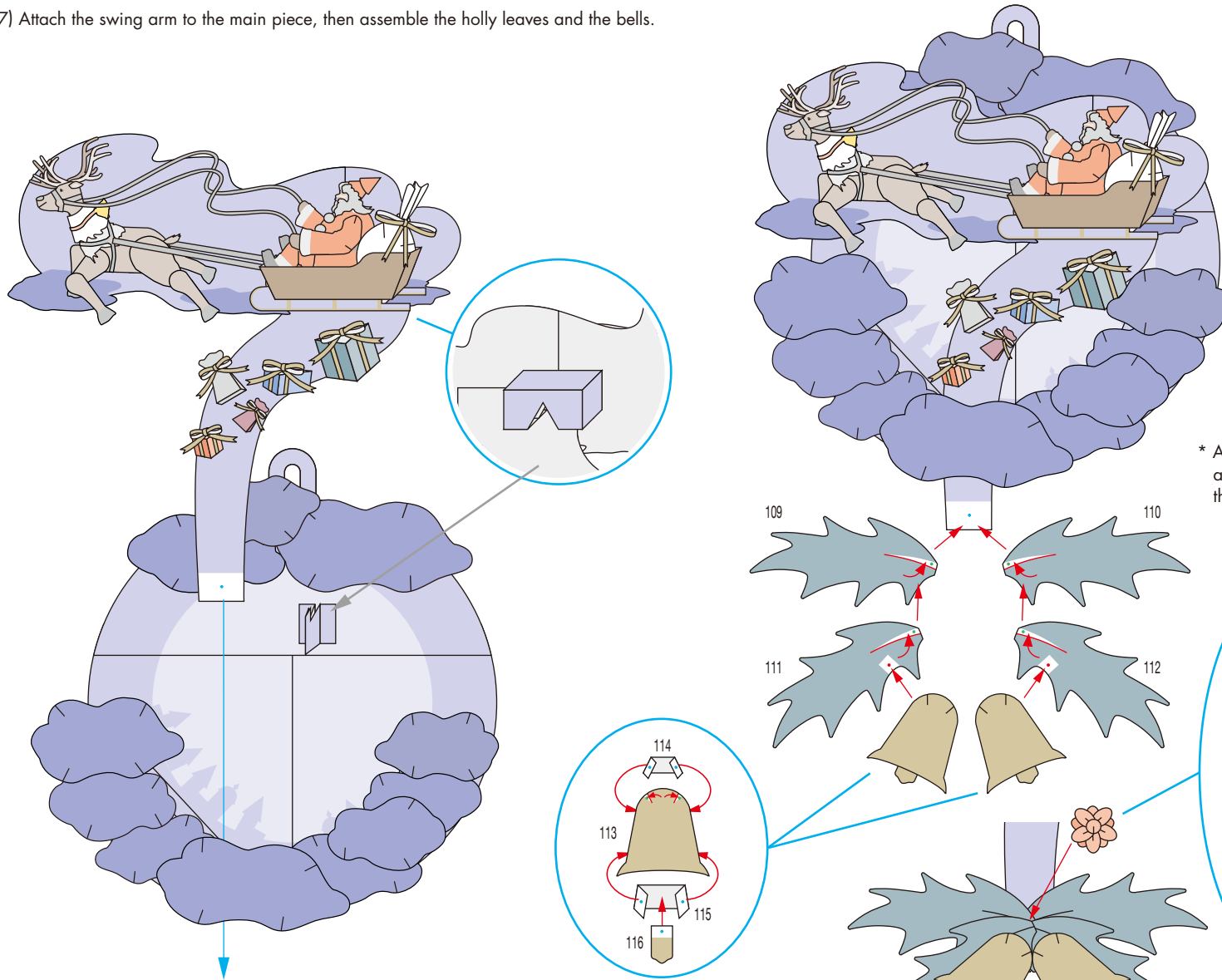

\* Attach the holly leaves, the bells, and the berries while monitoring the overall balance of the model.

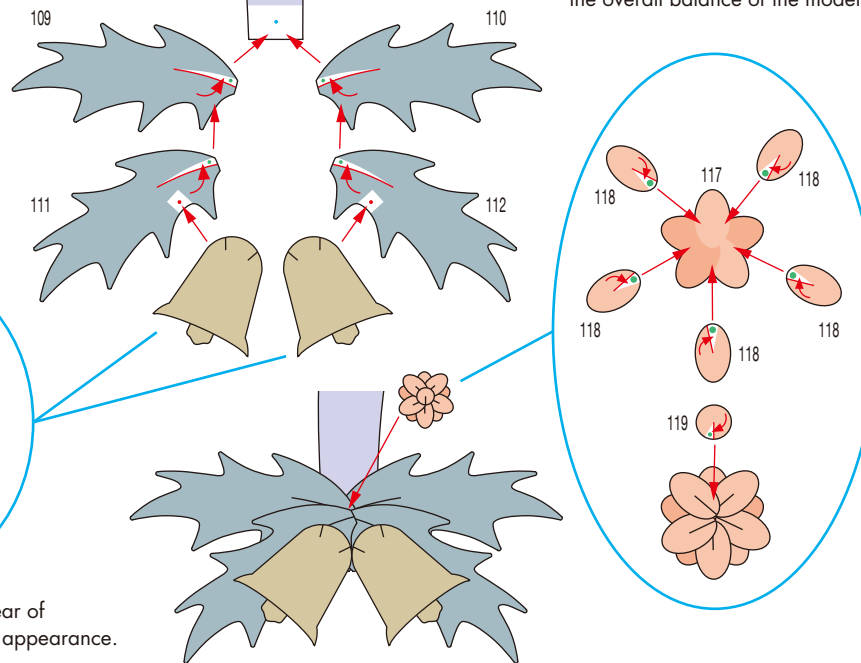

Attach these parts to the rear of the bell to give it a curved appearance.