

Ivy Christmas wreath (pop style): Assembly Instructions

© Canon Inc. © PAOPAO Inc.



PAPER CRAFT

<http://www.canon.com/c-park/en/>



View of completed model

Assembly Instructions: Three A4 sheets (No.1 to No.3)

*Build the model by carefully reading the Assembly Instructions, in the parts sheet page order.

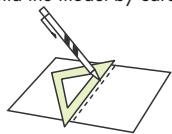

*Hint: Trace along the folds with a ruler and an exhausted pen (no ink) to get a sharper, easier fold.

Assembly Instructions



Mountain fold(dotted line)
Make a mountain fold.

Valley fold(dashed and dotted line)
Make a valley fold.

Scissors line(solid line)
Cut along the line.

Cut in line(solid line)
Cut along the line.

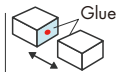

Glue
The glue spot(colored dot) shows where to apply the glue.

Glue spot(Red dot)
Glue parts with the same number together.

Glue spot(Green dot)
Glue within the same part.

Glue spot(Blue dot)
Glue to the rear of the other part.

Tools and materials



Scissors, set square, glue(We recommend stick glue), pencil, used ballpoint pen, toothpicks, tweezers, (useful for handling small parts)

Assembly tip



Before gluing, crease the paper along mountain fold and valley fold lines and make sure rounded sections are nice and stiff.

Caution



Glue, scissors and other tools may be dangerous to young children so be sure to keep them out of the reach of young children.

Before starting assembly: Writing the number of each section on its back side before cutting out the sections is highly recommended. (* This way, you can be sure which section is which even after cutting out the sections.)

- Indicates where sections should be glued together.
- Indicates where to insert sections.
- Indicates the next step.
- Indicates sections that should be glued first, then cut out.

Main body

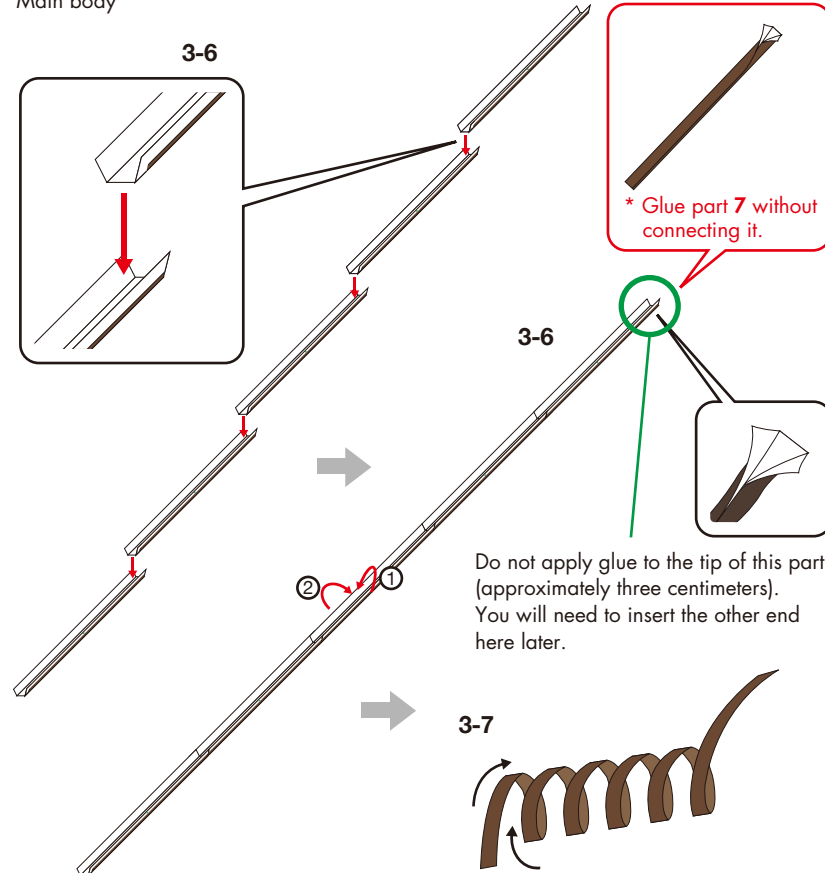

* You can curl this part easily by wrapping it around a rod-shaped item (for example, a pencil).
* Wrap tightly, then let it stretch out.

- * For parts 3 - 5, build 12 rods by connecting five pieces with the corresponding numbers.
- * For part 6, build two rods by connecting five pieces.
- * For part 7, build six rods by gluing each piece individually, without connecting the pieces to each other.

Ivy Christmas wreath (pop style): Assembly Instructions

Main body (continued)

3-6

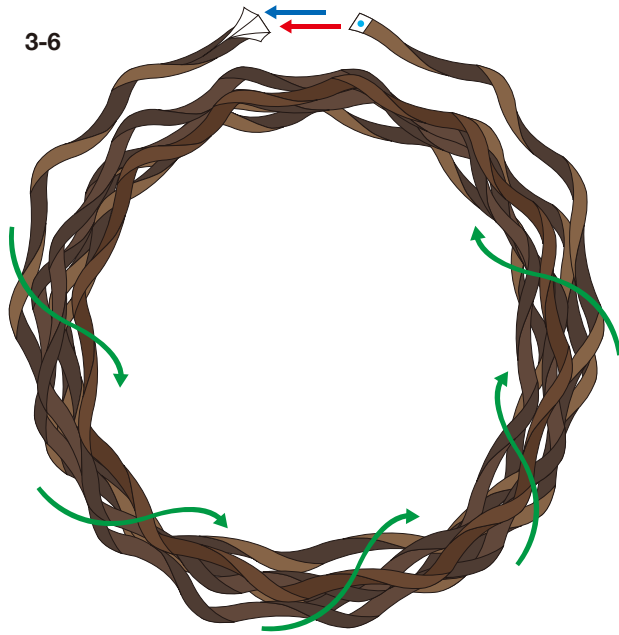

7

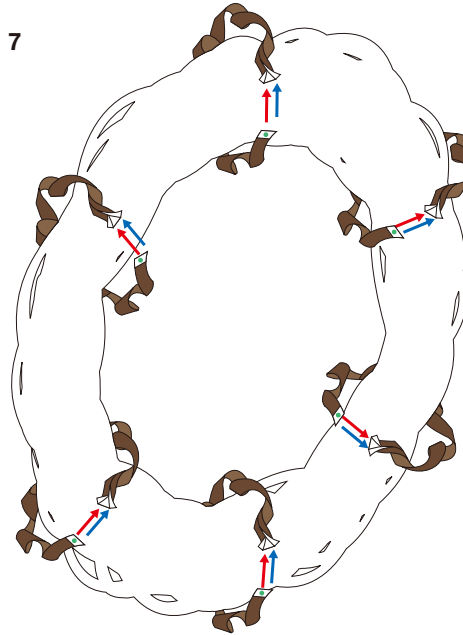

- * Start by constructing just one ring, then wrap the other rings around the first.
- * Although rings 3 - 5 may be wrapped in any order, wrap ring 6 last, as shown above.
- * Since too much wrapping at the end can make a ring too short, avoid excessive wrapping of the rings at the end.

Star

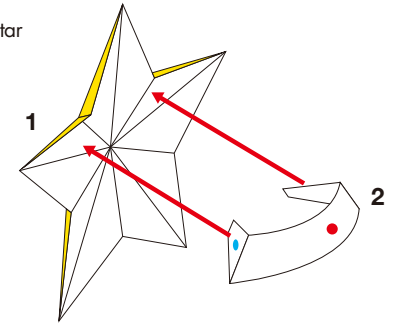

Berries

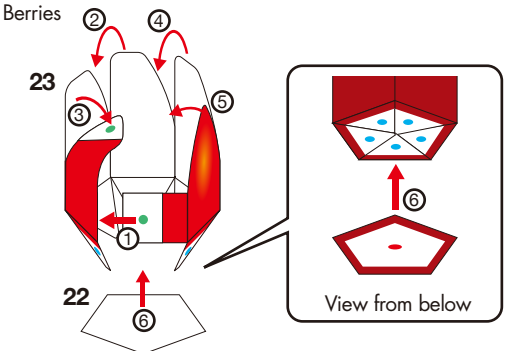

- * Glue after folding to give the berry a rounded shape.
- * Build the different-colored berry parts in the same way.

Message plate

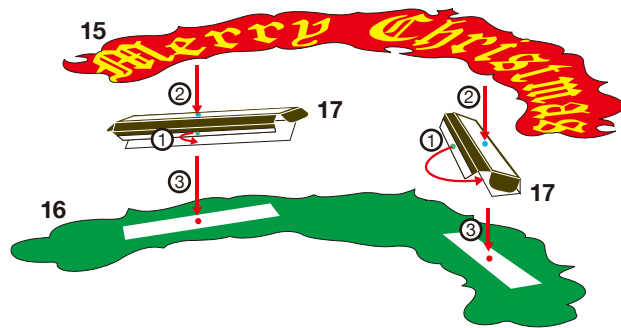

Holly leaves

18-21

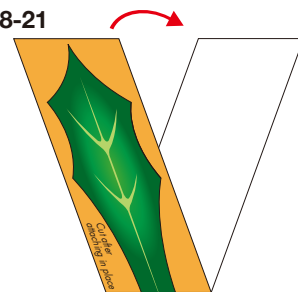

- * After gluing, cut and make indentations along the inside cut and indentation lines.

18-21



- * Cross these parts before gluing to make the leaves curve inward.

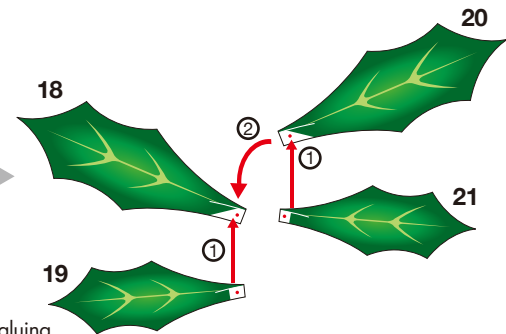

Ivy Christmas wreath (pop style): Assembly Instructions

© Canon Inc. © PAOPAO Inc.



Present

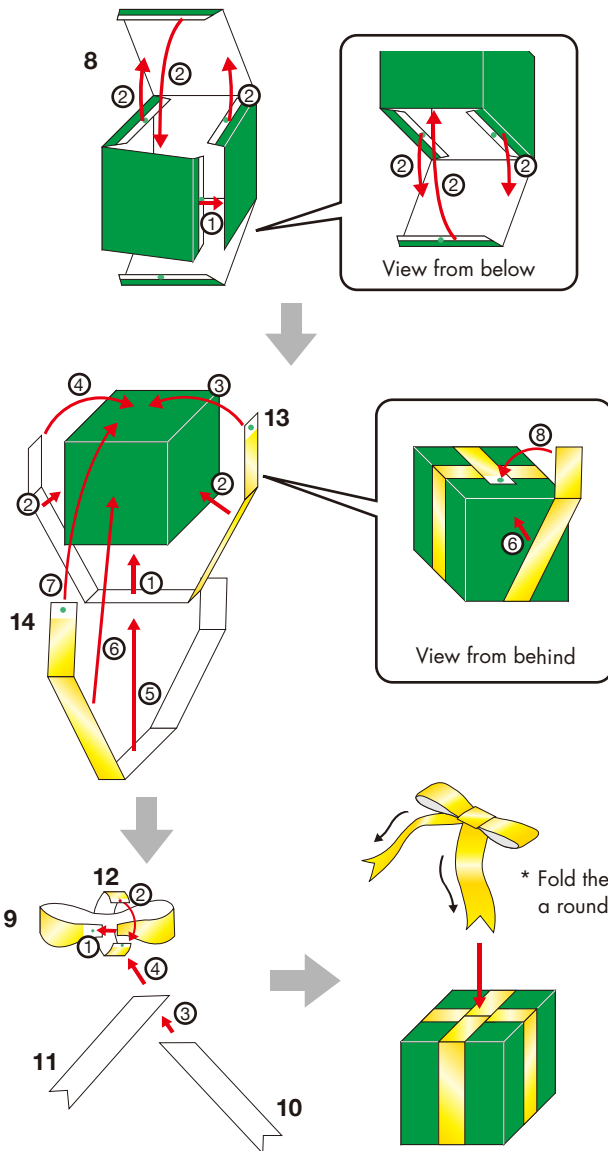

* Build the different-colored present parts in the same way.

Finishing

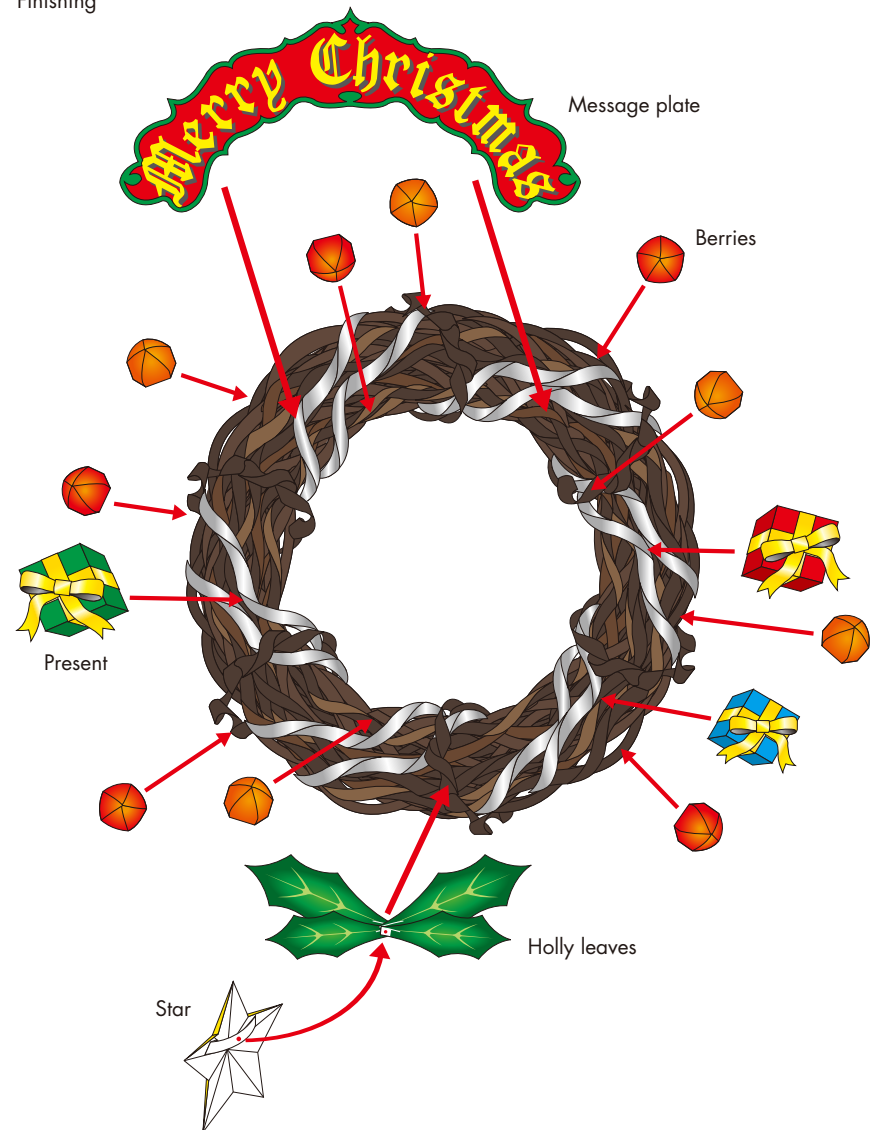

* Finish the wreath by attaching the rear (or bottom) of each part to the flat surfaces of the main part (3 - 7), maintaining a good balance by referring to the photographs of the completed model. (We recommend attaching the star and holly leaves parts to part 7 of the main body.)