

Ivy Christmas wreath (classic style): Assembly Instructions

© Canon Inc. © PAOPAO Inc.



Main body (continued)

3-5

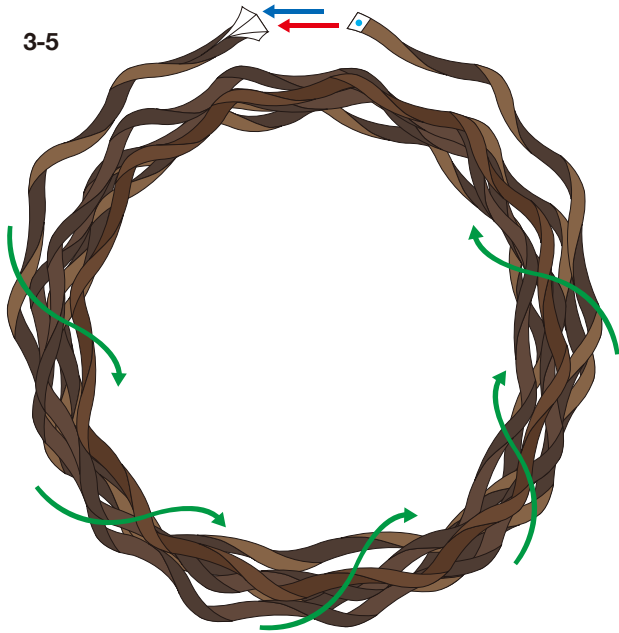

6

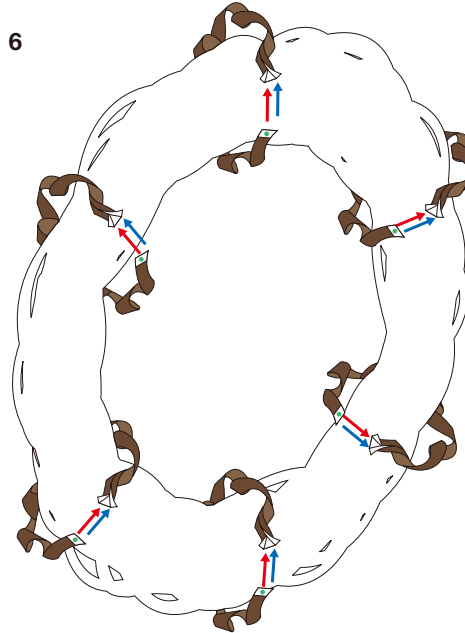

- * Start by construction just one ring, then wrap the other rings around the first.
- * Wrap the rings in any order, regardless of part number.
- * Since too much wrapping at the end can make a ring too short, avoid excessive wrapping of the rings at the end.

Star

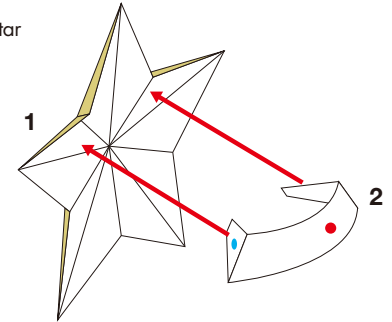

Berries

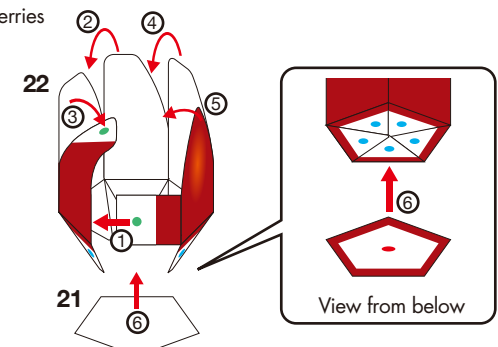

- * Glue after folding to give the berry a rounded shape.
- * Build the different-colored berry parts in the same way.

Message plate

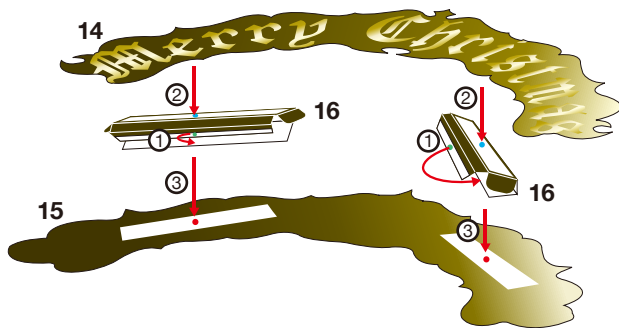

Holly leaves

17-20

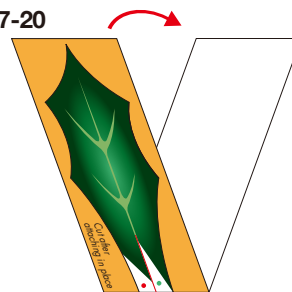

- * After gluing, cut and make indentations along the inside cut and indentation lines.

17-20



- * Cross these parts before gluing to make the leaves curve inward.

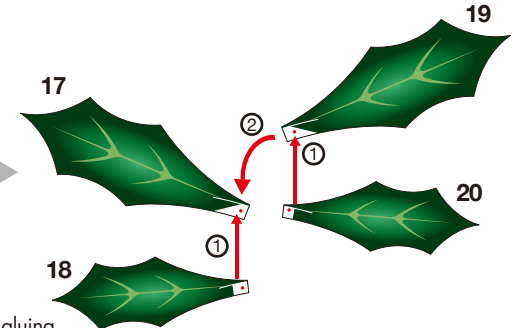

Ivy Christmas wreath (classic style): Assembly Instructions

© Canon Inc. © PAOPAO Inc.



Present

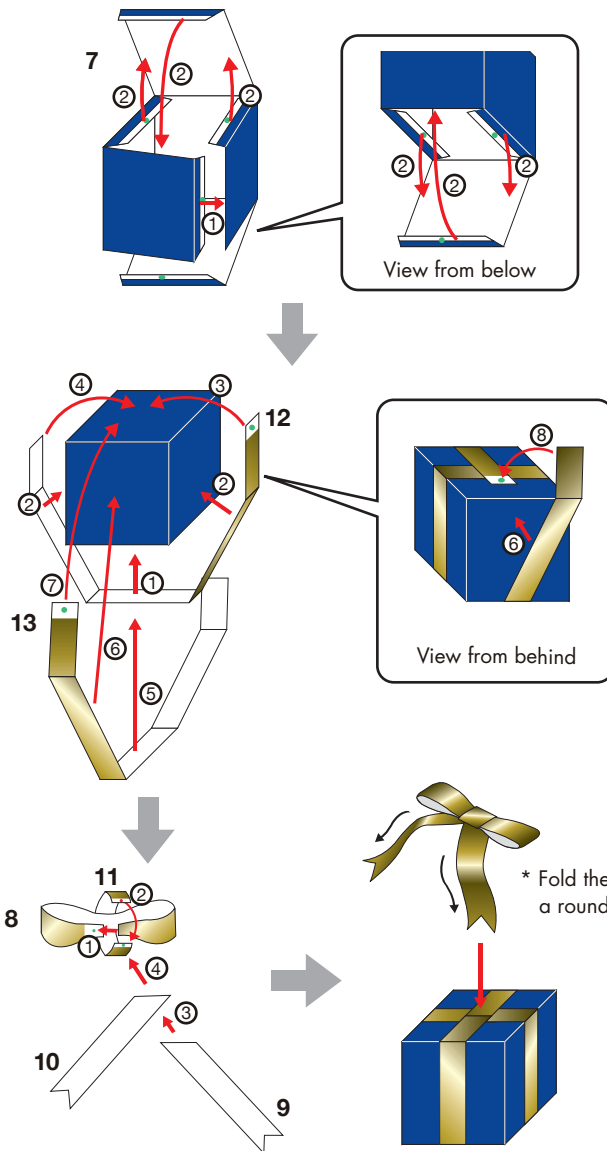

* Build the different-colored present parts in the same way.

Finishing

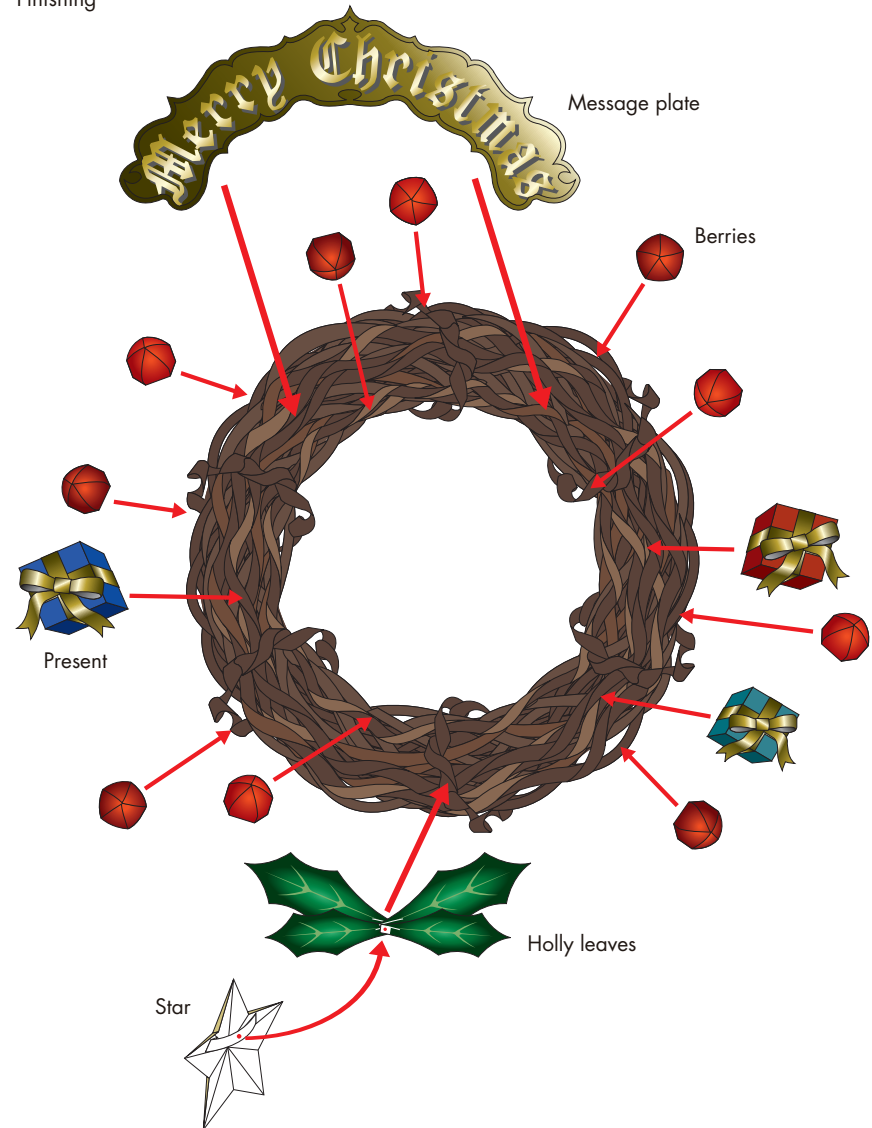

* Finish the wreath by attaching the rear (or bottom) of each part to the flat surfaces of the main part (3 - 7), maintaining a good balance by referring to the photographs of the completed model. (We recommend attaching the star and holly leaves parts to part 7 of the main body.)