

# Ivy Christmas wreath (classic style): Assembly Instructions

© Canon Inc. © PAOPAO Inc.



## PAPER CRAFT

<http://www.canon.com/c-park/en/>



View of completed model

### Assembly Instructions: Three A4 sheets (No.1 to No.3)

\*Build the model by carefully reading the Assembly Instructions, in the parts sheet page order.

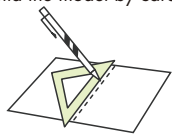

\*Hint: Trace along the folds with a ruler and an exhausted pen (no ink) to get a sharper, easier fold.

### Assembly Instructions



**Mountain fold(dotted line)**  
Make a mountain fold.

**Valley fold(dashed and dotted line)**  
Make a valley fold.

**Scissors line(solid line)**  
Cut along the line.

**Cut in line(solid line)**  
Cut along the line.

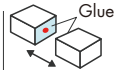

Glue  
The glue spot(colored dot) shows where to apply the glue.

**Red dot**  
Glue parts with the same number together.

**Green dot**  
Glue within the same part.

**Blue dot**  
Glue to the rear of the other part.

#### Tools and materials



Scissors, set square, glue(We recommend stick glue), pencil, used ballpoint pen, toothpicks, tweezers, (useful for handling small parts)

#### Assembly tip



Before gluing, crease the paper along mountain fold and valley fold lines and make sure rounded sections are nice and stiff.

#### Caution



Glue, scissors and other tools may be dangerous to young children so be sure to keep them out of the reach of young children.

Before starting assembly: Writing the number of each section on its back side before cutting out the sections is highly recommended. (\* This way, you can be sure which section is which even after cutting out the sections.)

- Indicates where sections should be glued together.
- Indicates where to insert sections.
- Indicates the next step.
- Indicates sections that should be glued first, then cut out.

### Main body

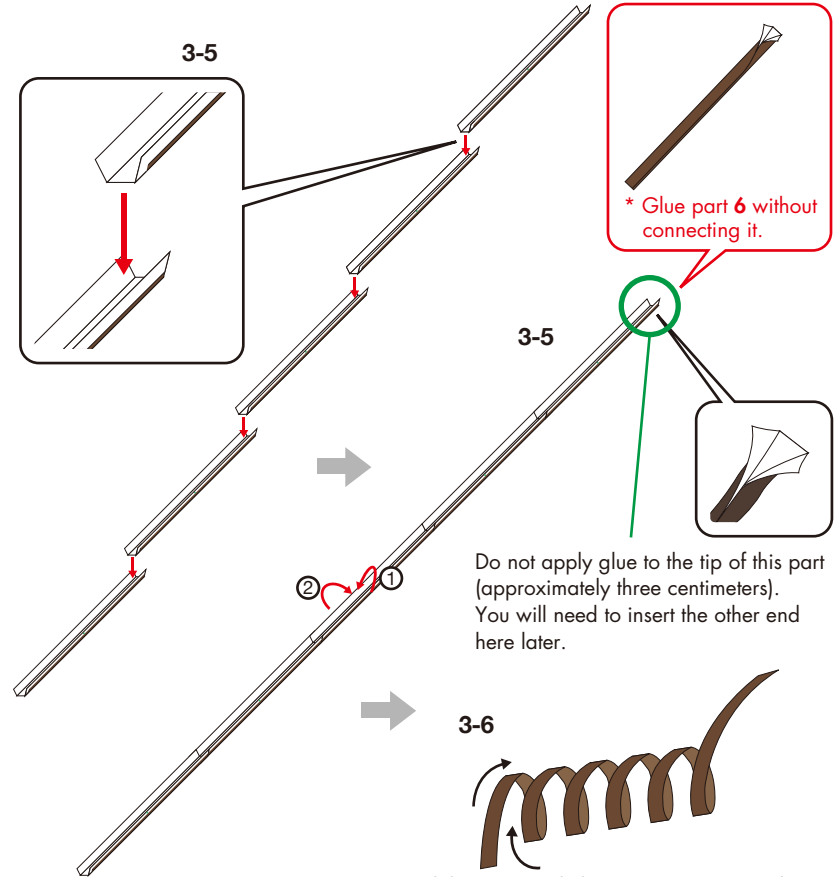

Do not apply glue to the tip of this part (approximately three centimeters). You will need to insert the other end here later.

- \* You can curl this part easily by wrapping it around a rod-shaped item (for example, a pencil).
- \* Wrap tightly, then let it stretch out.

\* For parts 3 - 5, build 14 rods by connecting five pieces to the corresponding numbers.

\* For part 6, build six rods by gluing each piece individually, without connecting the pieces to each other.

# Ivy Christmas wreath (classic style): Assembly Instructions

Main body (continued)

3-5

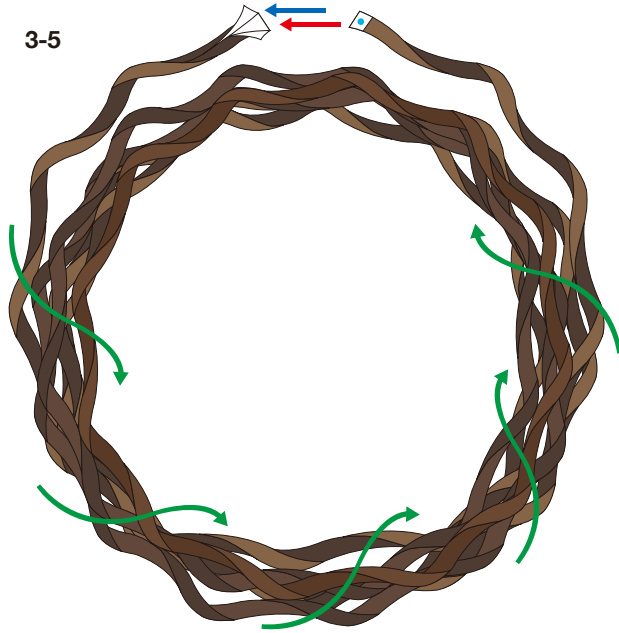

6

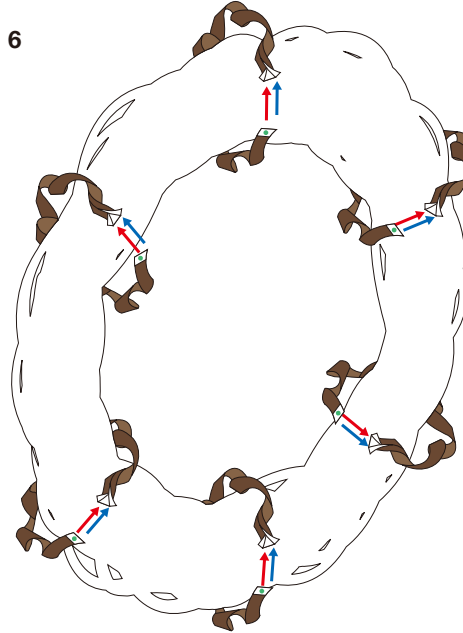

- \* Start by construction just one ring, then wrap the other rings around the first.
- \* Wrap the rings in any order, regardless of part number.
- \* Since too much wrapping at the end can make a ring too short, avoid excessive wrapping of the rings at the end.

Message plate

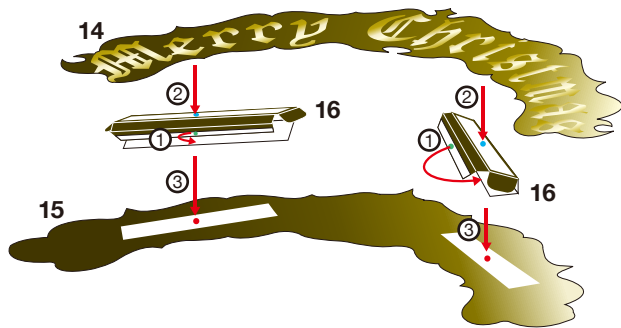

Holly leaves

17-20

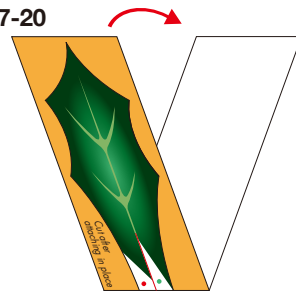

- \* After gluing, cut and make indentations along the inside cut and indentation lines.

17-20

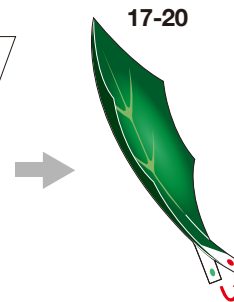

- \* Cross these parts before gluing to make the leaves curve inward.

Star

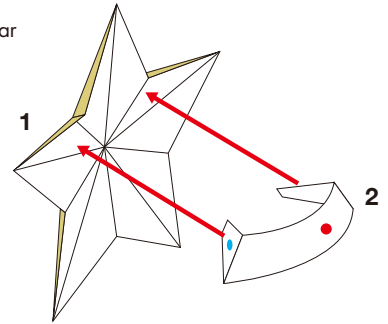

Berries

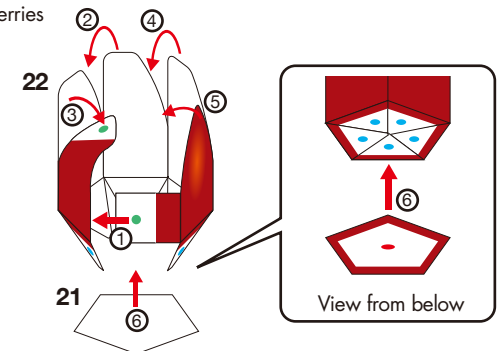

- \* Glue after folding to give the berry a rounded shape.
- \* Build the different-colored berry parts in the same way.

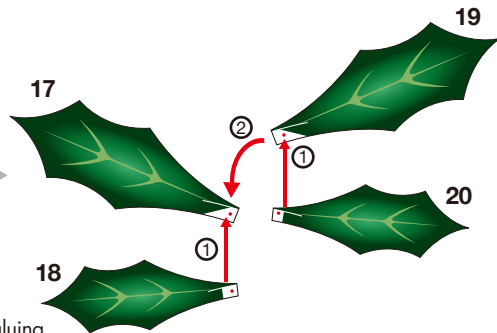

# Ivy Christmas wreath (classic style): Assembly Instructions

## Present

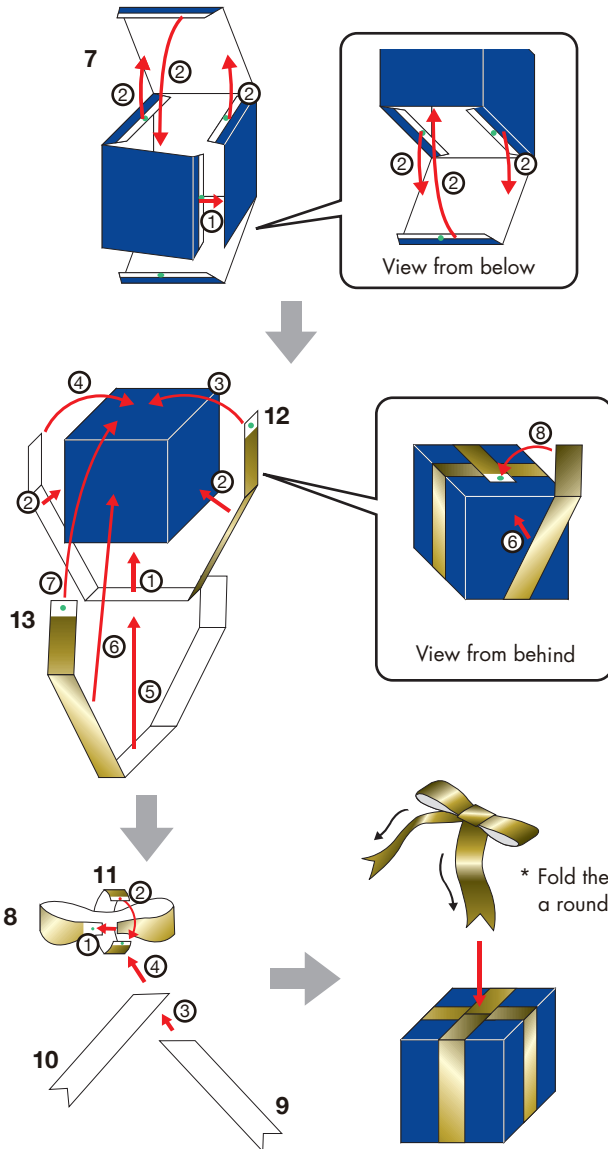

\* Build the different-colored present parts in the same way.

## Finishing

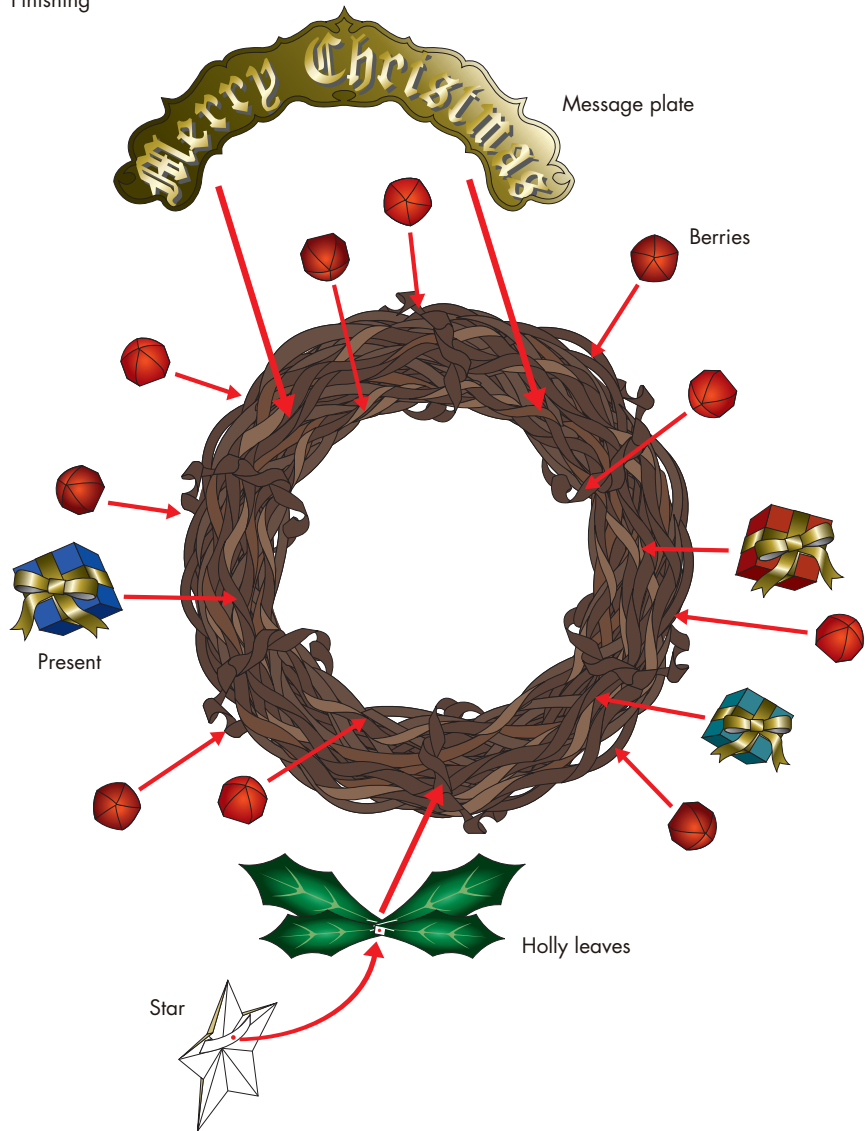

\* Finish the wreath by attaching the rear (or bottom) of each part to the flat surfaces of the main part (3 - 7), maintaining a good balance by referring to the photographs of the completed model. (We recommend attaching the star and holly leaves parts to part 7 of the main body.)