

Halloween tree : Assembly Instructions

© Canon Inc. © TakaTaka



PAPER CRAFT

<http://www.canon.com/c-park/en/>



View of completed model

Assembly Instructions : Three US letter sheets (No. 1 to No. 3)

* Build the model by carefully reading the Assembly Instructions , in the parts sheet page order.

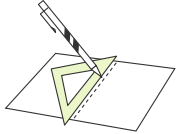

*Hint:Trace along the folds with a ruler and an exhausted pen (no ink) to get a sharper, easier fold.

Assembly Instructions



..... **Mountain fold (dotted line)**
Make a mountain fold.

----- **Valley fold (dashed and dotted line)**
Make a valley fold.

———— **Scissors line (solid line)**
Cut along the line.

———— **Cut in line (solid line)**
Cut along the line.

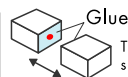

Glue
The glue spot (colored dot) shows where to apply the glue.

● **Glue spot (Red dot)**
Glue parts with the same number together.

● **Glue spot (Green dot)**
Glue within the same part.

● **Glue spot (Blue dot)**
Glue to the rear of the other part.

Tools and materials



Scissors, set square, glue (We recommend stick glue), pencil, used ballpoint pen, toothpicks, tweezers, (useful for handling small parts)

Assembly tip



Before gluing, crease the paper along mountain fold and valley fold lines and make sure rounded sections are nice and stiff.

Caution



Glue, scissors and other tools may be dangerous to young children so be sure to keep them out of the reach of young children.

Before starting assembly:
Writing the number of each section on its back side before cutting out the sections is highly recommended.
(* This way, you can be sure which section is which even after cutting out the sections.)

→ Indicates where sections should be glued together.
→ Indicates where to insert sections. Do not glue the sections together.

Assembling the pot

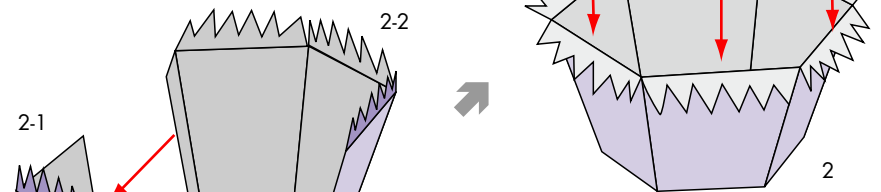
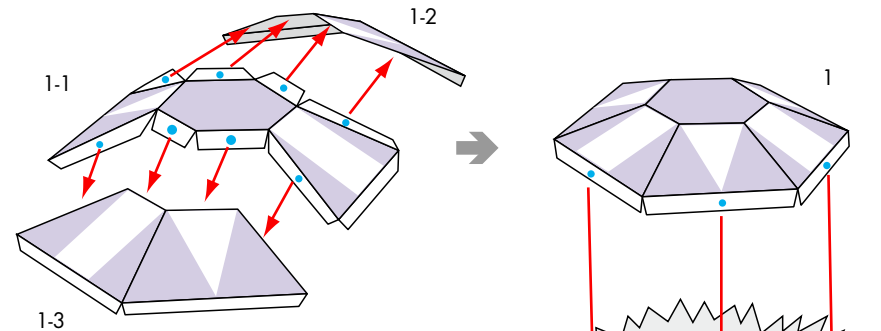

Glue the six surfaces of part 1 marked with ● to the rear side of part 2. Although a mountain fold is used for the folds in the blades of grass on part 2, fold them outward where indicated here to make it easier to work with part 1.

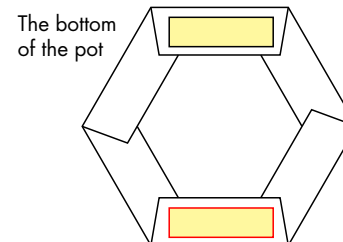

Complete the pot by gluing the bottom in place.

Halloween tree : Assembly Instructions

Assembling the tree trunk

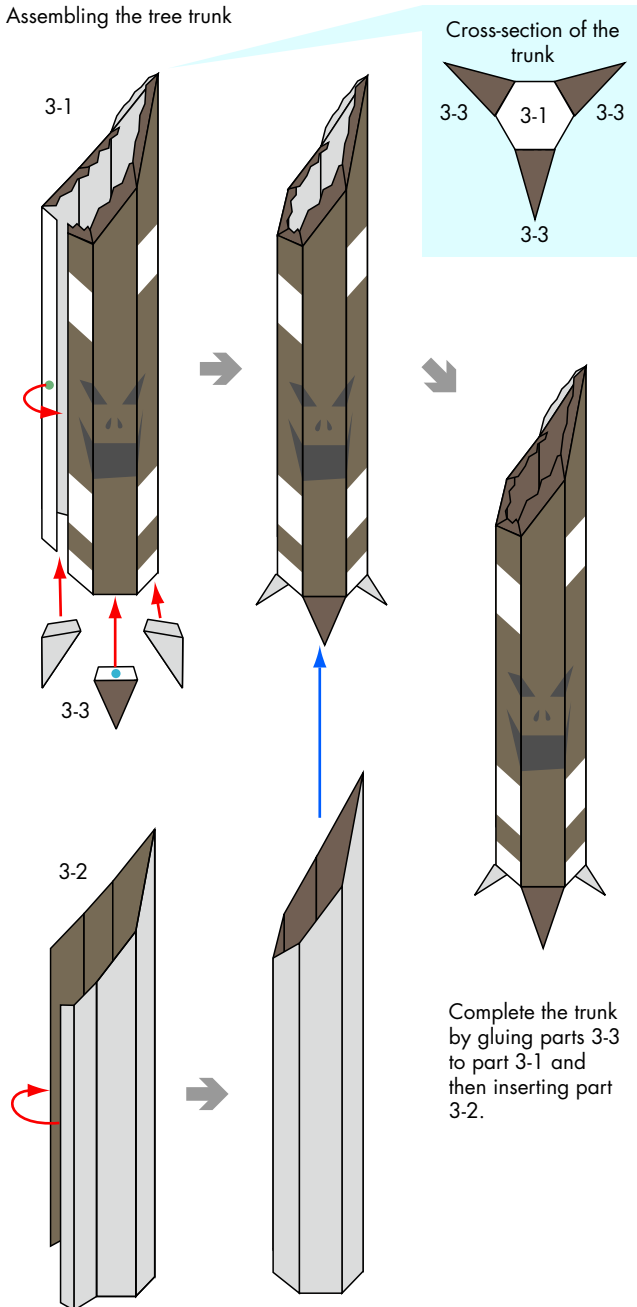

Assembling the branches

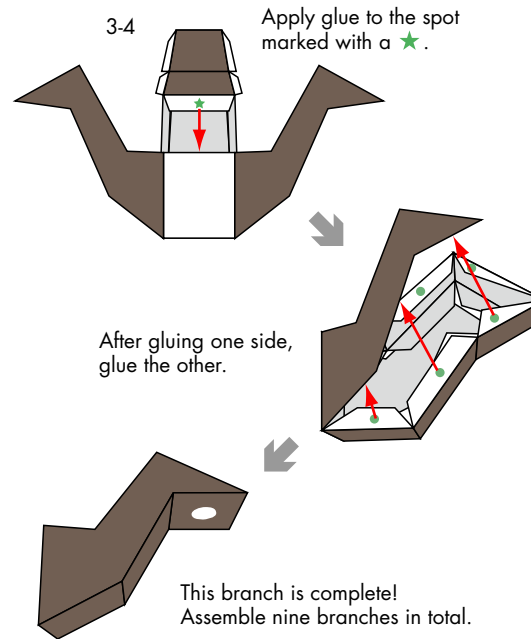

Assembling the roots

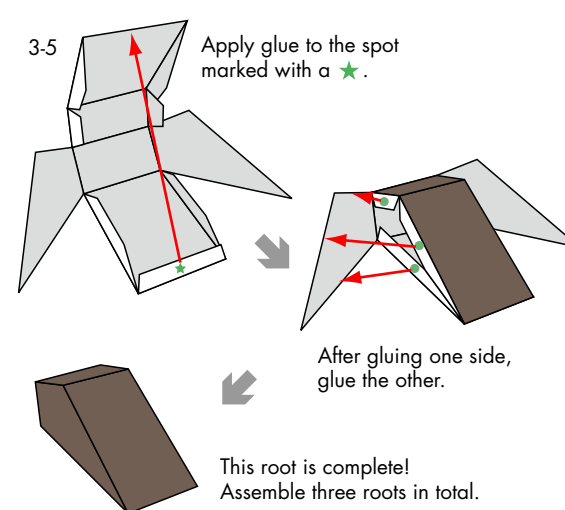

Assembling the trunk, branches, roots, and pot together

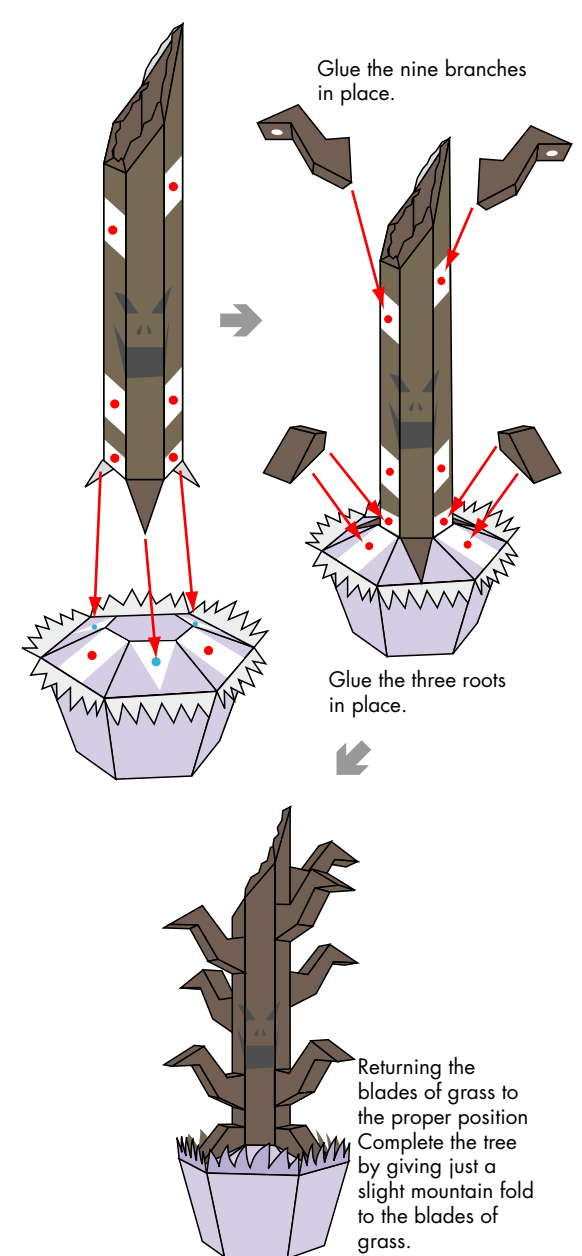

Halloween tree : Assembly Instructions

Assembling the jack-o'-lanterns

Assemble a total of nine jack-o'-lanterns. Each has the same shape and is assembled in the same way, with only their patterns differing.

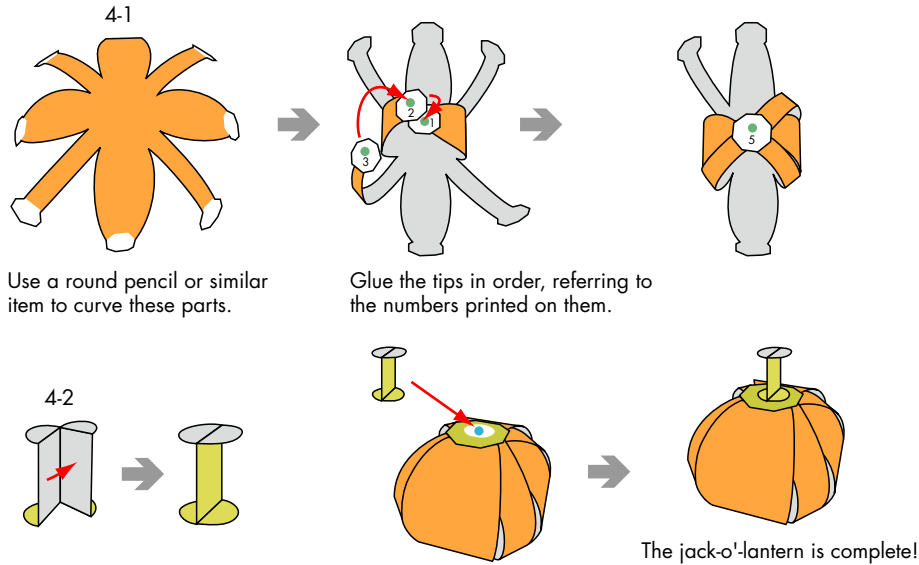

Decorating the tree

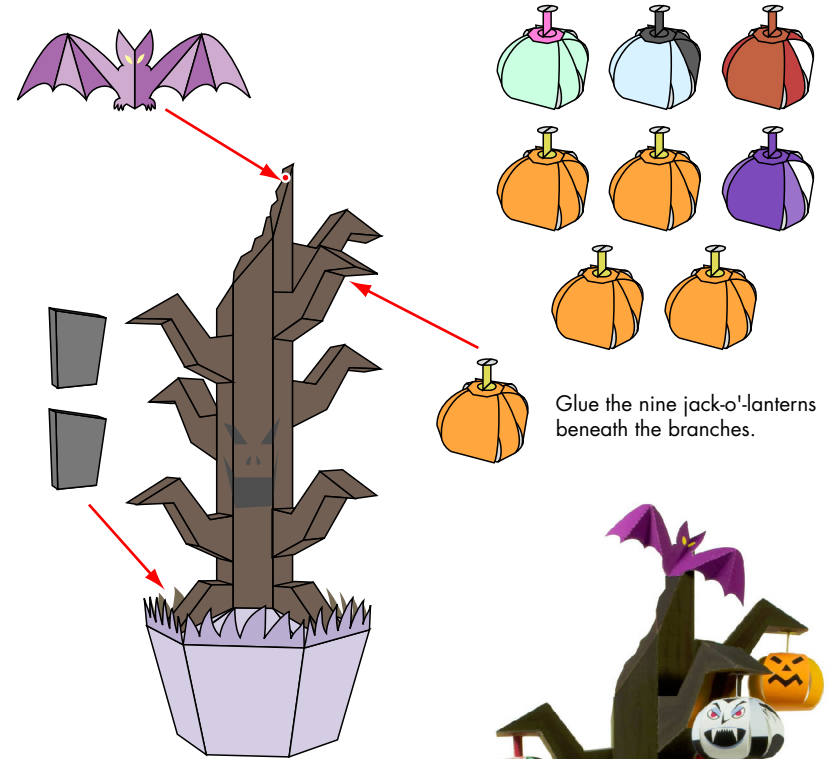

After gluing the jack-o'-lanterns in place, glue the surfaces of the tombstones marked with ● in any location you like.

Assembling the tombstone

Assemble a total of two tombstones. Each has the same shape and is assembled in the same way, with only their patterns differing.

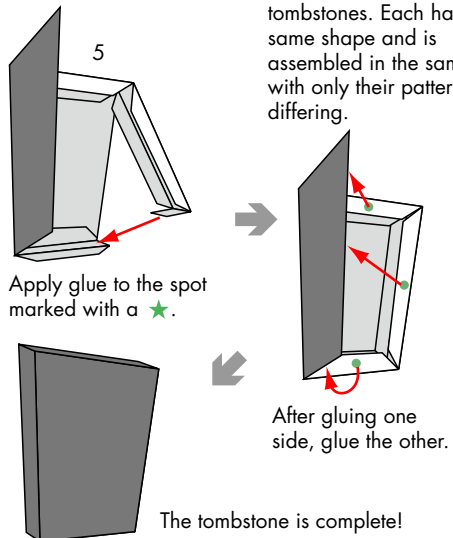

Assembling the bat

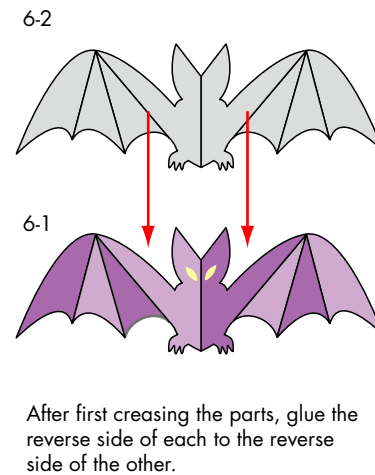

Your Halloween tree is complete!