

★ For best results use 80 gr/m² special coated paper If you have ink jet printer
 ★ For best color matching use color reference tables for printer calibration

★ Use border scales to control the dimensions of the printed layout
 ★ Print the layout with maximal available resolution

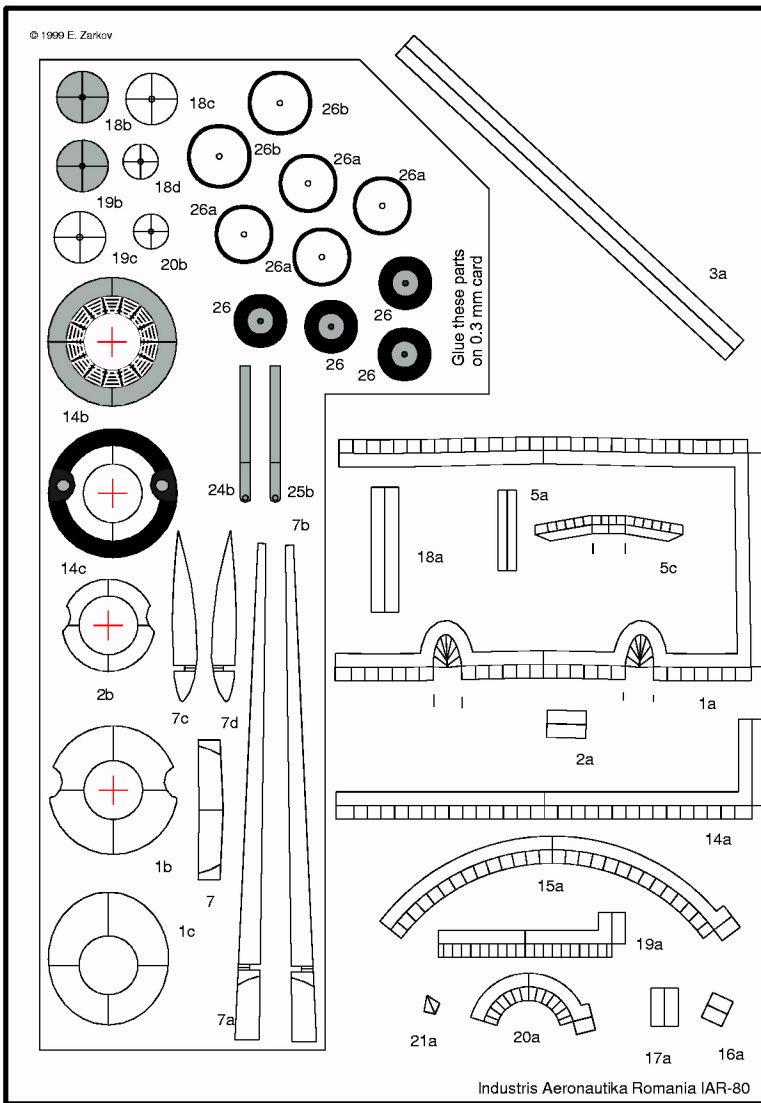

ModelArt® FOR YOUR COLLECTION **6**

Industriis Aeronautika Romania

IAR 80 C

1/72 scale PRECISE CARD MODEL

◆ Contains high quality cutouts and assembly instruction ◆ Printed in realistic colors ◆ High resemblance to prototype

Though being not so well known as Mustangs, Messers and Spitfires are, this Romanian fighter participated successfully in many military operations on the Eastern front against Russia and in home defense against allied bomber raids as well. The most successful operation of the yellow crossed IAR-80 C fighters during WWII was on June 10, 1944 when 26 of them managed to shoot down 24 P38 J Lightnings from 15-th USAAF Wing near Bucharest.

FAMOUS WW II FIGHTERS

Scale 1:72

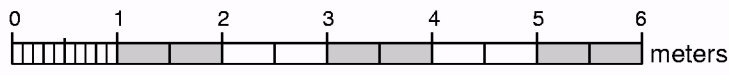

★ For individual use only, under no circumstances can this document be resold without written permission by ModelArt.
 ★ You can contact us sending E-mail to: modelart@tusk.icn.bg

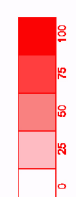
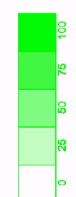
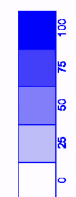
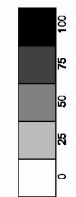
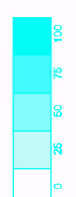
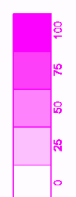
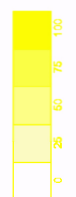
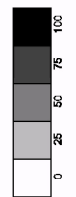

★ For best results use 80 gr/m² special coated paper If you have ink jet printer
 ★ For best color matching use color reference tables for printer calibration

★ Use border scales to control the dimensions of the printed layout
 ★ Print the layout with maximal available resolution

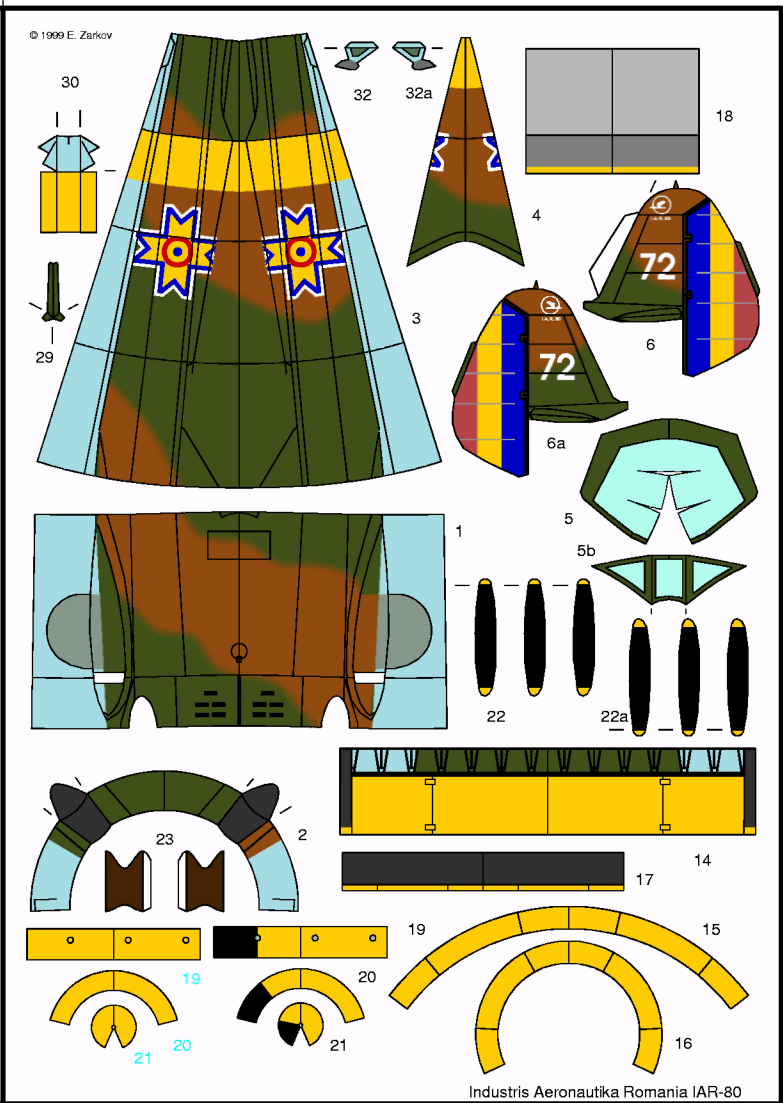
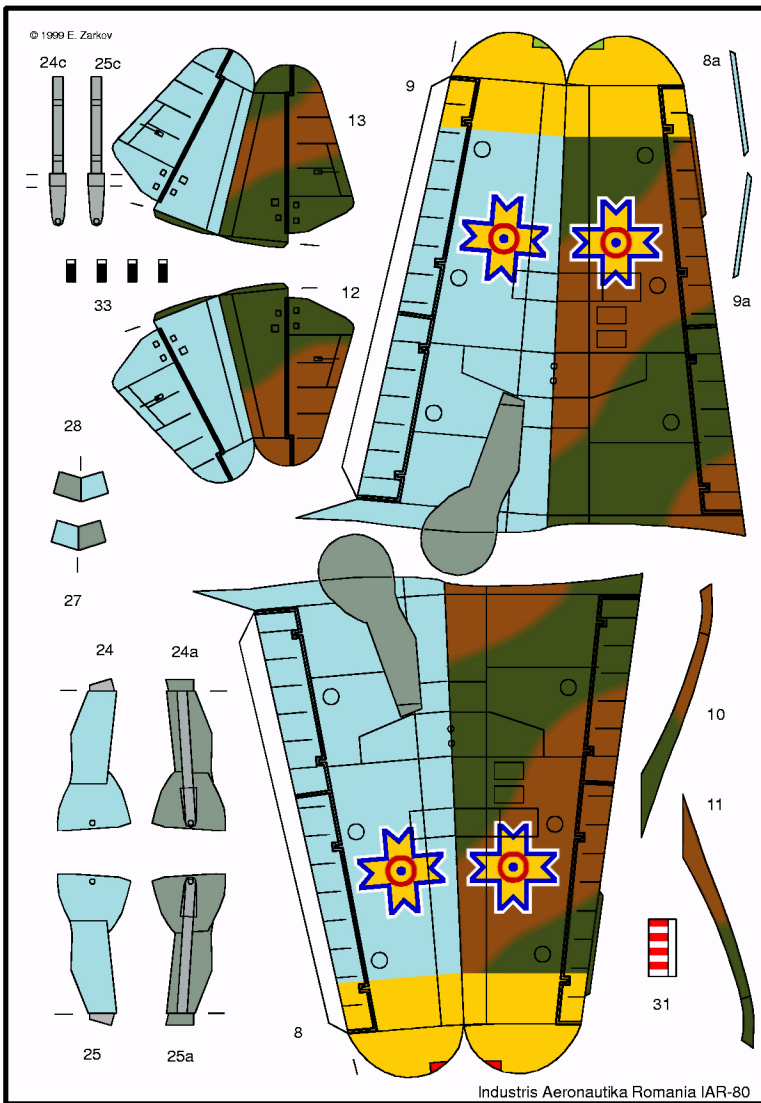

Scale 1:72

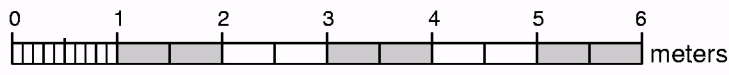

★ For individual use only, under no circumstances can this document be resold without written permission by ModelArt.
 ★ You can contact us sending E-mail to: modelart@tusk.icn.bg



© 1999 E. Zarkov

ASSEMBLY INSTRUCTION

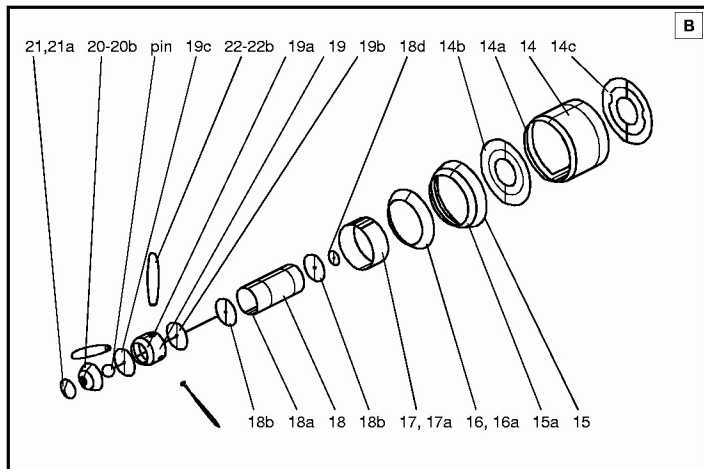
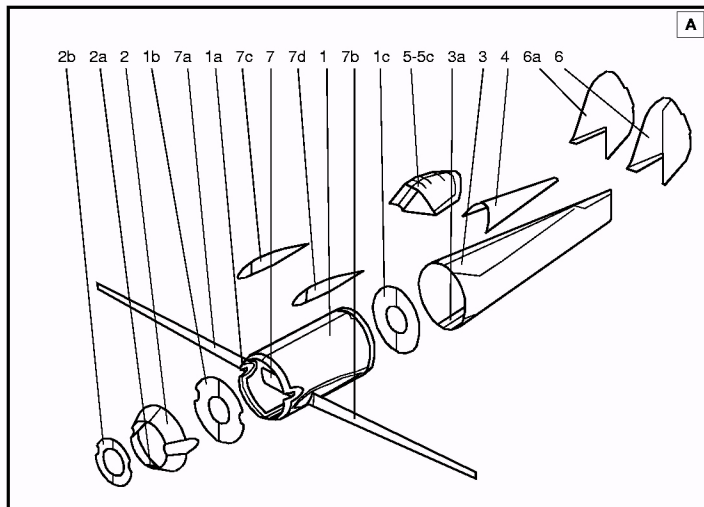

Industriis Aeronautika Romania IAR-80

© 1999 E. Zarkov

ASSEMBLY INSTRUCTION

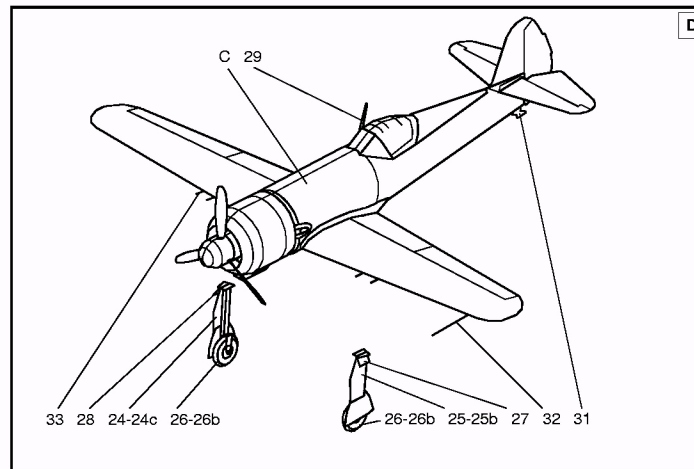
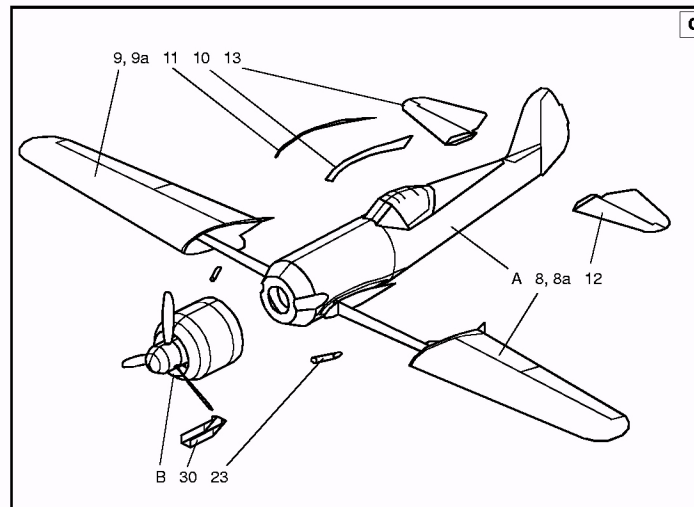

Industriis Aeronautika Romania IAR-80

ASSEMBLY INSTRUCTION

Study the drawings of assembly steps carefully before starting the work on the model. Make sure you understand the purpose and place of every part.

The assembly requires some basic tools, such as scissors, sharp modeling knife, blunt knife for scoring the fold lines, ruler and needle. Additional materials you need are one pin to make the airscrew shaft and one piece of cardboard approx. 0.3 mm thick for reinforcing elements and wheels. You'll need of course suitable cement too. For cement application you can use toothpicks or some similar tool (special fine cement applicator is most suitable if you have one).

Start with the central fuselage segment 1. Do not forget to cut the holes on it where the wing longerone 7 will be placed. Glue the connecting stripes 1a to the backside of the segment and glue it in cylindrical form. Place formers 1b and 1c in its edges, keeping coincidence of the lines of symmetry.

Continue with the segment 2. Carefully form its exhaust sockets, giving them concavity, following the shape of the former 2a. Then glue it to 1.

Assembly the tail segment 3, assuring smooth transition of its oval shape in the front edge to flat vertical shape of the rear. Glue 4 to 1. Form and assembly the cockpit 5 - 5d and position it on the fuselage. Add the vertical stabilizer 6, 6a, keeping the symmetry of the model.

Prepare wing's longerone 7 - 7b and insert it in the holes of 1. Glue it to 1 and then place two wing profiles 7c,d on it. Assembly the wing halves 8 and 9 and glue them to fuselage, inserting the longerone 7 in them in a way that the profiles stay in their bases. Glue the wing-fuselage joints 10 and 11, applying the glue on their joint places on 1, 3, 8 and 9. Cut and assembly horizontal stabilizer 12 and 13 and glue it to 3.

Continue with the engine cowling 14 - 17. Be extremely careful during gluing the formers 14 c and 14 d. the last one must be positioned 3 mm inside 14. Control the joint of the segment 14 to the front of the fuselage until drying the glue.

Assembly the propeller bearing 18 and propeller hub 19 - 21, using a pin as a propeller shaft. Add the propeller blades 22, 22a and insert the shaft in 18, gluing 1d on the backside of the shaft, ensuring free rotation of the propeller. Glue the engine assembly to 2b and add

exhausting pipes 23

Assembly the landing gear 24 - 28. Cut the wheels parts 26 from thick card, glue them together, round their edges with sandpaper and paint them in black.

Complete the model adding remaining small details - carburetor intake 30, antenna mast, tail support, Pitot tube and armament.

If you prefer flying model, assemble it with retracted undercarriage and abandon propeller blades. Add some weight in the nose for appropriate model's balancing - its center of gravity must be on approximately 25% of the average wing chord.

Now your model is ready. Enjoy your IAR 80.



Industriis Aeronautika Romania IAR-80

Industriis Aeronautika Romania IAR-80