

ModelArt®

FOR YOUR
COLLECTION

15

BUCHON

HA-1112-M1L

1/33 SCALE

PRECISE CARD MODEL

◆ Contains high quality cutouts and assembly instruction ◆ Printed in realistic colors ◆ High resemblance to prototype

Developed on the base of Messerschmitt Bf-109 G with English MERLIN engine despite the original DB 605, this type has been in military service till 1962 in Spain.



FAMOUS FIGHTERS

ASSEMBLY INSTRUCTION

Study the drawings of assembly steps carefully before starting the work on the model. Make sure you understand the purpose and place of every part.

The assembly requires some basic tools, such as scissors, sharp modeling knife, blunt knife for scoring the fold lines, ruler and needle. Additional materials you need are one pin to make the air screw's shaft and one piece of cardboard approx. 0.3 mm thick for reinforcing elements and wheels. You'll need of course suitable cement too. For cement application you can use toothpicks or some similar tool (special fine cement applicator is most suitable if you have one).

First of all you must score with the blunt knife all fold lines shown on the cutouts with short thin line marks near the parts. To avoid mistakes and lost parts cut the necessary details shortly before their use. The places where an additional cutting is needed are marked with small thick line marks.

Start with the tail part of the fuselage. Cut part 1, bend it in oval form and glue it using connecting stripes 1a - 1h and then insert the preliminary folded former 1i in it. Be careful - appropriate forming of this part is a key for good looking of entire model.

Continue with the cockpit fuselage section 2. Cut the place for wing longerone on the connecting stripe 2b shortly before fixing the wing.

Add the nose part of the fuselage 3. Keep all lines of symmetry during fuselage assembly. Carefully cut the internal holes in the formers 3c and 4b. Later the propeller shaft bearing is to be inserted there.

Complete the fuselage, fixing its front part 4, cockpit 5 and oil cooler cowling 6. Then glue the vertical stabilizer 7 and the cowlings of the MERLIN engine 8, 9.

Now focus your attention on the wing. Glue the profiles 10a and 10b to the longerone 10 and cover the obtained superstructure with the wing halves 11 and 12. Assure straight rear edges and avoid wrapping. Cement the assembled wing to the fuselage. Prepare the aerodynamic wing-fuselage joints 13 and 14, cutting them approximately to the middle line in continuations of the linemarks outside the parts. After forming and several dry tests glue them on their places. For cleaner job it is recommended to apply glue not on them, but on their attachment points on the wing and fuselage.

Cement the two water-cooling radiators to the under surface of the wing and the two small tire bumps 20, 21 on its upper surface.

Assemble and glue the horizontal stabilizer 16, 17 to the tail.

Continue with the propeller. Assemble its shaft bearing 22 and insert the formers 22a and 22b in it. Assemble the propeller spinner part 23, fix its formers, insert and glue the pin that will serve as propeller shaft. Complete the spinner, adding parts 24 and the propeller blades 27, 27a. Insert the propeller's shaft in its bearing and cement the fixing element 25 to the shaft. The propeller must be capable of rotating free .

Assembly the landing gear. Cut the wheels' part 31, 32 from thick card and cement them together. Round their edges with sandpaper and retouch them with black ink or paint.

Complete the model, adding antenna mast 15 and machine guns 28, 29..

If you prefer flying model, assemble it with retracted undercarriage and abandon propeller blades. Add some weight in the nose for appropriate model's balancing - Its center of gravity must be on approximately 25% of the average wing chord.

Now your model is ready. Enjoy your HA-1112-M1L BUCHON



ASSEMBLY INSTRUCTION

A

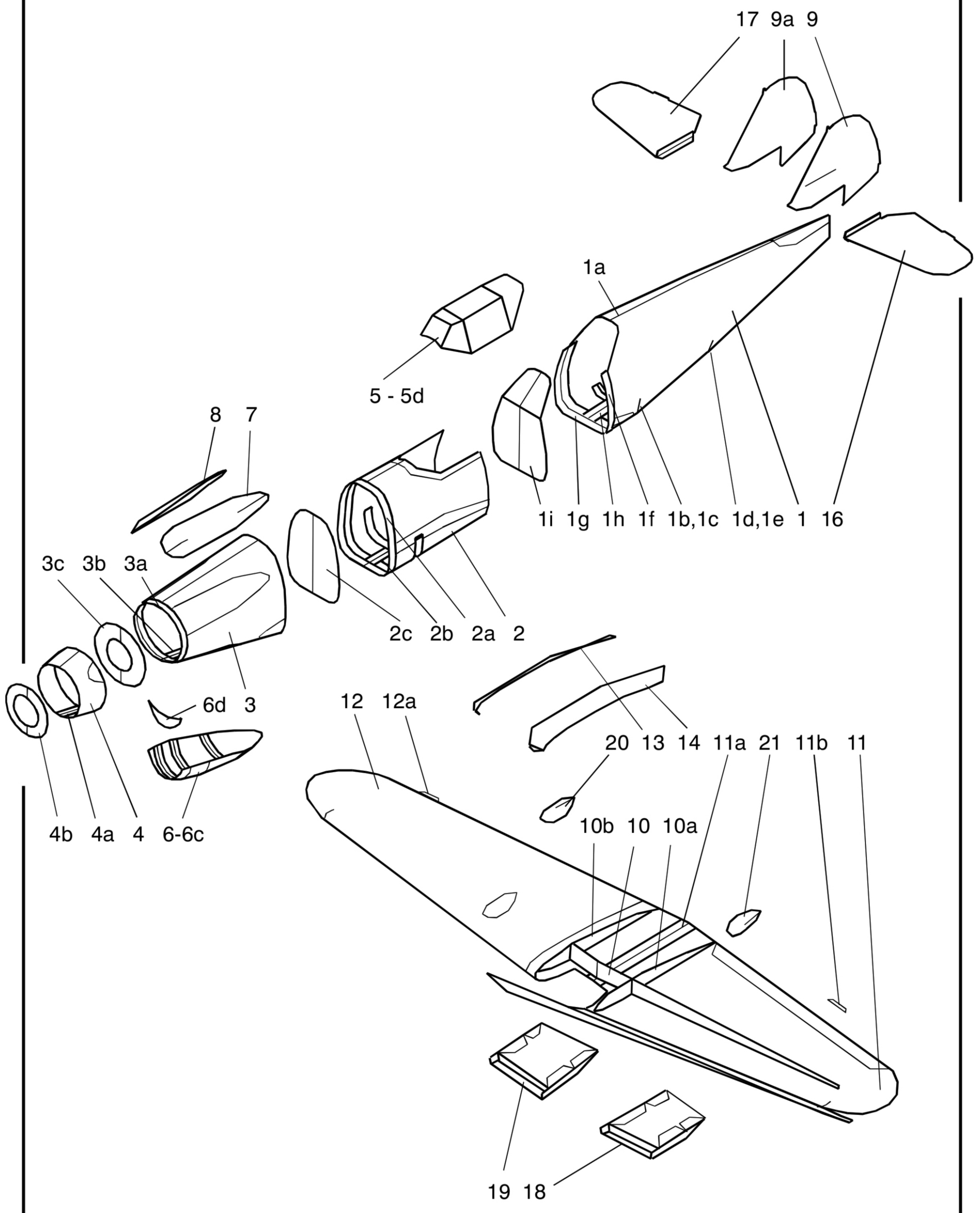

ASSEMBLY INSTRUCTION

B

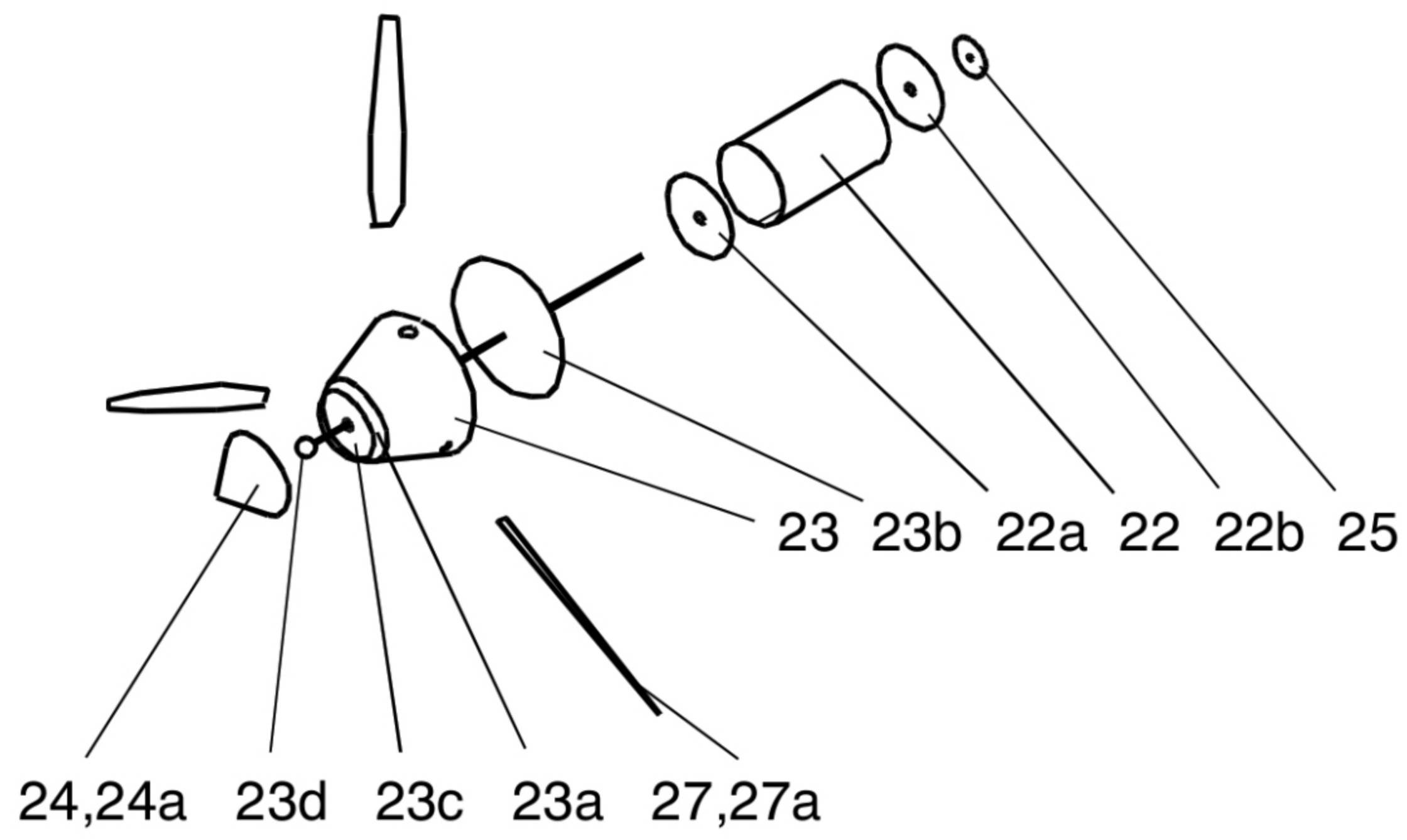

C

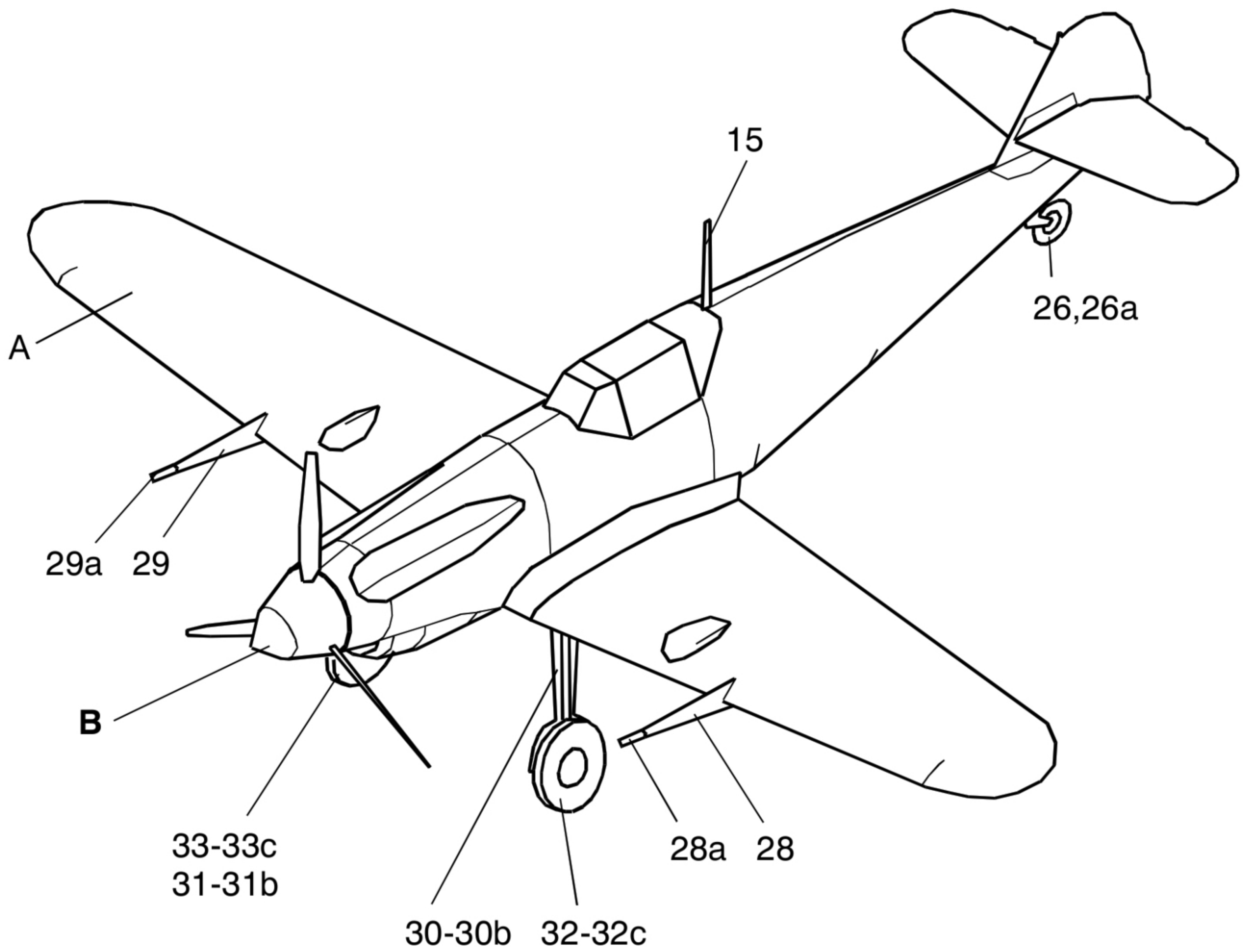

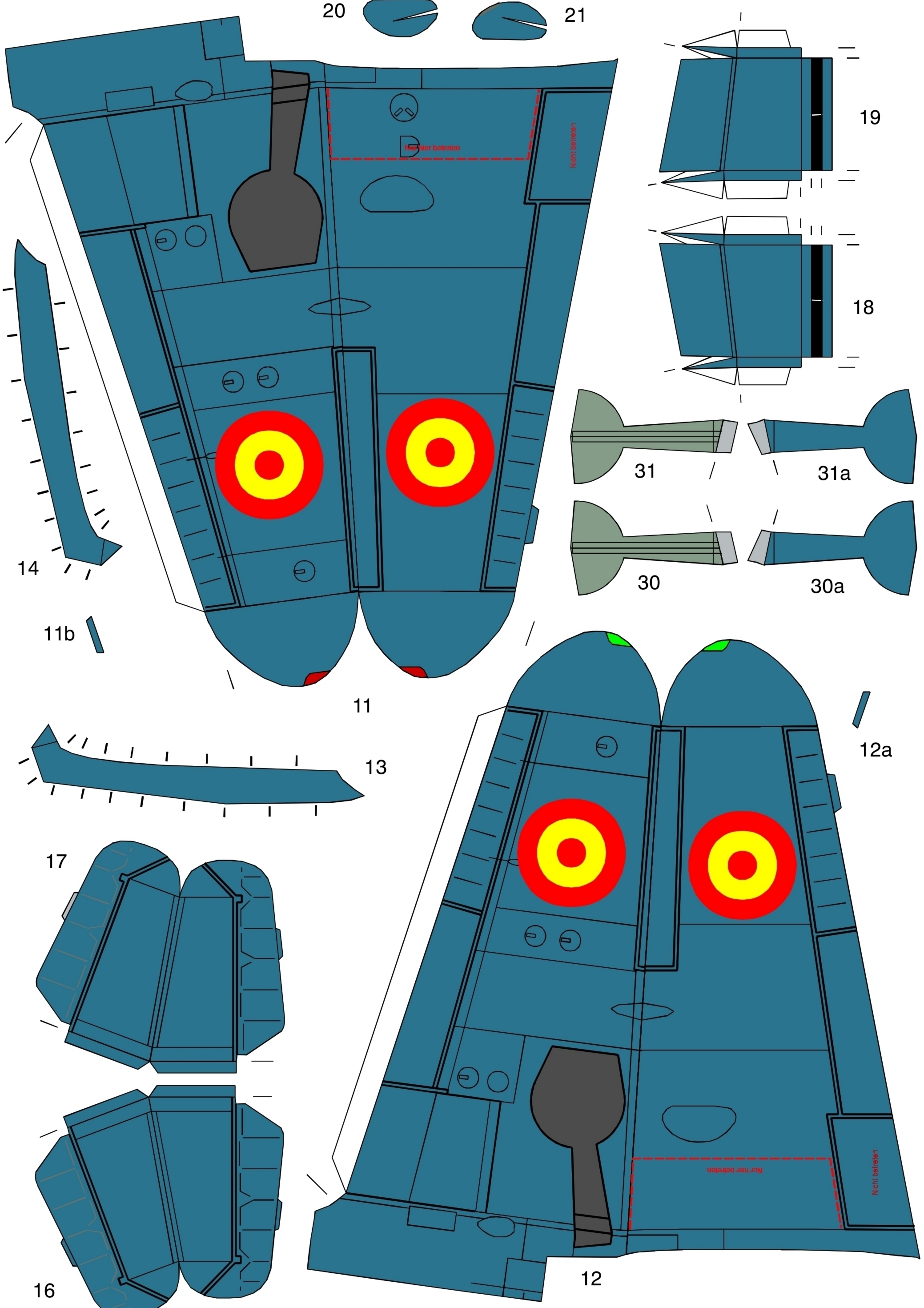

20

21

19

18

31

31a

30

30a

14

11b

11

13

12a

17

16

12

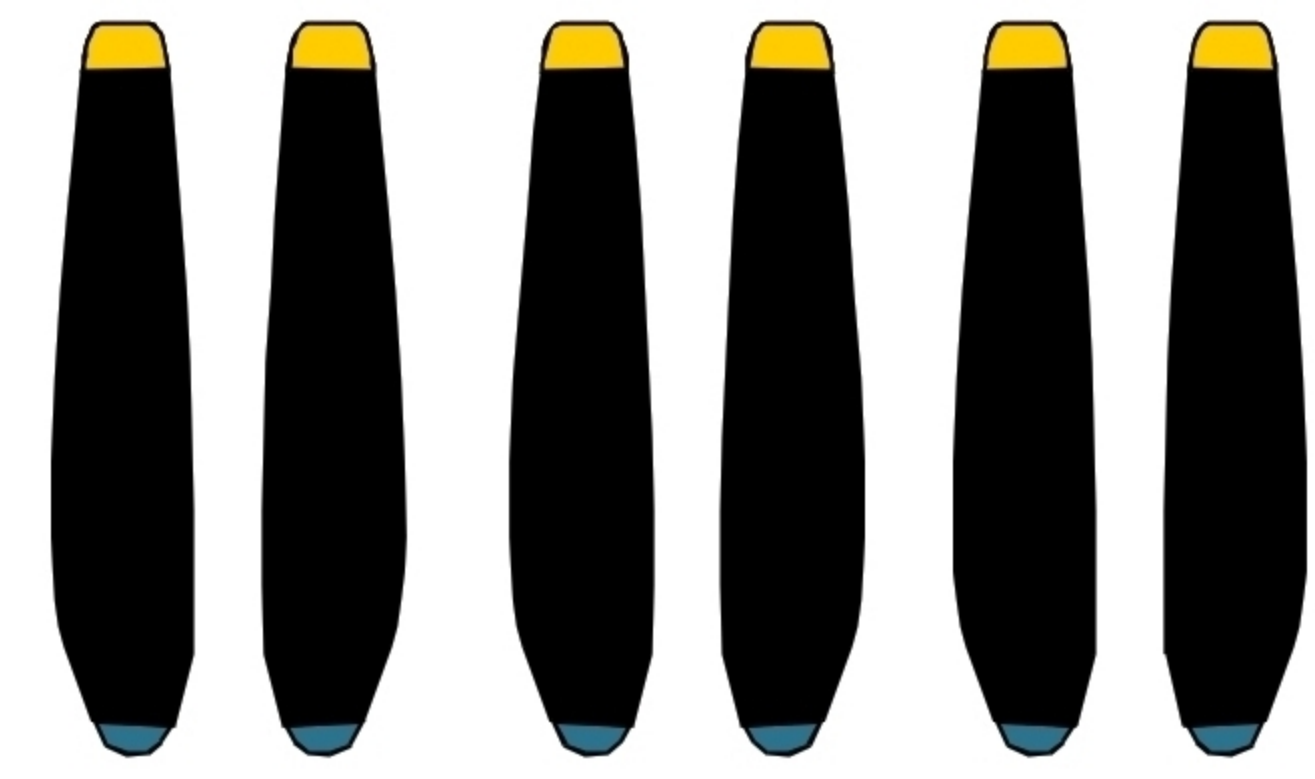
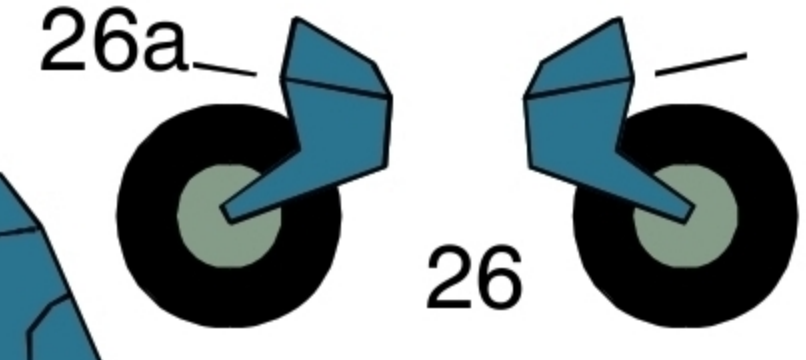

22

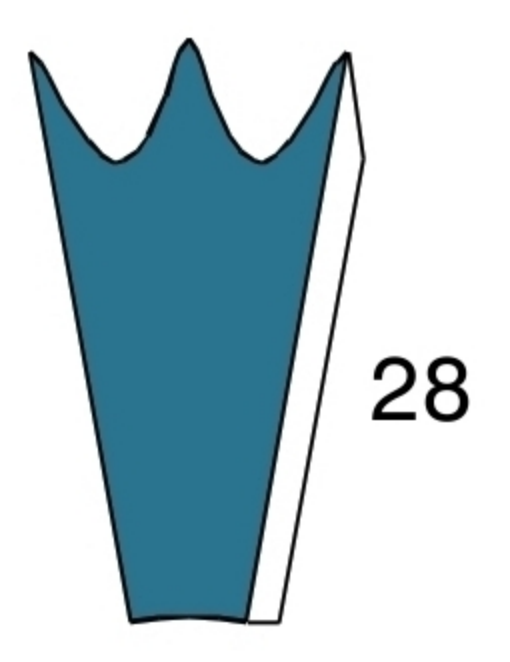

28

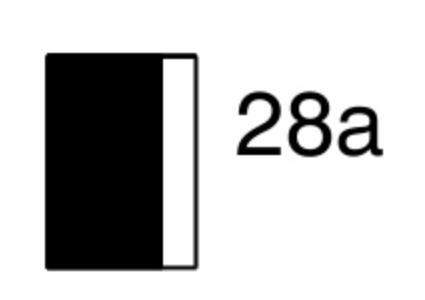

28a

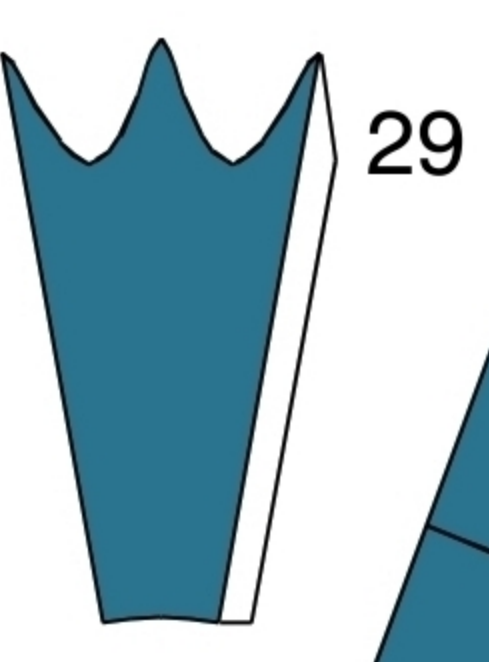

29

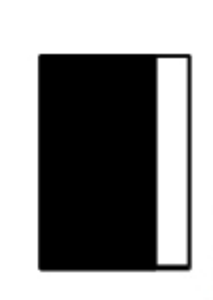

29a

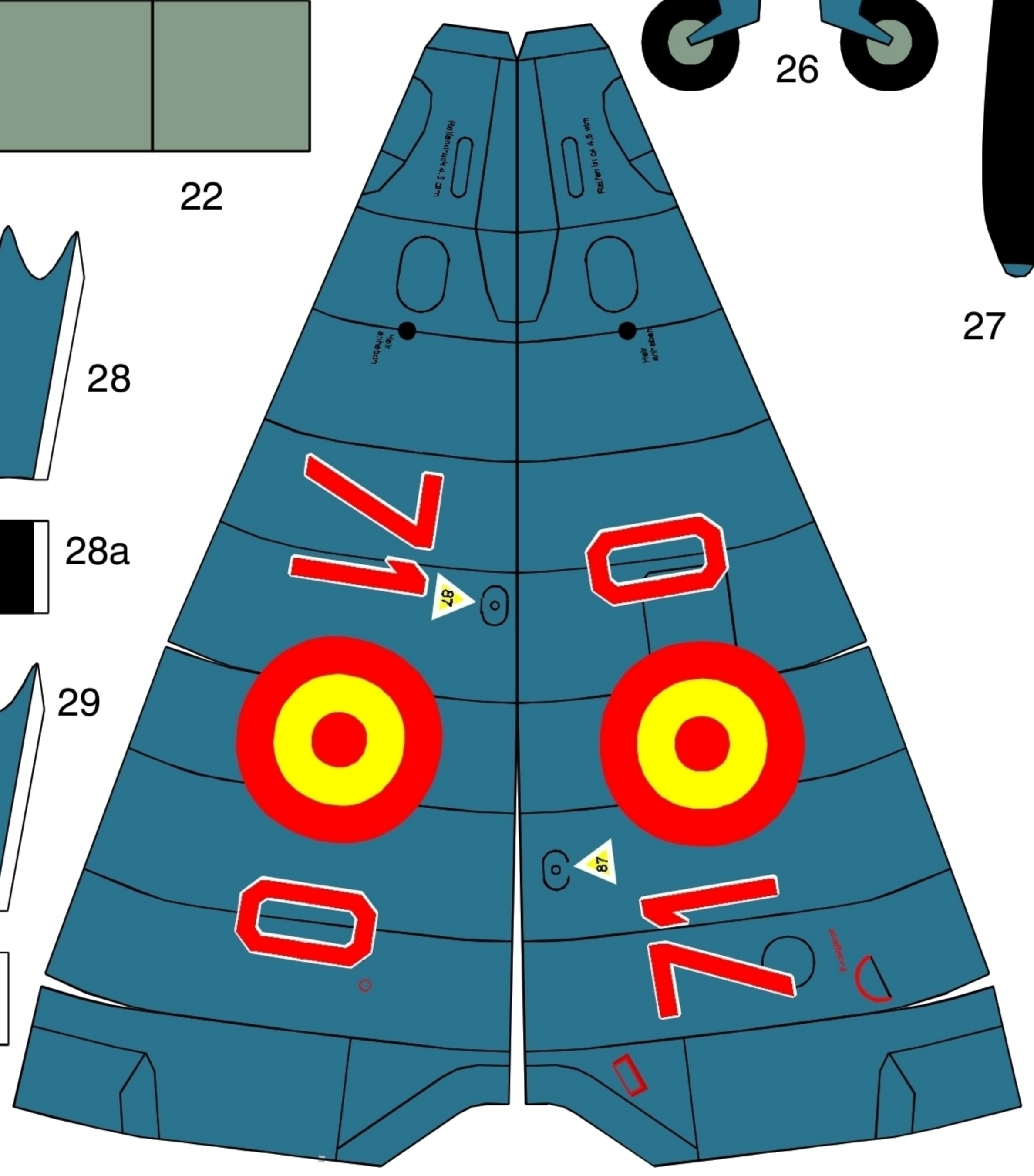

1

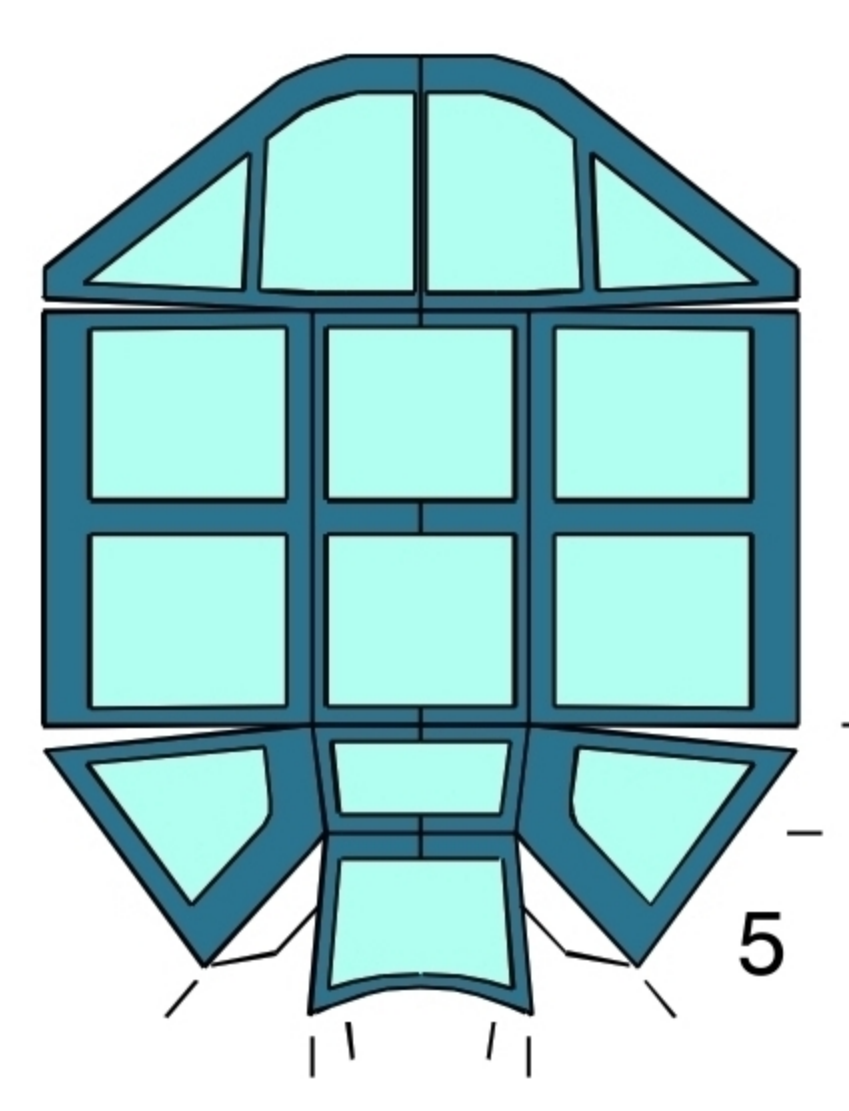

5

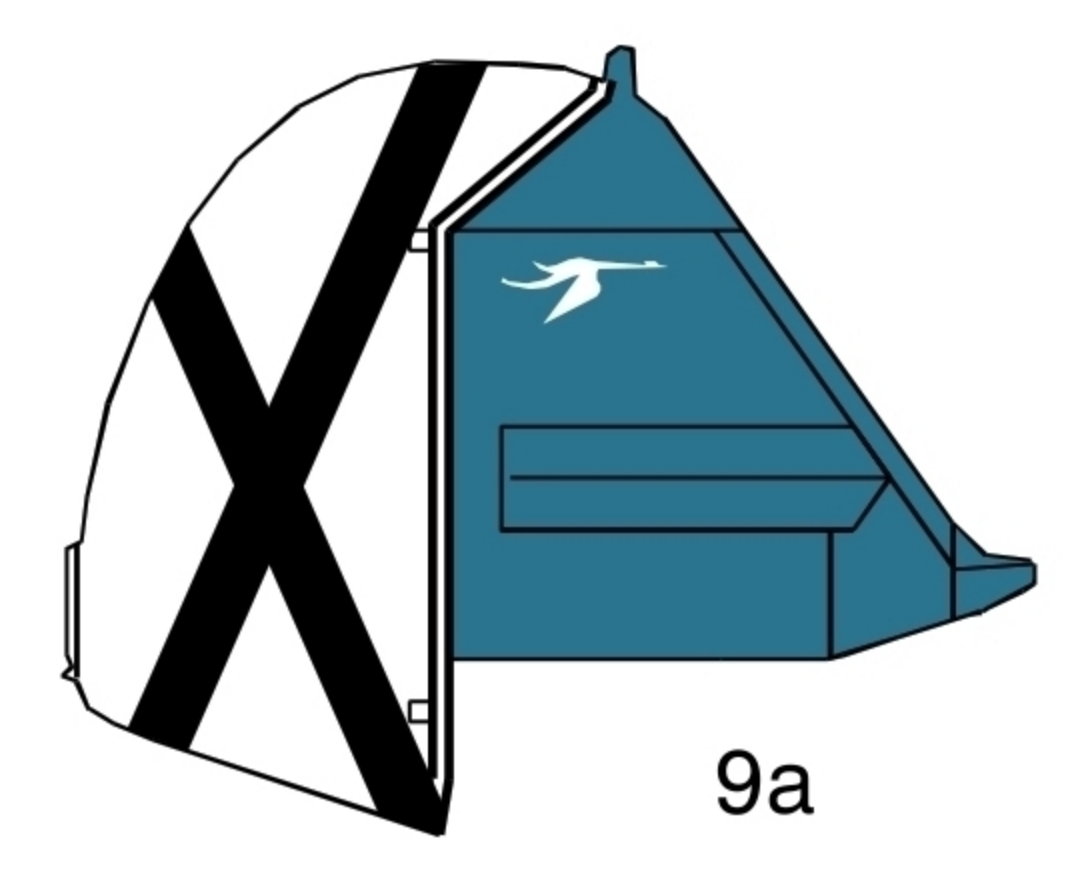

9a

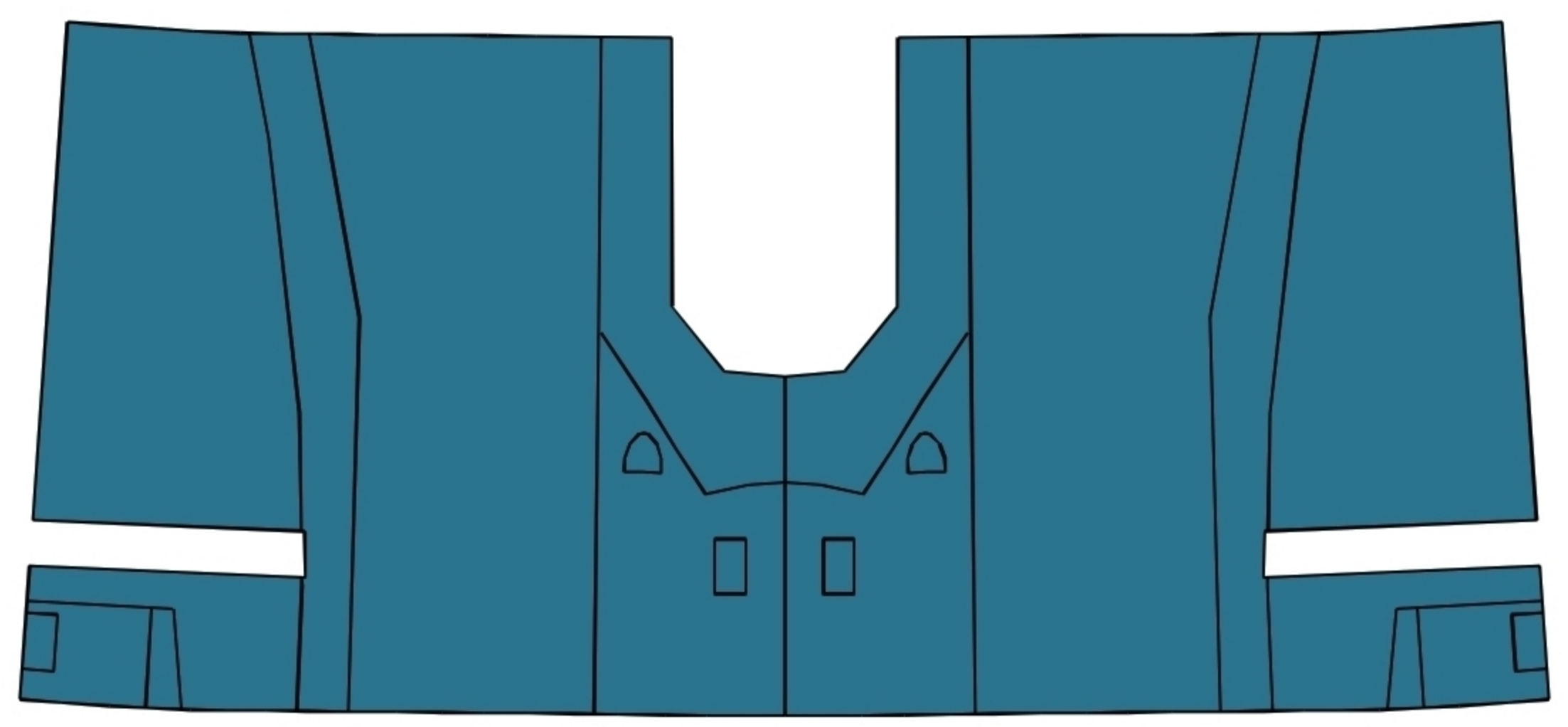

2

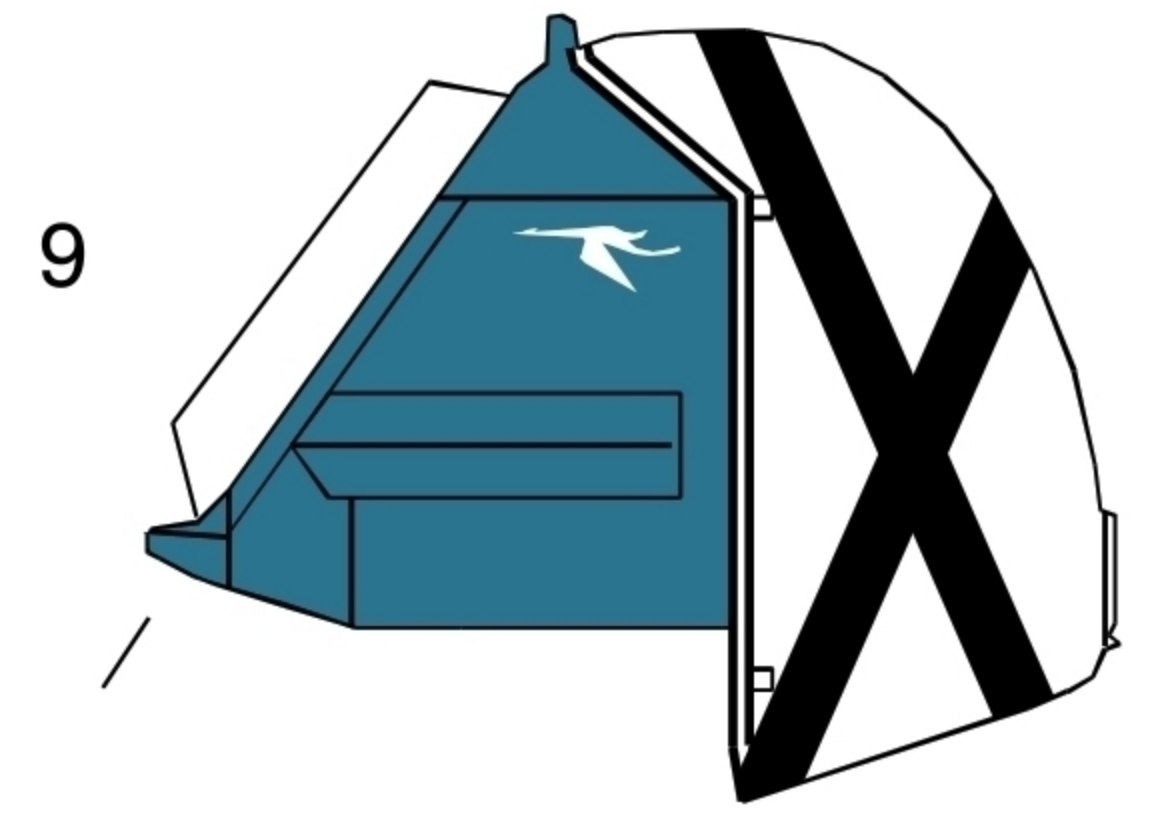

9

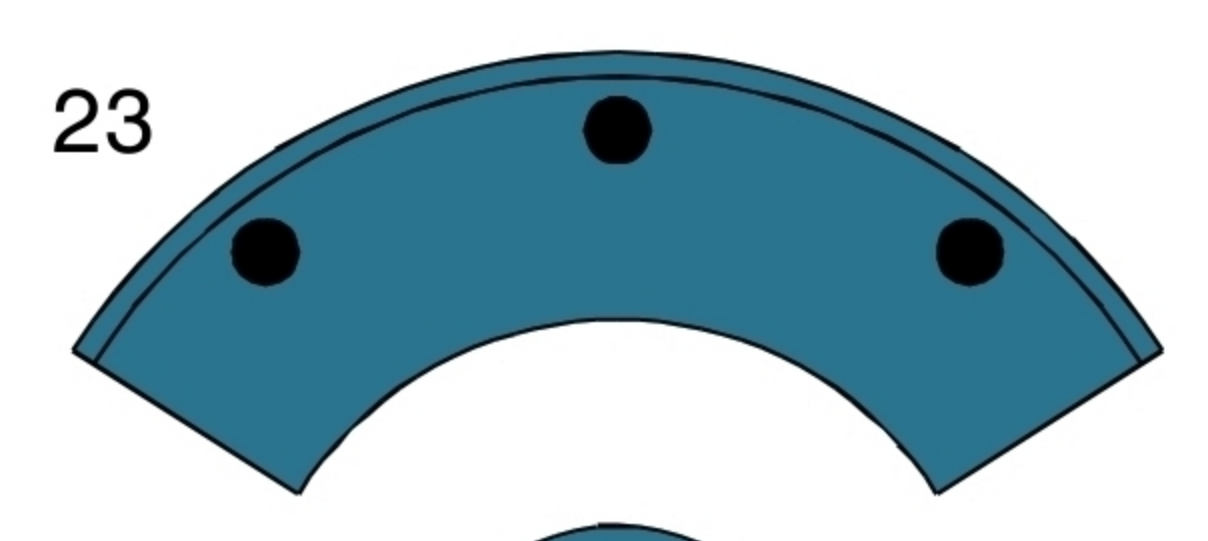

23

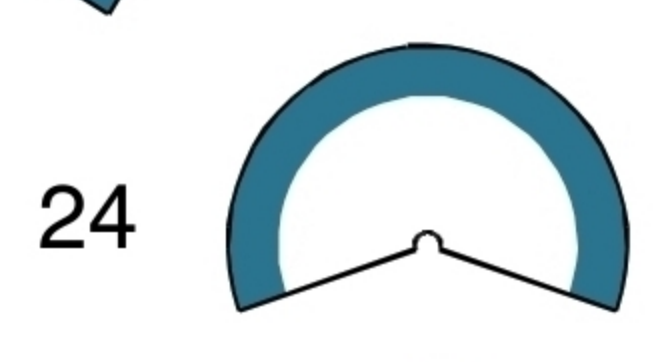

24

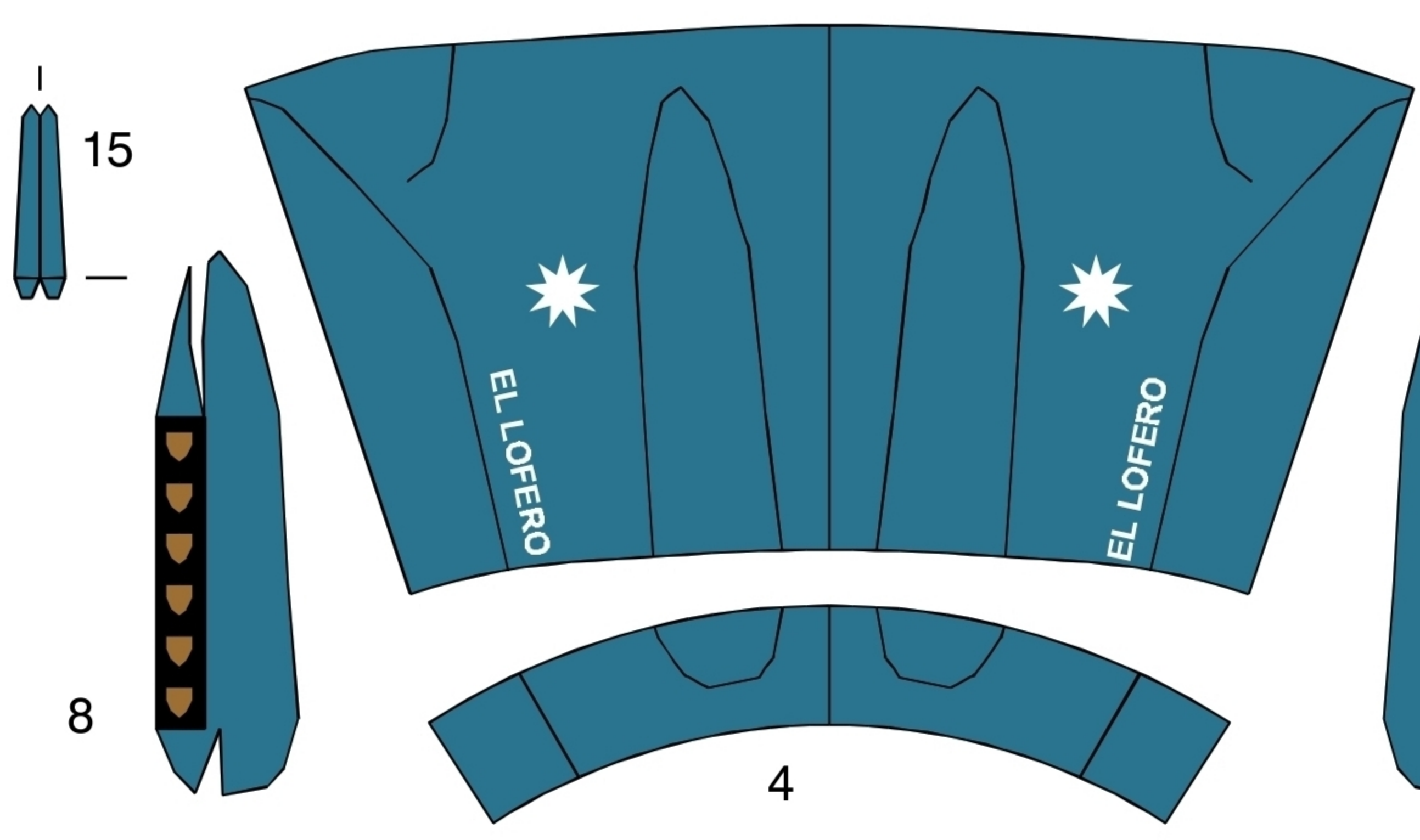

3

4

7

8

15

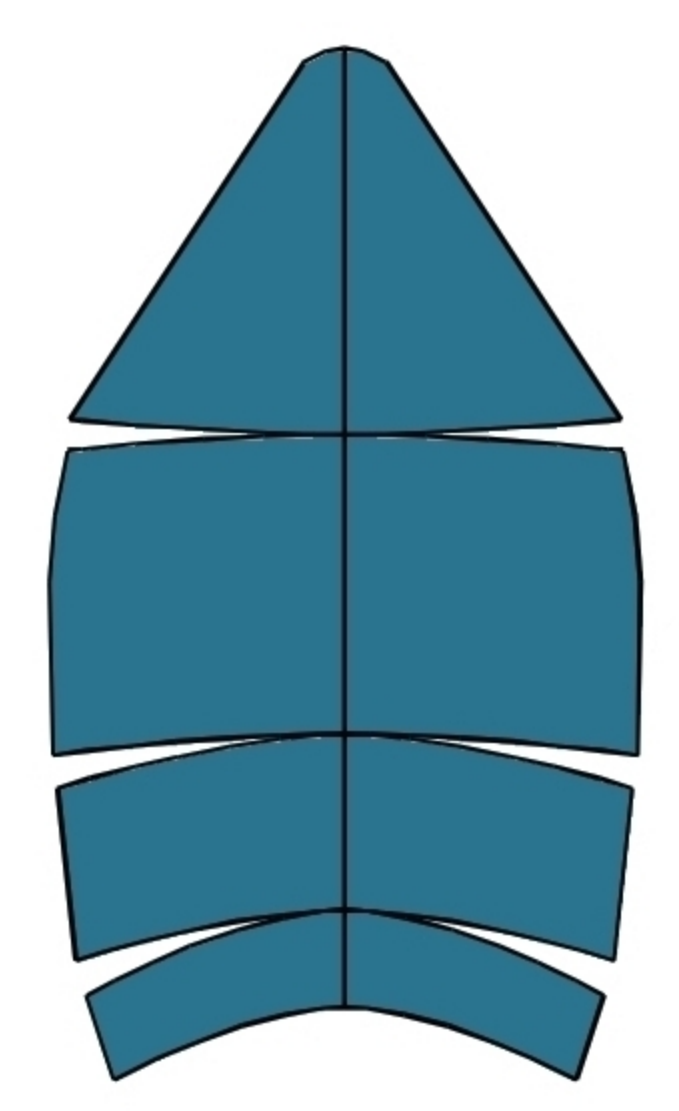

6

