

★ For best results use 80 gr/m² special coated paper If you have ink jet printer
★ For best color matching use color reference tables for printer calibration

★ Use border scales to control the dimensions of the printed layout
★ Print the layout with maximal available resolution

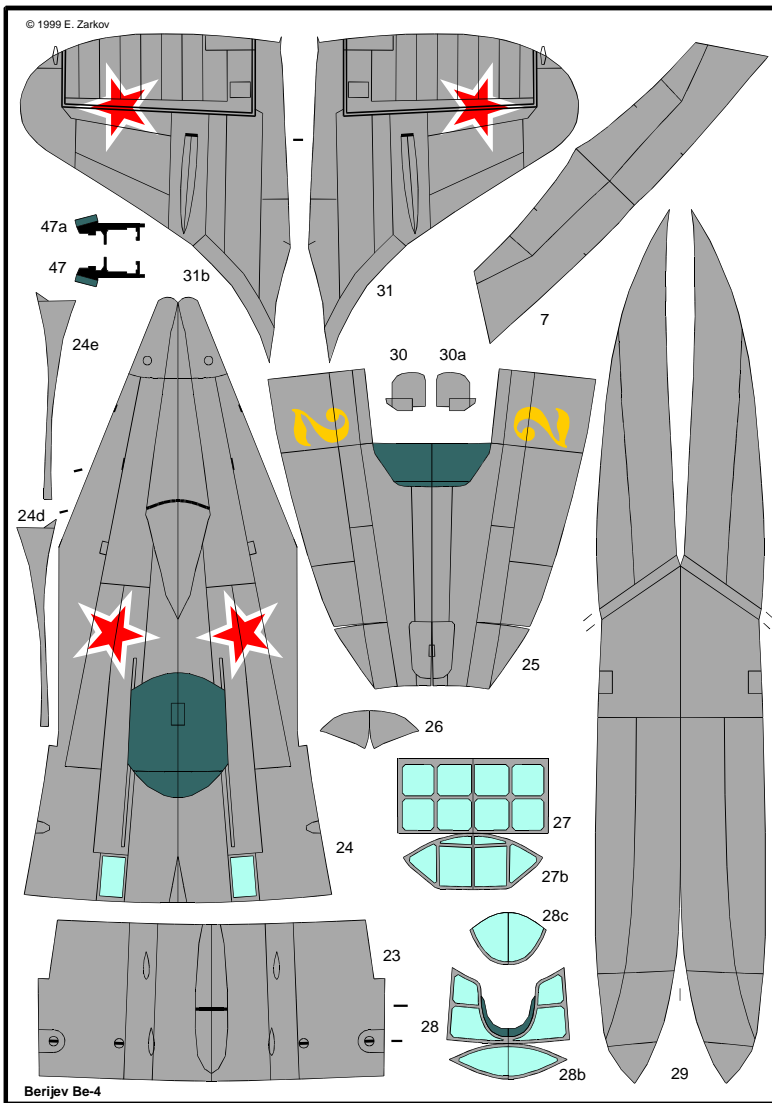

ModelArt® FOR YOUR COLLECTION **5**

BERIJEV Be-4

1/72 scale PRECISE CARD MODEL

◆ Contains high quality cutouts and assembly instruction ◆ Printed in realistic colors ◆ High resemblance to prototype

The Be-4, known also as KOR-2 /Sea Recognition Aircraft/, was constructed in the Berijev Design Bureau in the 1940. The type was used against German submarines and for convoy escort missions during WWII.

WW II FLOAT PLANES

Scale 1:72



★ For individual use only, under no circumstances can this document be resold without written permission by ModelArt.
★ You can contact us sending E-mail to: modelart@tusk.icn.bg

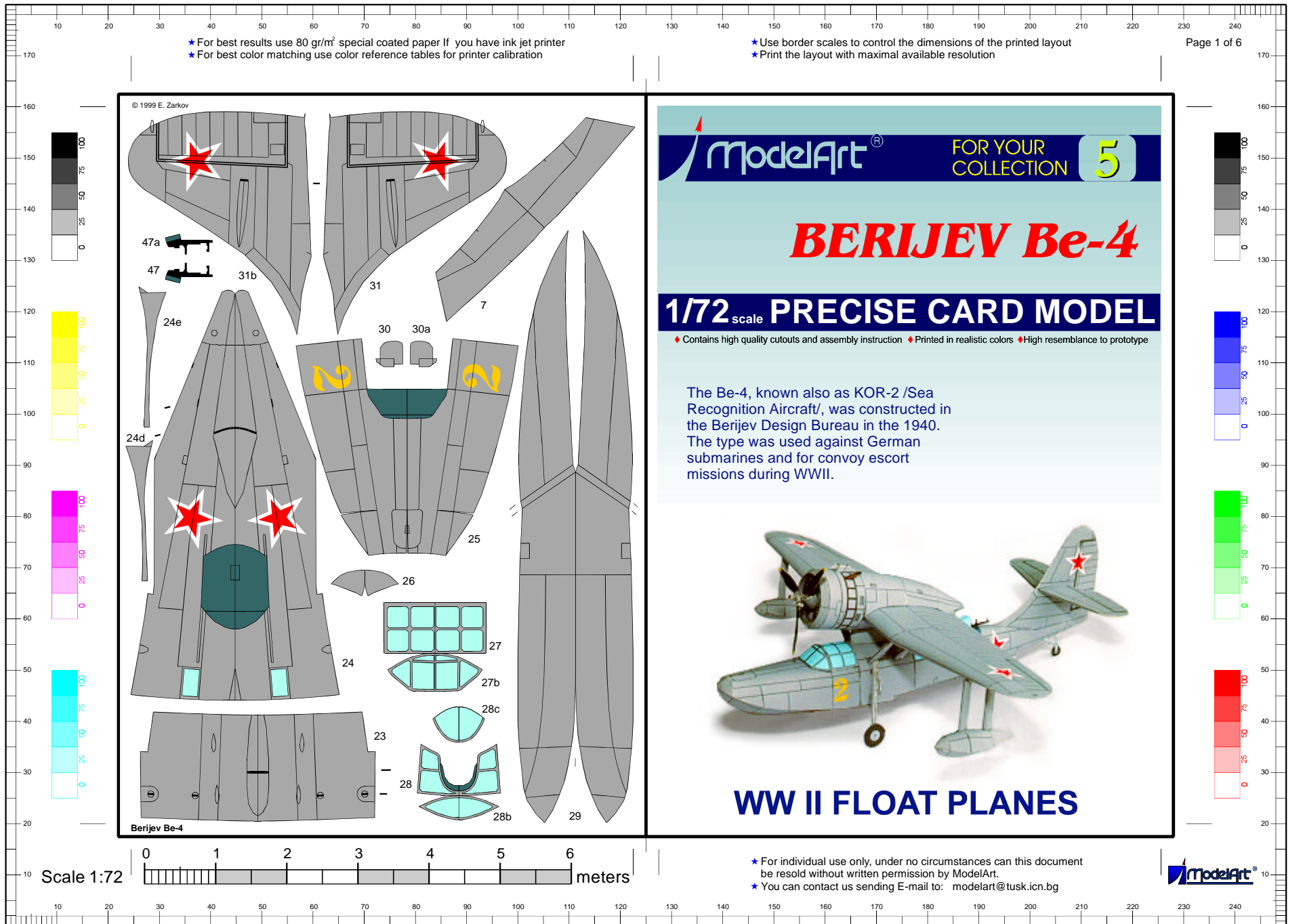
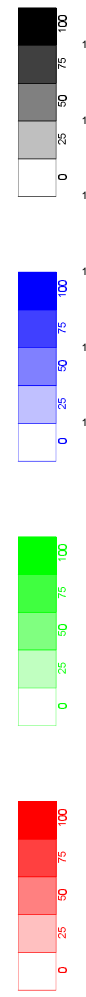

★ For best results use 80 gr/m² special coated paper If you have ink jet printer
★ For best color matching use color reference tables for printer calibration

★ Use border scales to control the dimensions of the printed layout
★ Print the layout with maximal available resolution

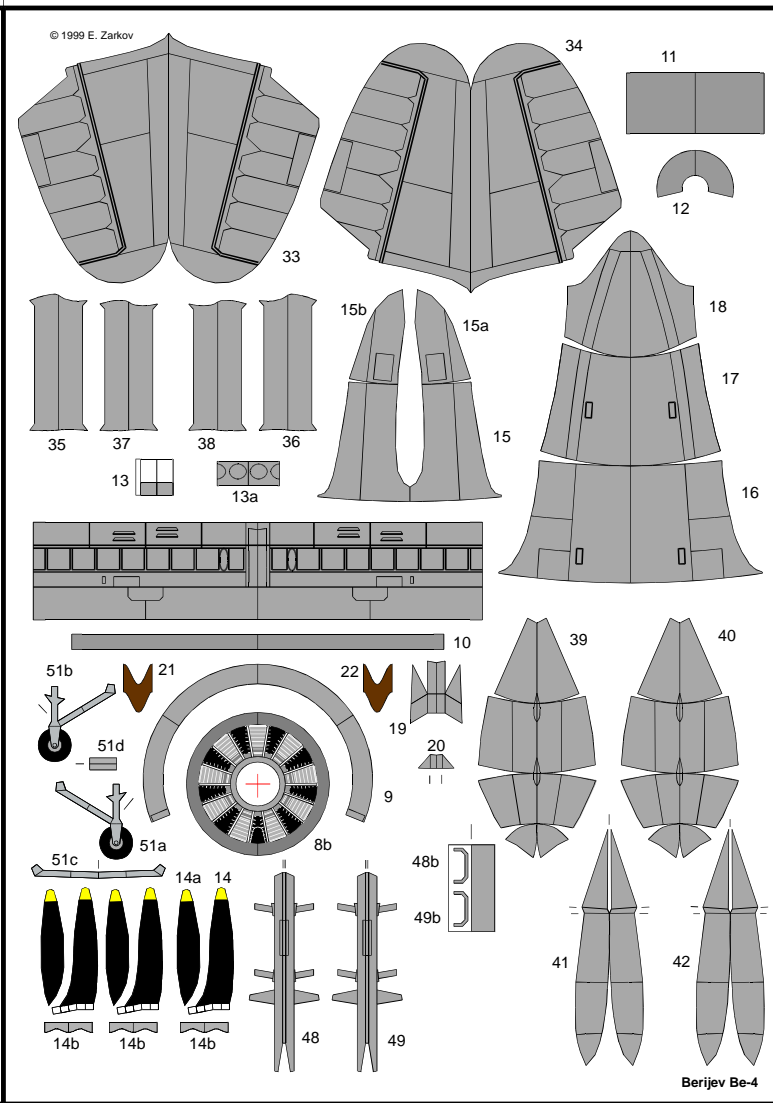
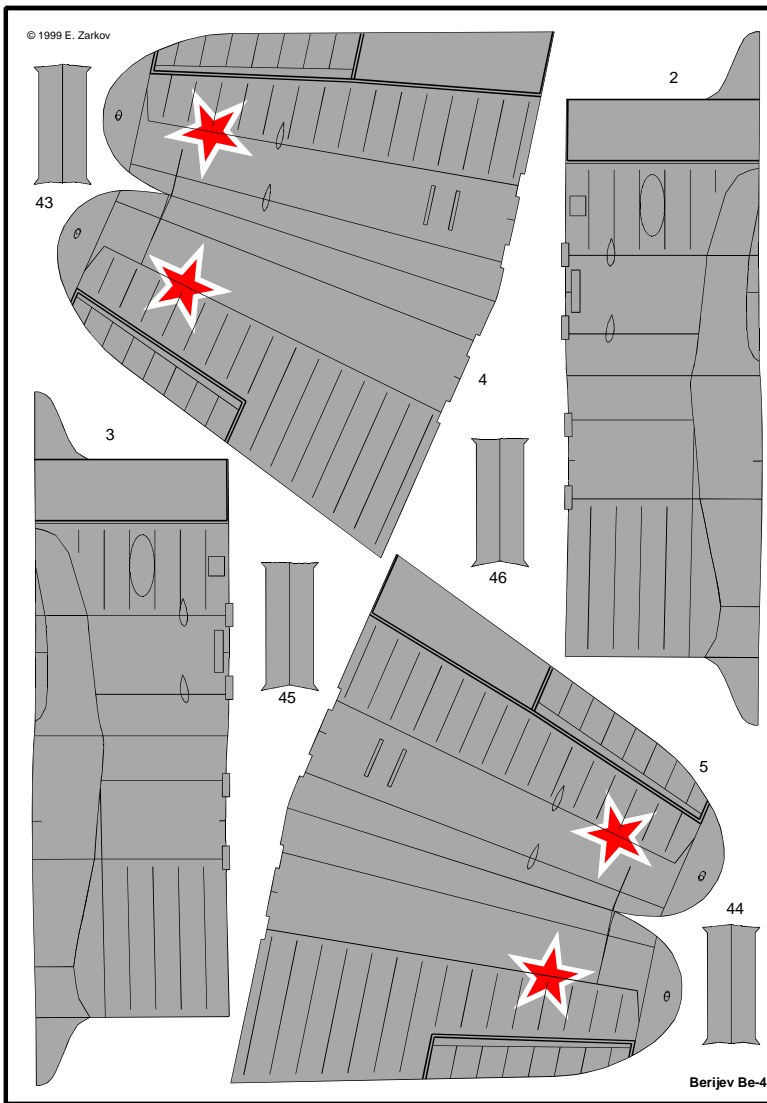

Scale 1:72

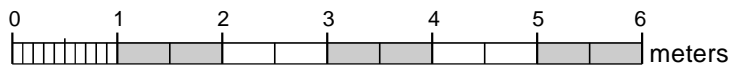

★ For individual use only, under no circumstances can this document be resold without written permission by ModelArt.
★ You can contact us sending E-mail to: modelart@tusk.icn.bg



★ For best results use 80 gr/m² special coated paper If you have ink jet printer
★ For best color matching use color reference tables for printer calibration

★ Use border scales to control the dimensions of the printed layout
★ Print the layout with maximal available resolution

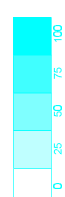
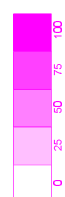
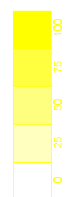
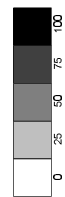
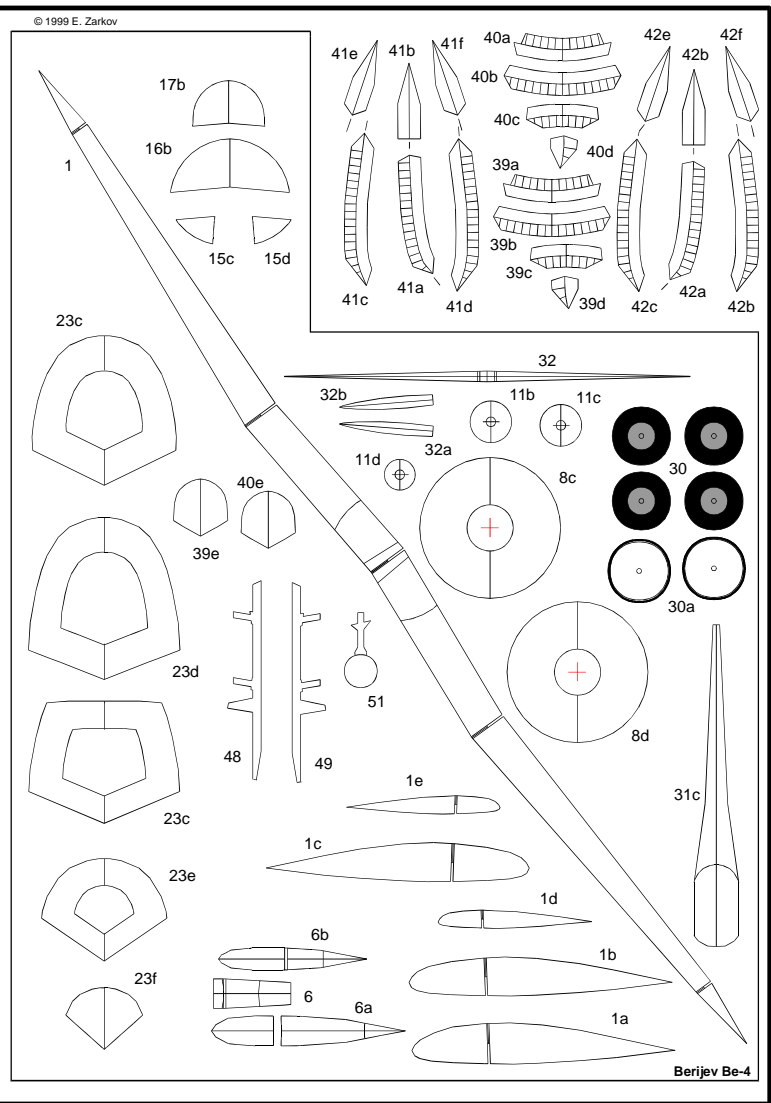
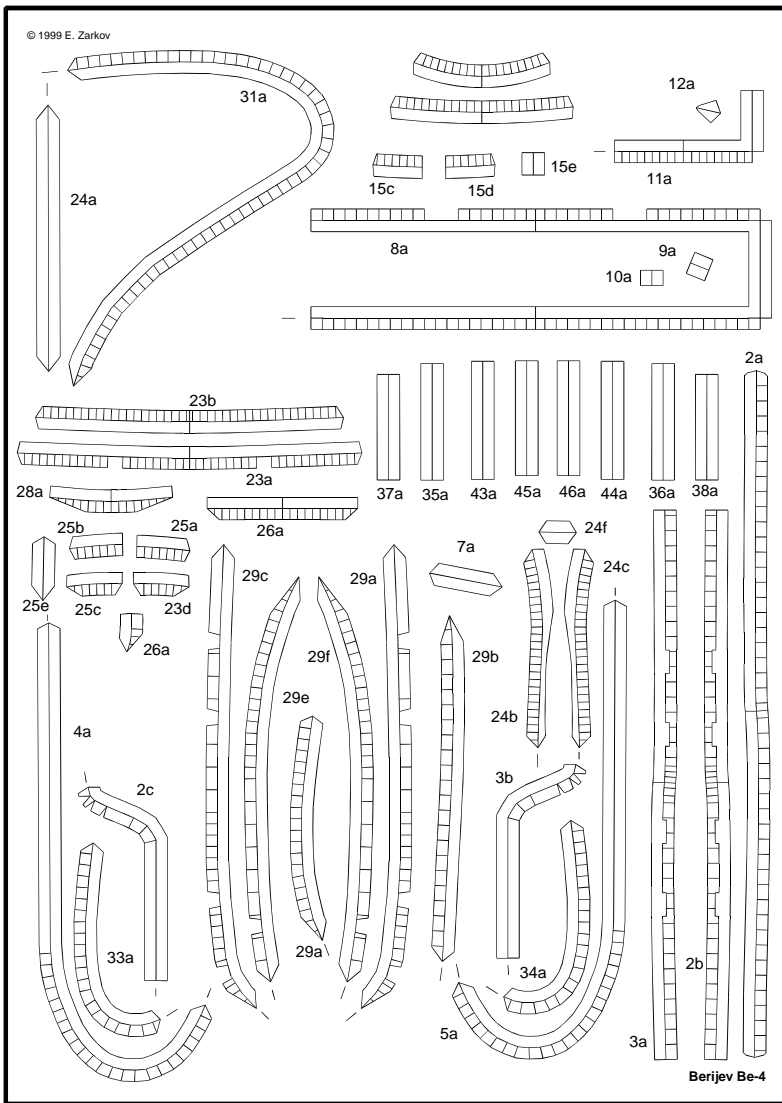

Scale 1:72



★ For individual use only, under no circumstances can this document be resold without written permission by ModelArt.
★ You can contact us sending E-mail to: modelart@tusk.icn.bg



© 1999 E. Zarkov

ASSEMBLY INSTRUCTION

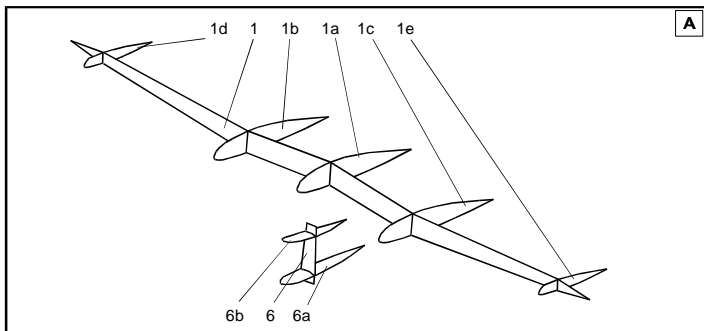

A

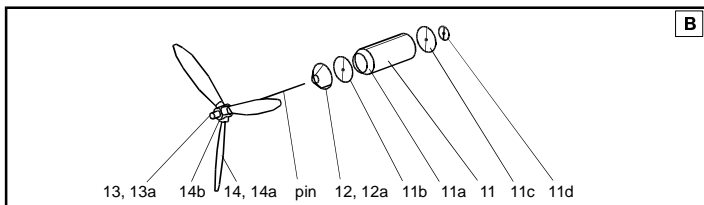

B

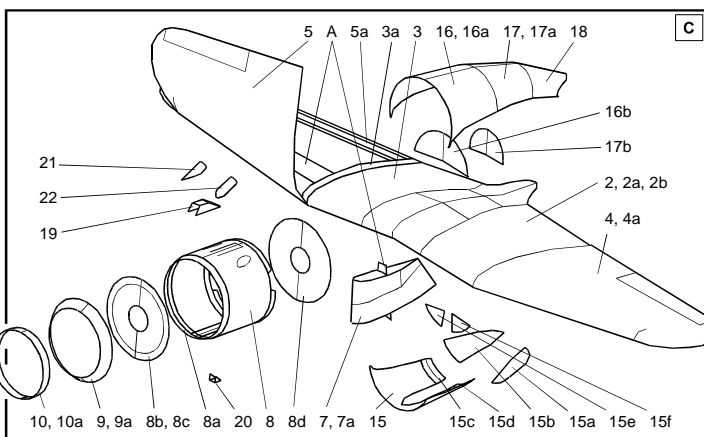

C

Berijev Be-4

© 1999 E. Zarkov

ASSEMBLY INSTRUCTION

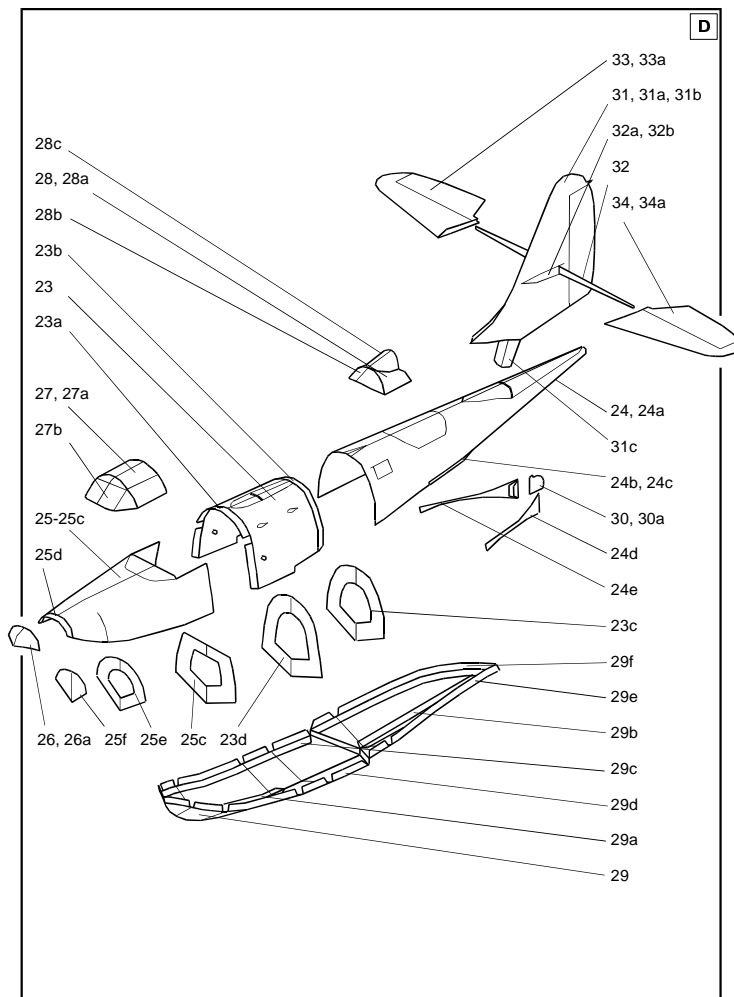

D

Berijev Be-4

© 1999 E. Zarkov

ASSEMBLY INSTRUCTION

E

40 - 40e 44, 44a 46, 46a
37, 37a
35, 35a
47, 47a
36, 36a
38, 38a
43, 43a
45, 45a
39 - 39d
39e
41 - 41e

C D

Berijev Be-4

© 1999 E. Zarkov

ASSEMBLY INSTRUCTION

F

E 50, 50a 48 - 48b 48c 50, 50a 49 - 49b 49c 51 - 51d

Berijev Be-4

© 1999 E. Zarkov

ASSEMBLY INSTRUCTION

Study the drawings of assembly steps carefully before starting the work on the model. Make sure you understand the purpose and place of every part.

The assembly requires some basic tools, such as scissors, sharp modeling knife, blunt knife for scoring the fold lines, ruler and needle. Additional materials you need are one pin to make the propeller's shaft and one piece of cardboard approx. 0.3 mm thick for reinforcing elements and wheels. You'll need of course suitable cement too. For cement application you can use toothpicks or some similar tool (special fine cement applicator is most suitable if you have one).

First of all you must score with the blunt knife all fold lines shown on the cutouts with short thin line marks near the parts. To avoid mistakes and lost parts cut the necessary details shortly before their use. The places where an additional cutting is needed are marked with small thick line marks.

Start with the wings' framework 1 and 6 as shown on the view A of the assembling instruction. Cover it with the wing segments 2 - 5, using corresponding connecting stripes. Keep character revers gull shape of the wing and do not allow twisting. In the same way assembly the console 7 and glue it to the wing.

Assembly the engine cowling /parts 8 - 10 and 15 - 18/. Carefully cut the holes in the crosssections where the propeller shaft's bearing 11 will be inserted.

Assembly the propeller 11 - 14, using pin as a shaft as shown on view C. Propeller should be capable to rotate freely in its bearing.

Live the wing propeller assemblage apart and continue with the fuselage. Build its upper part 23 - 26 first, glueing its segments using connecting stripes in order of their enumeration. Use crosssections to obtain exact fuselage shape. Prepare the bottom part of the fuselage 29 and after some dry tests glue it to the upper side. Glue the front and rear cockpits 27 - 28 and the vertical stabilizer 31 on their places.

Now glue the wing assemblage to the fuselage, using supports 35 - 38. Keep front and upper view symmetry.

Beriev Be-4

Assembly the floats 39 - 42 in the same manner as the fuselage and glue them to the wings, using the supports 43 - 46.

Prepare the horizontal stabilizer parts 32 - 34 and glue them to the vertical stabilizer, inserting in it longerone 32.

Place the mashine gun 47 in the rear cockpit and glue the propeller assemblage in the engine.

If your model will represent the airplane on the ground, assembly the removable transportation gear 48 - 51.

If you prefer flying model, you must add some weight in the nose for appropriate balance. In this case you can omit propeller's blades.

Now your model is ready. Enjoy your Beriev Be-4.



Beriev Be-4